

# DRAFT: FOR DISCUSSION PURPOSES ONLY

IMPORTANT NOTE: ACREAGE VALUES AND OWNERSHIP HEREIN ARE DERIVED FROM HISTORICAL AND CURRENT RECORDS LOCATED AT THE DANE COUNTY DEPARTMENT OF PLANNING AND DEVELOPMENT (EG. GIS, PLAT BOOKS, ZONING PERMIT DATA, CSM'S, ETC). DENSITY POLICIES VARY AMONG TOWNS AND MAY REQUIRE INTERPRETATION.

**Applicant:** Mary Jo Bell

<b>Town</b>	Dane	<b>A-1EX Adoption</b>	6/28/1979	<b>Orig Farm Owner</b>	Joesph Goeden
<b>Section:</b>	26	<b>Density Number</b>	35	<b>Original Farm Acres</b>	111.58
<b>Density Study Date</b>	3/12/2024	<b>Original Splits</b>	3.19	<b>Available Density Unit(s)</b>	1

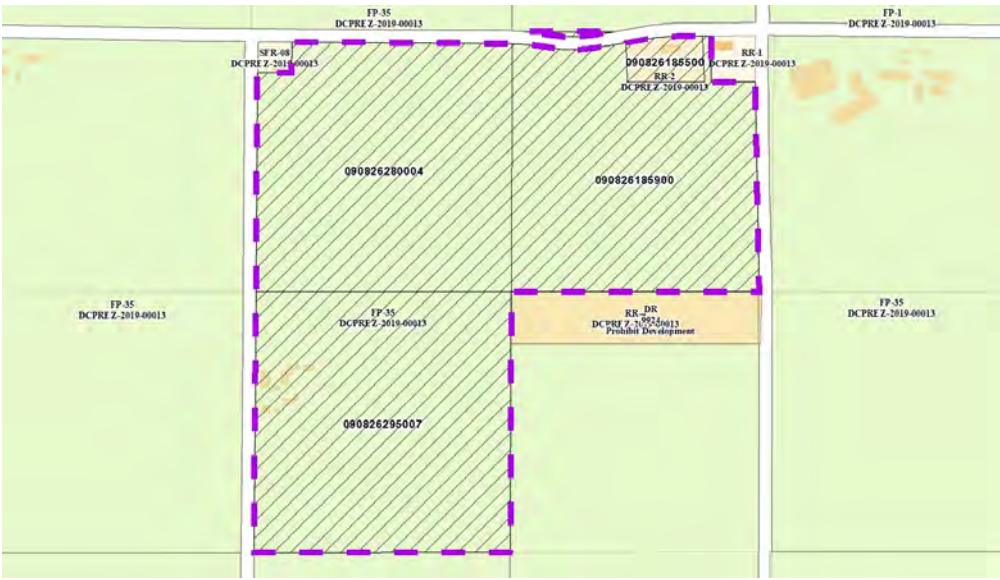

## Reasons/Notes:

[3] Original Splits  
[-1] RR-2  
[-1] Original Farm Home  
[1] Split Remains

Note: Parcels included in the density study reflect farm ownership and acreage as of the date of town plan adoption, or other date specified. Density study is based on the original farm acreage, NOT acreage currently owned.

Parcel #	Acres	Owner Name	CSM
090826295007	39.4	DONALD N GOEDEN	
090826280004	36.95	DONALD N GOEDEN	
090826185900	33.23	DONALD N GOEDEN	
090826185500	2.01	MARTIN J MULCAHY & JANE M MULCAHY	10260