

DRAFT: FOR DISCUSSION PURPOSES ONLY

IMPORTANT NOTE: ACREAGE VALUES AND OWNERSHIP HEREIN ARE DERIVED FROM HISTORICAL AND CURRENT RECORDS LOCATED AT THE DANE COUNTY DEPARTMENT OF PLANNING AND DEVELOPMENT (EG. GIS, PLAT BOOKS, ZONING PERMIT DATA, CSM'S, ETC). DENSITY POLICIES VARY AMONG TOWNS AND MAY REQUIRE INTERPRETATION.

Applicant: Judy Cox

Town	Albion	A-1EX Adoption	6/29/1979	Orig Farm Owner	Marvin Meister
Section:	32	Density Number	35	Original Farm Acres	5.85
Density Study Date	5/14/2018	Original Splits	0.17	Available Density Unit(s)	0

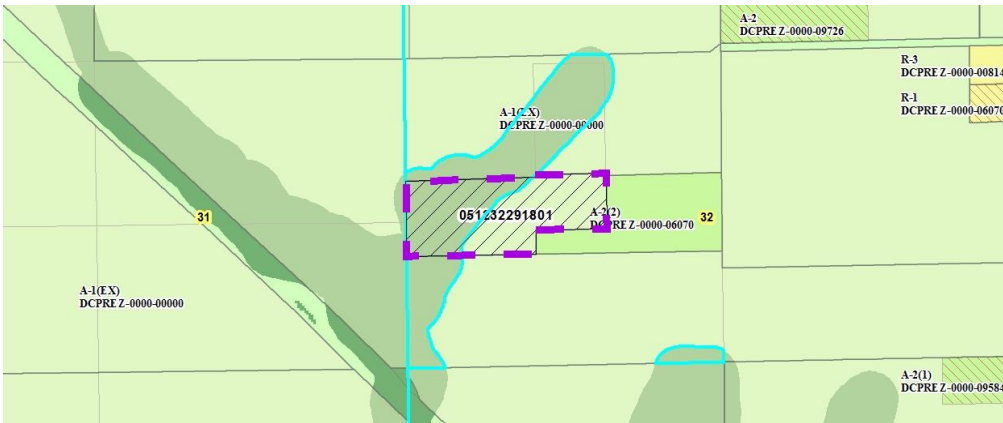

Reasons/Notes:

In 1979, this parcel was a single, legally created 5.85-acre parcel. The town plan allows such parcels to be used as a building site, and rezoned to allow up to one home per parcel, but may not be redivided to create more than one building site.

Note: Parcels included in the density study reflect farm ownership and acreage as of the date of town plan adoption, or other date specified. Density study is based on the original farm acreage, NOT acreage currently owned.

Parcel #	Acres	Owner Name	CSM
051232291801	5.85	ROBERT L COOK & JANE M COOK	