

FARMLAND PRESERVATION DENSITY STUDY

Density policies vary by town. Farmstead ownership is based on the enactment date of farmland preservation zoning. This report is based on the best property information available to staff. Please contact staff with questions at (608) 266-4266, and learn more . Learn about density studies at <https://danecountyplanning.com/Permits-Applications/Density-Study>

Applicant: Jennifer Delorme

Public Hearing Date: 1/28/2025

Petition Number: 12134

Town: Montrose

Orig Farm Owner: Morrisk, Glenn Jr.

Density Study Date: 10/23/2024

Original Farm Acres: 281.78

Section: 29

Available Density Unit(s): 4

Adoption Date: 9/10/1978

Original Splits: 8.05

Density Number: 35

Accela Number: DCPDEN-2024-0036

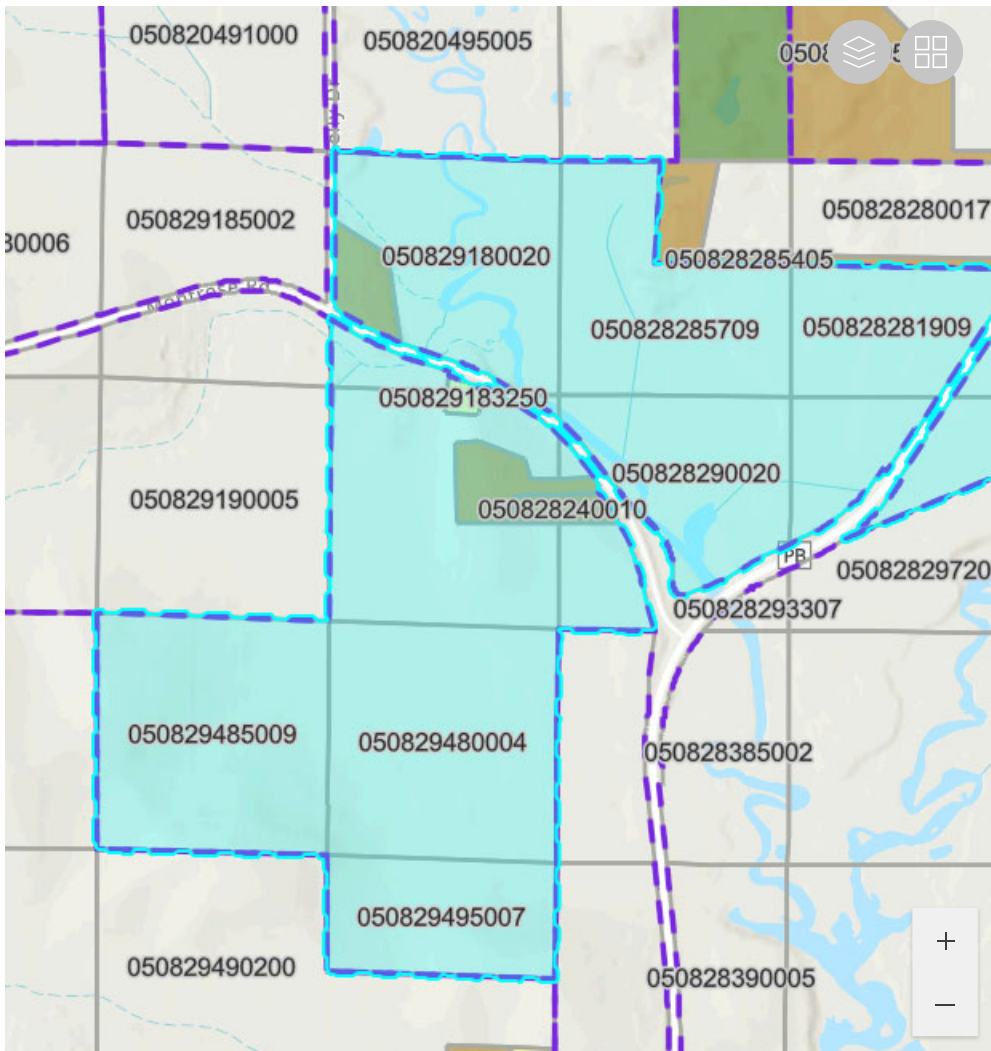

Reasons / Notes:

Homesites created to date: 4 per CSMs 11245, 14198, 14320 & 16577. New development should avoid resource protection corridors.

FARMLAND PRESERVATION DENSITY STUDY

Applicant: Jennifer Delorme

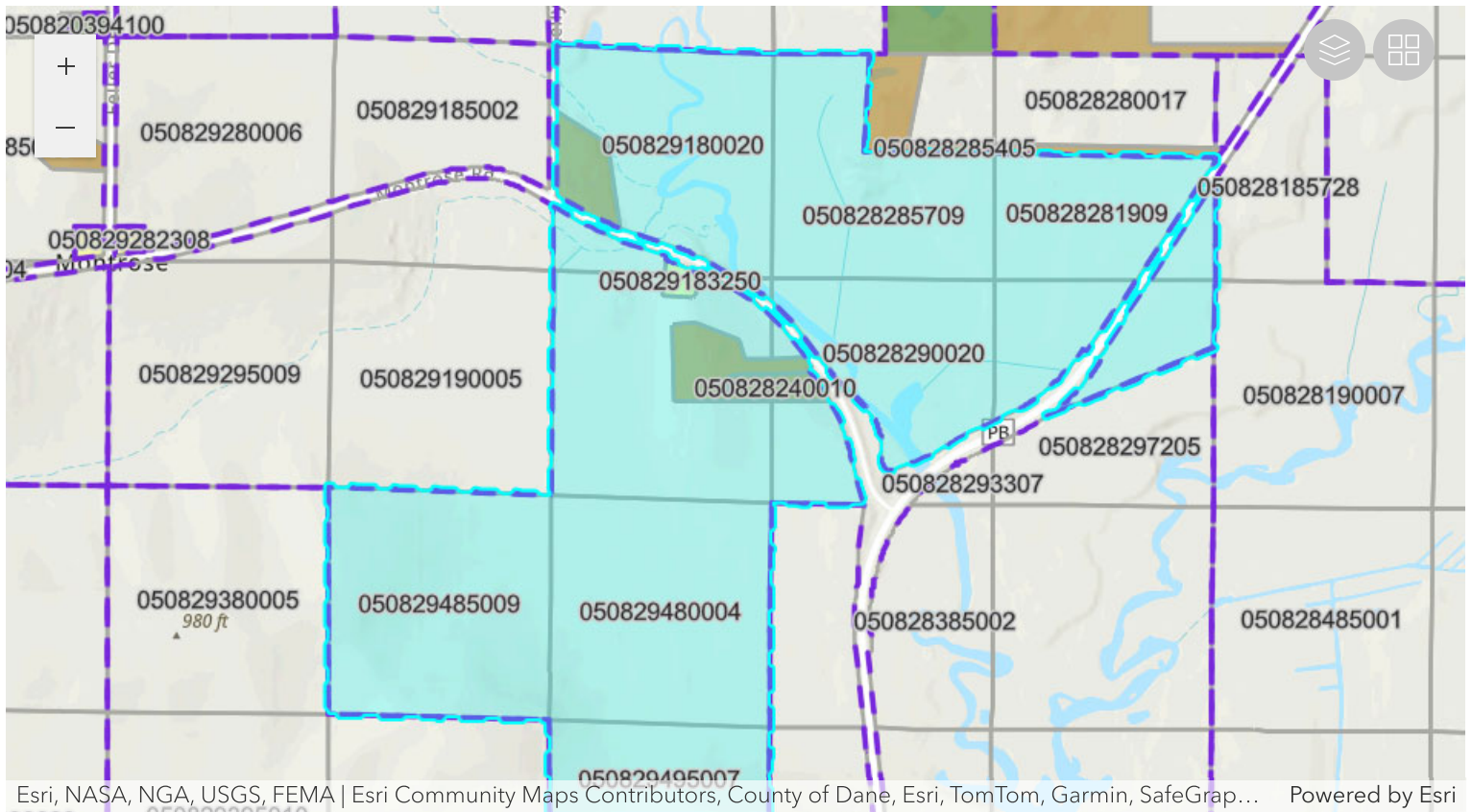

Parcel Number	Acres	Owner	CSM
050828240010	2.04	BART A MORRICK & ANGELA M MORRICK	16577
050828285709	30.65	MARY RAUTMANN & MARC MORRICK	
050829180020	34.22	MARY RAUTMANN & MARC MORRICK	
050829199550	4.66	BART A MORRICK & ANGELA M MORRICK	14198
050829485009	41.12	MARY RAUTMANN & MARC MORRICK	
050829495007	20	MARY RAUTMANN & MARC MORRICK	
050828281909	21.26	MARY RAUTMANN & MARC MORRICK	
050828290020	30.43	MARY RAUTMANN & MARC MORRICK	
050828295001	17.45	MARY RAUTMANN & MARC MORRICK	
050829181800	3.84	KEVIN DE LORME & JENNIFER S DE LORME	11245
050829183250	0.88	PAUL R KIENITZ & SUSAN LOCKERT-KIENITZ	14320
050829195030	34.56	MARY RAUTMANN & MARC MORRICK	
050829480004	40.68	MARY RAUTMANN & MARC MORRICK	