

DRAFT: FOR DISCUSSION PURPOSES ONLY

IMPORTANT NOTE: ACREAGE VALUES AND OWNERSHIP HEREIN ARE DERIVED FROM HISTORICAL AND CURRENT RECORDS LOCATED AT THE DANE COUNTY DEPARTMENT OF PLANNING AND DEVELOPMENT (EG. GIS, PLAT BOOKS, ZONING PERMIT DATA, CSM'S, ETC). DENSITY POLICIES VARY AMONG TOWNS AND MAY REQUIRE INTERPRETATION.

Public Hearing Date	3/22/2016	Petition Number	10949	Applicant:	Thomas Buchanan
Town	Medina	A-1EX Adoption	10/2/1980	Orig Farm Owner	Thomas Buchanan
Section:	11	Density Number	35	Original Farm Acres	60.13
Density Study Date	3/22/2016	Original Splits	1.72	Available Density Unit(s)	0

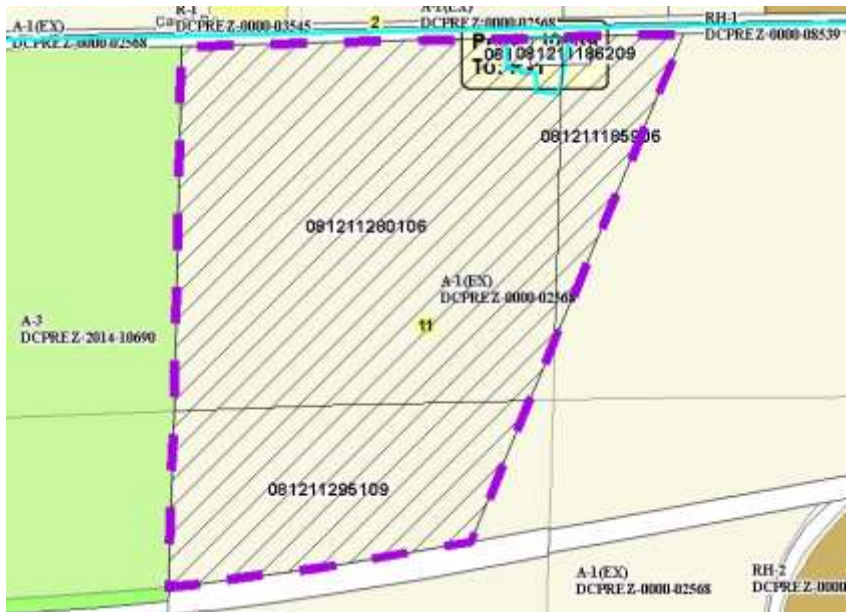

Reasons/Notes:
 It appears the property is not eligible for additional development under the town of Medina's density policy. Note that the town counts all residences toward the density limit. Separation of the existing residence is consistent with town plan policies.

Note: Parcels included in the density study reflect farm ownership and acreage as of the date of town plan adoption, or other date specified. Density study is based on the original farm acreage, NOT acreage currently owned.

Parcel #	Acres	Owner Name	CSM
081211295109	15.06	THOMAS R BUCHANAN	
081211280106	39.5	THOMAS R BUCHANAN	
081211280008	0.26	THOMAS R BUCHANAN	
081211186209	0.23	THOMAS R BUCHANAN	
081211185906	5.09	THOMAS R BUCHANAN	