

SECOND ADDITION TO STONER PRAIRIE

OUTLOT 6 AND 7 OF FIRST ADDITION TO STONER PRAIRIE RECORDED ON SEPTEMBER 13, 2018 IN VOLUME 60-099B OF PLATS ON PAGES 555-556 AS DOCUMENT NO. 5441003 BEING A PART OF THE NORTHWEST QUARTER OF THE SOUTHEAST QUARTER AND THE SOUTHWEST QUARTER OF THE SOUTHEAST QUARTER OF SECTION 8, TOWN 6 NORTH, RANGE 9 EAST, ALL IN THE CITY OF FITCHBURG, DANE COUNTY, WISCONSIN.

CERTIFICATE OF CITY TREASURER

STATE OF WISCONSIN)
DANE COUNTY) ss.

I, MISTY DODGE, BEING THE DULY ELECTED, QUALIFIED AND ACTING CITY TREASURER OF THE CITY OF FITCHBURG, DO HEREBY CERTIFY THAT IN ACCORDANCE WITH THE RECORDS IN MY OFFICE, THERE ARE NO UNPAID TAXES OR UNPAID SPECIAL ASSESSMENTS AS OF,

THIS _____ DAY OF _____, 20____, ON ANY OF THE LANDS INCLUDED IN THE PLAT OF SECOND ADDITION TO STONER PRAIRIE.

DATE _____ MISTY DODGE, CITY TREASURER

CERTIFICATE OF COUNTY TREASURER

STATE OF WISCONSIN)
DANE COUNTY) ss.

I, ADAM GALLAGHER, BEING THE DULY ELECTED, QUALIFIED AND ACTING COUNTY TREASURER OF DANE COUNTY, DO HEREBY CERTIFY THAT IN ACCORDANCE WITH THE RECORDS IN MY OFFICE, THERE ARE NO UNREDEEMED TAX SALES AND NO UNPAID TAXES OR SPECIAL ASSESSMENTS AS OF,

THIS _____ DAY OF _____, 20____, AFFECTING THE LANDS INCLUDED IN THE PLAT OF SECOND ADDITION TO STONER PRAIRIE.

DATE _____ ADAM GALLAGHER, COUNTY TREASURER

CERTIFICATE OF CITY CLERK

STATE OF WISCONSIN)
DANE COUNTY) ss.

"RESOLVED THAT THIS PLAT KNOWN AS SECOND ADDITION TO STONER PRAIRIE, LOCATED IN THE CITY OF FITCHBURG WAS HEREBY APPROVED BY RESOLUTION NO. _____, FILE NUMBER _____ ADOPTED ON THIS _____ DAY OF _____, 20____, AND FURTHER RESOLVED THAT THE CONDITIONS OF SAID APPROVAL WERE FULFILLED ON THIS _____ DAY OF _____, 20____, AND THAT SAID RESOLUTION FURTHER PROVIDED FOR THE ACCEPTANCE OF THOSE LANDS AND RIGHTS DEDICATED BY SAID STONER PRAIRIE FOR PUBLIC USE.

DATE _____ TRACY OLDENBURG, CITY CLERK

OWNER'S CERTIFICATE OF DEDICATION

HDP STONER PRAIRIE, LLC AS OWNER, WE HEREBY CERTIFY THAT WE CAUSED THE LAND DESCRIBED ON THIS PLAT TO BE SURVEYED, DIVIDED, MAPPED AND DEDICATED AS REPRESENTED ON THE PLAT. WE ALSO CERTIFY THAT THIS PLAT IS REQUIRED BY S.236.10 OR S.236.12 TO BE SUBMITTED TO THE FOLLOWING FOR APPROVAL OR OBJECTION:

DEPARTMENT OF ADMINISTRATION
COMMON COUNCIL, CITY OF FITCHBURG
DANE COUNTY ZONING AND NATURAL RESOURCES COMMITTEE

WITNESS THE HAND AND SEAL OF SAID OWNER THIS _____ DAY OF _____, 20____, IN PRESENCE OF:

HDP STONER PRAIRIE LLC
BY: MANAGING MEMBER

STATE OF _____)
_____ COUNTY) ss.

PERSONALLY CAME BEFORE ME THIS _____ DAY OF _____, 20____,

THE ABOVE NAMED _____ MANAGING MEMBER TO ME KNOWN TO BE THE SAME PERSON WHO EXECUTED THE FOREGOING INSTRUMENT AND ACKNOWLEDGED THE SAME.

NOTARY PUBLIC, _____,
STATE OF _____
MY COMMISSION EXPIRES _____.

OWNER'S CERTIFICATE OF DEDICATION

O'BRIEN FAMILY LIMITED PARTNERSHIP AS OWNER, WE HEREBY CERTIFY THAT WE CAUSED THE LAND DESCRIBED ON THIS PLAT TO BE SURVEYED, DIVIDED, MAPPED AND DEDICATED AS REPRESENTED ON THE PLAT. WE ALSO CERTIFY THAT THIS PLAT IS REQUIRED BY S.236.10 OR S.236.12 TO BE SUBMITTED TO THE FOLLOWING FOR APPROVAL OR OBJECTION:

DEPARTMENT OF ADMINISTRATION
COMMON COUNCIL, CITY OF FITCHBURG
DANE COUNTY ZONING AND NATURAL RESOURCES COMMITTEE

WITNESS THE HAND AND SEAL OF SAID OWNER THIS _____ DAY OF _____, 20____, IN PRESENCE OF:

O'BRIEN FAMILY LIMITED PARTNERSHIP
BY: MANAGING MEMBER

STATE OF WISCONSIN)
_____ COUNTY) ss.

PERSONALLY CAME BEFORE ME THIS _____ DAY OF _____, 20____,

THE ABOVE NAMED _____ MANAGING MEMBER TO ME KNOWN TO BE THE SAME PERSON WHO EXECUTED THE FOREGOING INSTRUMENT AND ACKNOWLEDGED THE SAME.

NOTARY PUBLIC, _____,
WISCONSIN
MY COMMISSION EXPIRES _____.

PARCEL SETBACKS FOR R-L ZONING

PER CURRENT ZONING STANDARDS. SEE CITY OF FITCHBURG - CODE OF ORDINANCES CHAPTER 22 - ZONING FOR FURTHER DETAILS, MAY BE SUBJECT TO CHANGES NOT TO SCALE

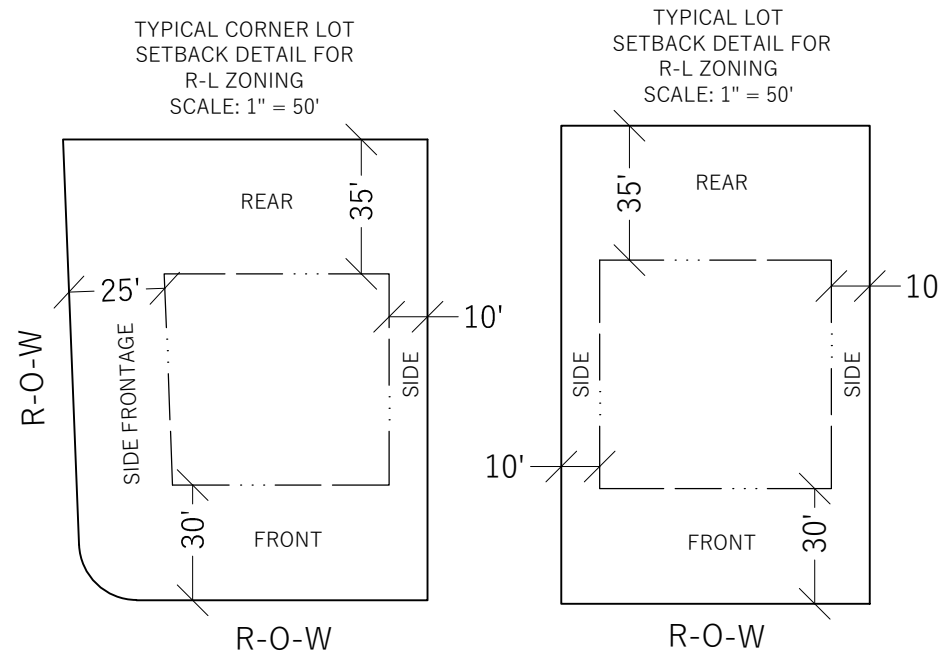

SURVEYOR'S CERTIFICATE

I, JULIUS W. SMITH, PROFESSIONAL LAND SURVEYOR, HEREBY CERTIFY THAT IN FULL COMPLIANCE WITH THE PROVISIONS OF CHAPTER 236 OF THE WISCONSIN STATUTES, AND PROVISIONS AS STATED IN CHAPTER 24 - LAND DIVISION OF THE CITY OF FITCHBURG - CODE OF ORDINANCES AND UNDER THE DIRECTION OF WILLIAM RYAN HOMES WISCONSIN, INC., I HAVE SURVEYED, DIVIDED AND MAPPED SECOND ADDITION TO STONER PRAIRIE; THAT SUCH PLAT CORRECTLY REPRESENTS ALL EXTERIOR BOUNDARIES AND THE SUBDIVISION OF THE LAND SURVEYED; AND THAT THIS LAND IS LOCATED IN THE NW-1/4 OF THE SE-1/4 AND SW-1/4 OF THE SE-1/4 OF SECTION 8, T8N, R9E, CITY OF FITCHBURG, DANE COUNTY, WISCONSIN, CONTAINING 36.21 ACRES OF LAND AND DESCRIBED AS FOLLOWS:

OUTLOTS 6 AND 7 OF FIRST ADDITION TO STONER PRAIRIE RECORDED ON SEPTEMBER 13, 2018 IN VOLUME 60-099B OF PLATS ON PAGES 555-556 AS DOCUMENT NO. 5441003 BEING A PART OF THE NORTHWEST QUARTER OF THE SOUTHEAST QUARTER AND THE SOUTHWEST QUARTER OF THE SOUTHEAST QUARTER OF SECTION 8, TOWN 6 NORTH, RANGE 9 EAST, ALL IN THE CITY OF FITCHBURG, DANE COUNTY, WISCONSIN.

SAID PARCEL CONTAINS 795,908 SQUARE FEET OR 18.27 ACRES

DATED THIS 14TH DAY OF NOVEMBER, 2019.

JULIUS W. SMITH, S-3091
WISCONSIN PROFESSIONAL LAND SURVEYOR

REVISED THIS XXTH DAY OF XXXXXX, 2019.

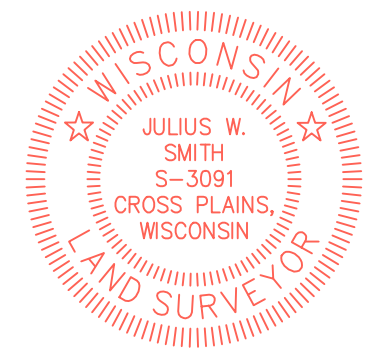

PREPARED FOR:
WILLIAM RYAN HOMES WISCONSIN, INC.
5989 MONONA DRIVE
MONONA, WI 53716



SURVEYED BY:
WYSER ENGINEERING
312 EAST MAIN STREET
MOUNT HOREB, WI 53572
www.wyserengineering.com

There are no objections to this plat with respect to Secs. 236.15, 236.16, 236.20 and 236.21(1) and (2), Wis. Stats. as provided by s. 236.12, Wis. Stats.
Certified _____, 20____
Department of Administration



OFFICE OF THE REGISTER OF DEEDS
_____, COUNTY, WISCONSIN
RECEIVED FOR RECORD _____
20__ AT _____ O'CLOCK ____ M AS
DOCUMENT # _____
IN VOL. _____ OF PLATS,
ON PAGE(S) _____
REGISTER OF DEEDS