

DRAFT: FOR DISCUSSION PURPOSES ONLY

IMPORTANT NOTE: ACREAGE VALUES AND OWNERSHIP HEREIN ARE DERIVED FROM HISTORICAL AND CURRENT RECORDS LOCATED AT THE DANE COUNTY DEPARTMENT OF PLANNING AND DEVELOPMENT (EG. GIS, PLAT BOOKS, ZONING PERMIT DATA, CSM'S, ETC). DENSITY POLICIES VARY AMONG TOWNS AND MAY REQUIRE INTERPRETATION.

Public Hearing Date	4/30/2019	Petition Number	11410	Applicant:	Zach Dahl
Town	Roxbury	A-1EX Adoption	7/26/1978	Orig Farm Owner	Marcus Marx
Section:	09	Density Number	35	Original Farm Acres	156.28
Density Study Date	4/30/2019	Original Splits	4.47	Available Density Unit(s)	1

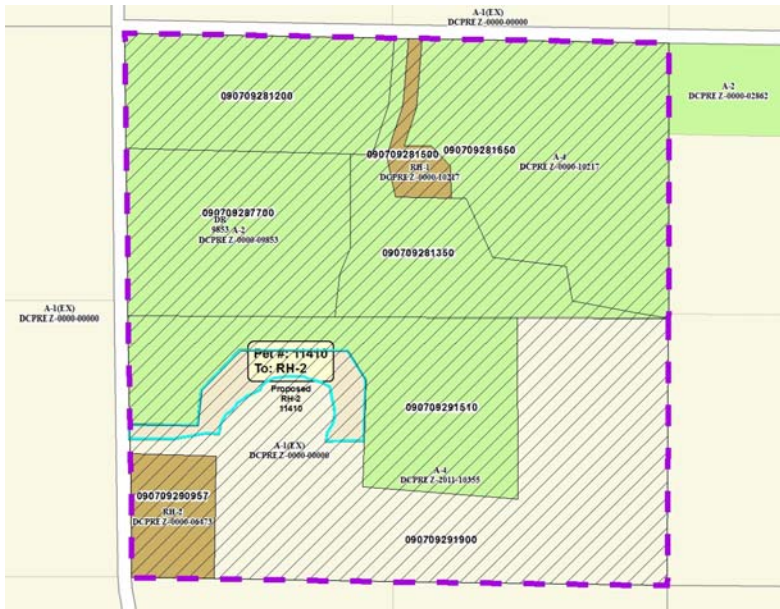

Reasons/Notes:

- [4] Original Housing Density Rights
- [-1] Rezone 10217
- [-1] Rezone 6473
- [-1] Rezone 9853

- [1] Housing Density Right Remains

Note: Parcels included in the density study reflect farm ownership and acreage as of the date of town plan adoption, or other date specified. Density study is based on the original farm acreage, NOT acreage currently owned.

Parcel #	Acres	Owner Name	CSM
090709281500	2.35	CLINTON C PHILLIPS & LAUREN PHILLIPS	13033
090709281350	13.54	CLINTON C PHILLIPS & LAUREN PHILLIPS	13033
090709291900	48.09	DAHL HOMESTEAD LLC	
090709290957	5.52	DAHL HOMESTEAD LLC	08125
090709287700	19.31	JOSEPH S MARX & MICHELLE R MARX	12504
090709291510	22.02	MITCHELL J REIBLE & MARK A REIBLE	13243
090709281650	29.27	MITCHELL J REIBLE & MARK A REIBLE	13033
090709281200	16.19	MITCHELL J REIBLE & MARK A REIBLE	13033