

# DRAFT: FOR DISCUSSION PURPOSES ONLY

IMPORTANT NOTE: ACREAGE VALUES AND OWNERSHIP HEREIN ARE DERIVED FROM HISTORICAL AND CURRENT RECORDS LOCATED AT THE DANE COUNTY DEPARTMENT OF PLANNING AND DEVELOPMENT (EG. GIS, PLAT BOOKS, ZONING PERMIT DATA, CSM'S, ETC). DENSITY POLICIES VARY AMONG TOWNS AND MAY REQUIRE INTERPRETATION.

**Applicant:** Tami and Tracy Bahr

<b>Town</b>	Oregon	<b>A-1EX Adoption</b>	1/5/1995	<b>Orig Farm Owner</b>	G. Walter Feller
<b>Section:</b>	17	<b>Density Number</b>	35	<b>Original Farm Acres</b>	31.73
<b>Density Study Date</b>	7/11/2018	<b>Original Splits</b>	0.91	<b>Available Density Unit(s)</b>	0

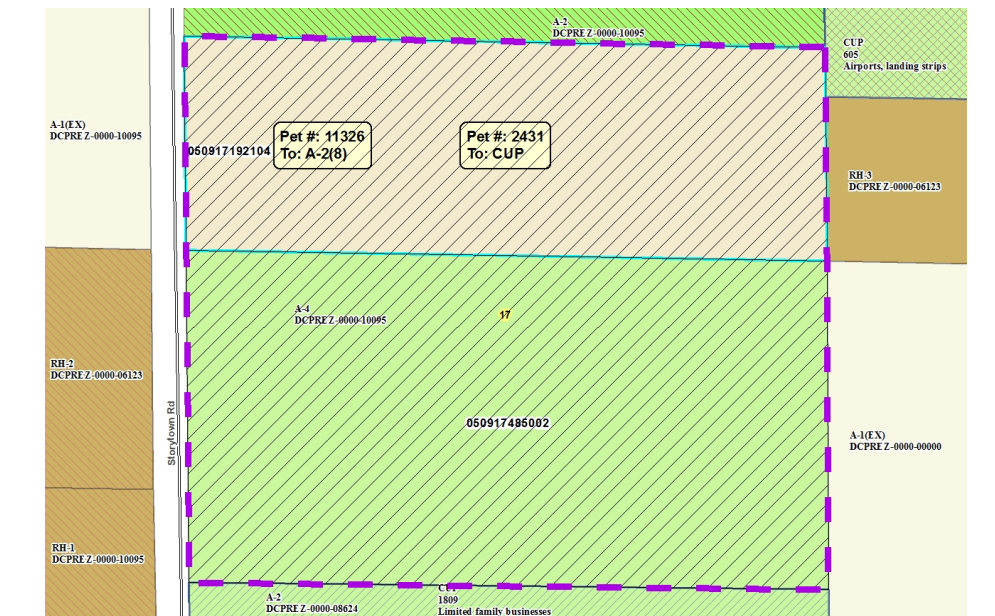

**Reasons/Notes:**

Property was originally a 64-acre farm, including approximately 32 acres in a Rural Development area and 32 acres in Rural Preservation. Town plan standards would allow such parcels one building site.

Note: Parcels included in the density study reflect farm ownership and acreage as of the date of town plan adoption, or other date specified. Density study is based on the original farm acreage, NOT acreage currently owned.

Parcel #	Acres	Owner Name	CSM
050917485002	19.25	STEVEN C ACE & SUSAN L ACE	
050917192104	12.48	STEVEN C ACE & SUSAN L ACE	