

# DRAFT: FOR DISCUSSION PURPOSES ONLY

IMPORTANT NOTE: ACREAGE VALUES AND OWNERSHIP HEREIN ARE DERIVED FROM HISTORICAL AND CURRENT RECORDS LOCATED AT THE DANE COUNTY DEPARTMENT OF PLANNING AND DEVELOPMENT (EG. GIS, PLAT BOOKS, ZONING PERMIT DATA, CSM'S, ETC). DENSITY POLICIES VARY AMONG TOWNS AND MAY REQUIRE INTERPRETATION.

**Applicant:** Steve Ace

<b>Town</b>	Oregon	<b>A-1EX Adoption</b>	1/5/1995	<b>Orig Farm Owner</b>	G. Walter Feller
<b>Section:</b>	17	<b>Density Number</b>	35	<b>Original Farm Acres</b>	57.89
<b>Density Study Date</b>	4/24/2018	<b>Original Splits</b>	1.65	<b>Available Density Unit(s)</b>	0

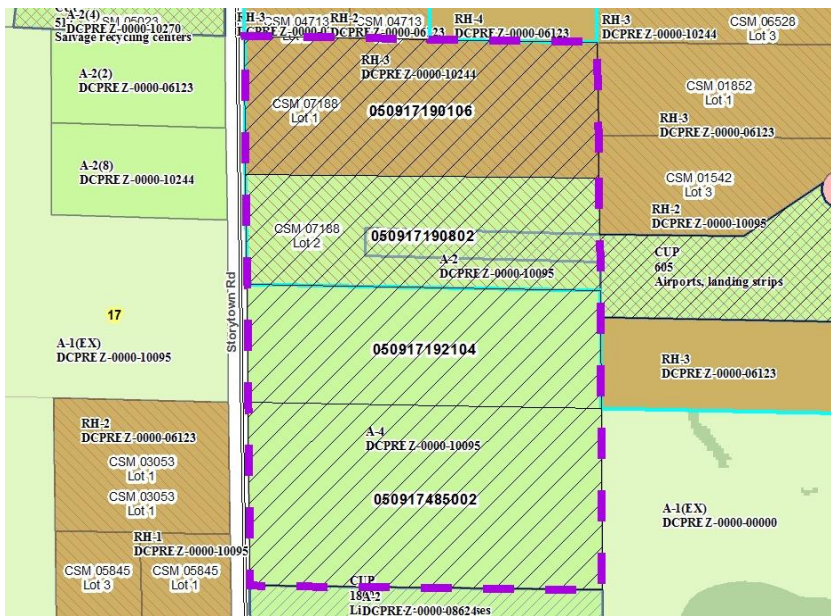

**Reasons/Notes:**

Homesites created to date: 2 per CSM 7188 Lots 1 and 2.

Note: Parcels included in the density study reflect farm ownership and acreage as of the date of town plan adoption, or other date specified. Density study is based on the original farm acreage, NOT acreage currently owned.

<u>Parcel #</u>	<u>Acres</u>	<u>Owner Name</u>	<u>CSM</u>
050917190106	14.47	GUY T JUDD & MELISSA A JUDD	07188
050917485002	19.25	STEVEN C ACE & SUSAN L ACE	
050917192104	12.48	STEVEN C ACE & SUSAN L ACE	
050917190802	18.51	WEIMAN LIVING TR, DAVID W R & PEGGY A	07188