

DRAFT: FOR DISCUSSION PURPOSES ONLY

IMPORTANT NOTE: ACREAGE VALUES AND OWNERSHIP HEREIN ARE DERIVED FROM HISTORICAL AND CURRENT RECORDS LOCATED AT THE DANE COUNTY DEPARTMENT OF PLANNING AND DEVELOPMENT (EG. GIS, PLAT BOOKS, ZONING PERMIT DATA, CSM'S, ETC). DENSITY POLICIES VARY AMONG TOWNS AND MAY REQUIRE INTERPRETATION.

Public Hearing Date	3/24/2020	Petition Number	11526	Applicant:	Jim Gavin
Town	Mazomanie	A-1EX Adoption	3/29/1979	Orig Farm Owner	Harris Brockman
Section:	11, 12	Density Number	40	Original Farm Acres	203.12
Density Study Date	5/24/2020	Original Splits	5.08	Available Density Unit(s)	1

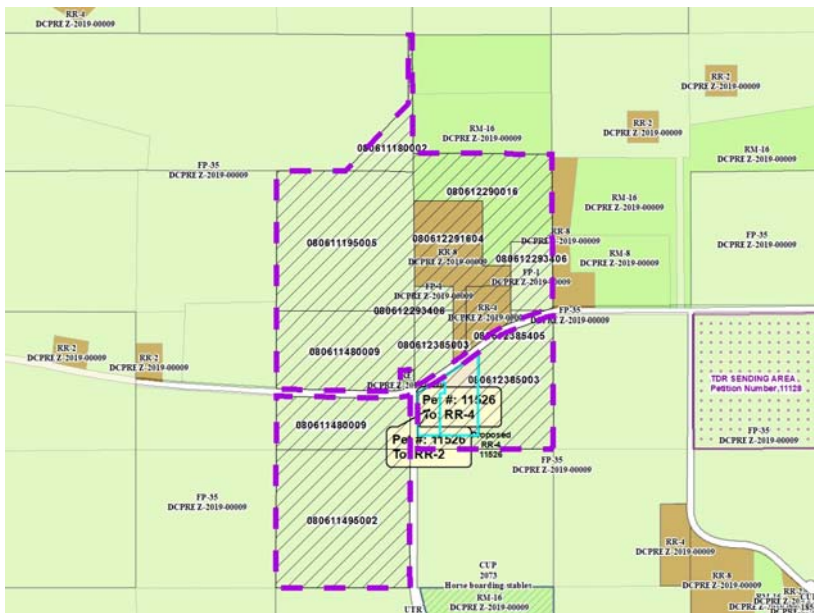

Reasons/Notes:

- [5] original housing density rights
- [-1] 080612385405
- [-1] 080612291604
- [-1] 080612290016
- [-1] 080612385003 has 2 homes but 1 pre 1979 home doesn't not count against the density policy.

- [1] housing density right remains

Note: Parcels included in the density study reflect farm ownership and acreage as of the date of town plan adoption, or other date specified. Density study is based on the original farm acreage, NOT acreage currently owned.

Parcel #	Acres	Owner Name	CSM
080612385003	33.61	BROCKMANN REV LIVING TR, CLEO I	
080612293406	7.85	BROCKMANN REV LIVING TR, CLEO I	
080611495002	38.63	BROCKMANN REV LIVING TR, CLEO I	
080611480009	36.74	BROCKMANN REV LIVING TR, CLEO I	
080611195005	39.89	BROCKMANN REV LIVING TR, CLEO I	
080611180002	5.56	BROCKMANN REV LIVING TR, CLEO I	
080612291604	15.31	CHARLES W STAMPFLI & JEANETTE K STAMPFLI	03384
080612290016	20.88	CHARLES W STAMPFLI & JEANETTE K STAMPFLI	
080612385405	4.64	DAVID GEORGE MUELLER & ELKE PATRICIA MUELLER	03384