

DRAFT: FOR DISCUSSION PURPOSES ONLY

IMPORTANT NOTE: ACREAGE VALUES AND OWNERSHIP HEREIN ARE DERIVED FROM HISTORICAL AND CURRENT RECORDS LOCATED AT THE DANE COUNTY DEPARTMENT OF PLANNING AND DEVELOPMENT (EG. GIS, PLAT BOOKS, ZONING PERMIT DATA, CSM'S, ETC). DENSITY POLICIES VARY AMONG TOWNS AND MAY REQUIRE INTERPRETATION.

Public Hearing Date	7/28/2015	Petition Number	10859	Applicant:	Charles Anderberg
Town	Deerfield	A-1EX Adoption	10/26/1978	Orig Farm Owner	Anderberg, Leona
Section:	32	Density Number	35	Original Farm Acres	155.06
Density Study Date	5/11/2010	Original Splits	4.43	Available Density Unit(s)	4

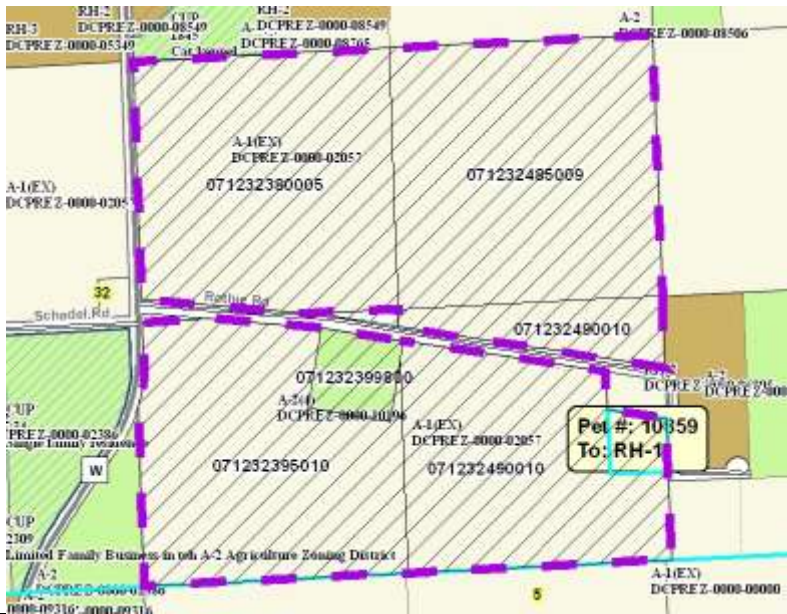

Reasons/Notes:

One prior split per CSM 12925. The Anderberg property remains eligible for three (3) possible splits. If the petition is approved, it appears two (2) possible splits will remain.

Note: Parcels included in the density study reflect farm ownership and acreage as of the date of town plan adoption, or other date specified. Density study is based on the original farm acreage, NOT acreage currently owned.

Parcel #	Acres	Owner Name	CSM
071232490010	37.47	CHARLES E ANDERBERG & HELENE E EMBERSON	
071232485009	40.52	CHARLES E ANDERBERG & HELENE E EMBERSON	
071232395010	35.46	CHARLES E ANDERBERG & HELENE E EMBERSON	
071232380005	38.26	CHARLES E ANDERBERG & HELENE E EMBERSON	
071232399800	3.96	DAVID A SIEBERT & CHRISTINA L SIEBERT	12925