

DRAFT: FOR DISCUSSION PURPOSES ONLY

IMPORTANT NOTE: ACREAGE VALUES AND OWNERSHIP HEREIN ARE DERIVED FROM HISTORICAL AND CURRENT RECORDS LOCATED AT THE DANE COUNTY DEPARTMENT OF PLANNING AND DEVELOPMENT (EG. GIS, PLAT BOOKS, ZONING PERMIT DATA, CSM'S, ETC). DENSITY POLICIES VARY AMONG TOWNS AND MAY REQUIRE INTERPRETATION.

Public Hearing Date	4/28/2015	Petition Number	10823	Applicant:	Mary S Thompson Rev Trust
Town	Blue Mounds	A-1EX Adoption	8/26/1980	Orig Farm Owner	Milford Thompson
Section:	10, 15	Density Number	35	Original Farm Acres	144.03
Density Study Date	3/25/2014	Original Splits	4.12	Available Density Unit(s)	2

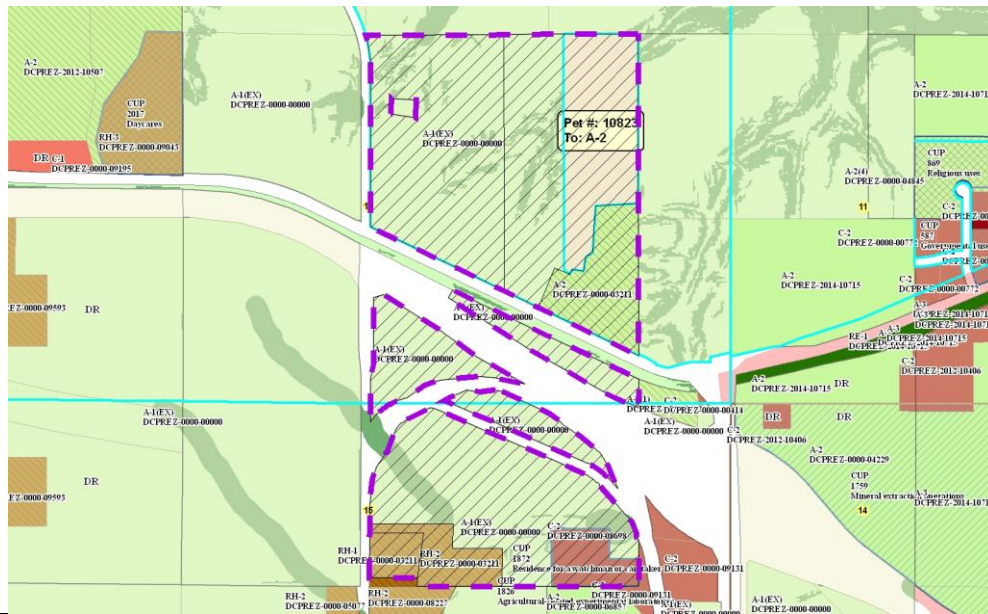

Reasons/Notes:

REVISED, Town plan includes land in ROW as part of original farm. 177.3 acres gross / 35 = 5.02 sites.
 Homesites to date: 3 per Petition 3211 / CSM 4443 & CSM 4444. NOTE: The town/county plan does not count commercial development against density cap.

Note: Parcels included in the density study reflect farm ownership and acreage as of the date of town plan adoption, or other date specified. Density study is based on the original farm acreage, NOT acreage currently owned.

Parcel #	Acres	Owner Name	CSM
060615187109	2.74	HARLAN OVERLAND & POLLY OVERLAND	04444
060615187001	5.29	HARLAN OVERLAND & POLLY OVERLAND	04444
060615180760	49.17	HLS LLC	
060610495704	10.65	RANDALL S THOMPSON & AMY THOMPSON	04443
060610497113	5.04	SHIRLEY THOMPSON	
060610485402	35.3	THOMPSON REV TR, MARY S	
060610480612	35.83	THOMPSON REV TR, MARY S	