

DRAFT: FOR DISCUSSION PURPOSES ONLY

IMPORTANT NOTE: ACREAGE VALUES AND OWNERSHIP HEREIN ARE DERIVED FROM HISTORICAL AND CURRENT RECORDS LOCATED AT THE DANE COUNTY DEPARTMENT OF PLANNING AND DEVELOPMENT (EG. GIS, PLAT BOOKS, ZONING PERMIT DATA, CSM'S, ETC). DENSITY POLICIES VARY AMONG TOWNS AND MAY REQUIRE INTERPRETATION.

Public Hearing Date	3/22/2022	Petition Number	11805	Applicant:	Marc Robertson
Town	Vermont	A-1EX Adoption	10/12/1979	Orig Farm Owner	Marc Robertson
Section:	23	Density Number	35	Original Farm Acres	39.36
Density Study Date	3/11/2022	Original Splits	1.12	Available Density Unit(s)	1

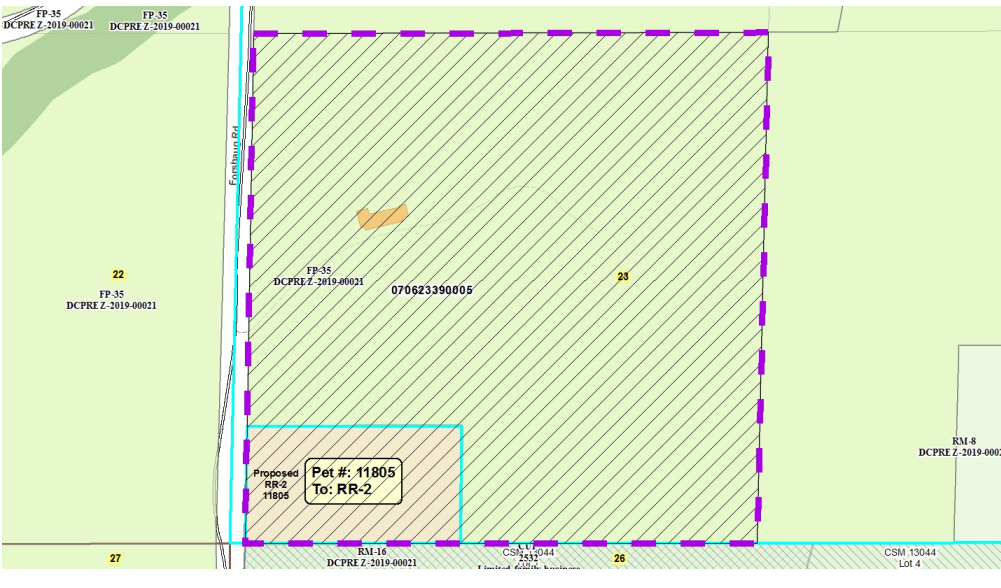

Reasons/Notes:

Homesites created to date:
NONE.
Note: Existing home on PIN 0706-233-9000-5 exempt from town density cap.

Note: Parcels included in the density study reflect farm ownership and acreage as of the date of town plan adoption, or other date specified. Density study is based on the original farm acreage, NOT acreage currently owned.

Parcel #	Acres	Owner Name	CSM
070623390005	39.36	MARC ROBERTSON	