

DRAFT: FOR DISCUSSION PURPOSES ONLY

IMPORTANT NOTE: ACREAGE VALUES AND OWNERSHIP HEREIN ARE DERIVED FROM HISTORICAL AND CURRENT RECORDS LOCATED AT THE DANE COUNTY DEPARTMENT OF PLANNING AND DEVELOPMENT (EG. GIS, PLAT BOOKS, ZONING PERMIT DATA, CSM'S, ETC). DENSITY POLICIES VARY AMONG TOWNS AND MAY REQUIRE INTERPRETATION.

Public Hearing Date	1/26/2021	Petition Number	11644	Applicant:	Roberts Trust
Town	Vermont	A-1EX Adoption	10/12/1979	Orig Farm Owner	James H and Pat Roberts
Section:	22	Density Number	35	Original Farm Acres	259.17
Density Study Date	1/10/2020	Original Splits	7.4	Available Density Unit(s)	4

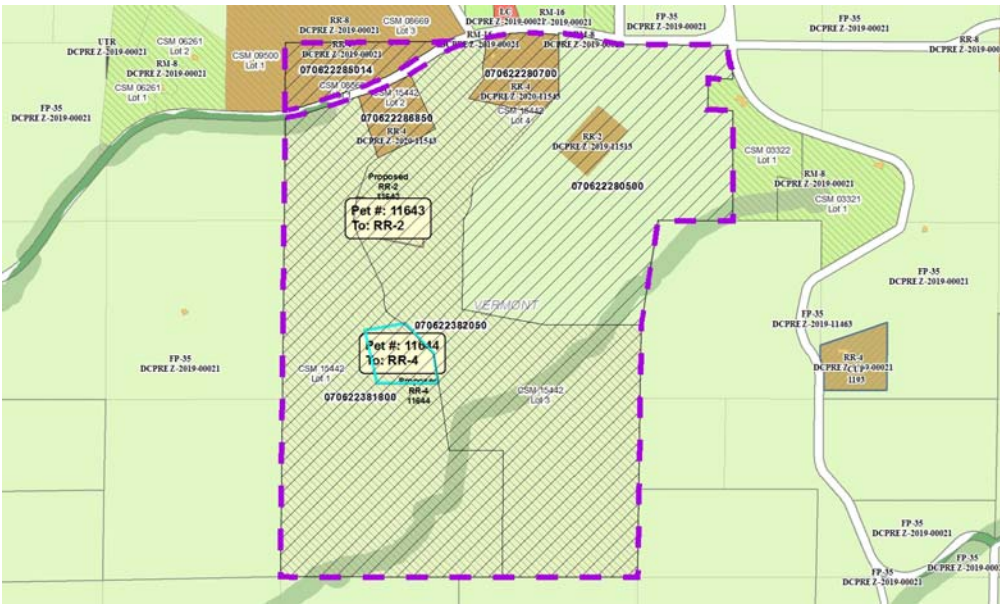

Reasons/Notes:

Homesites created to date: 3 per CSM 8562, CSM 15442, Lot 2 and Rezone 2019-11513. Separation of existing residence exempt from density cap. If 11643 and 11644 are approved, there will be 2 sites remaining.

Note: Parcels included in the density study reflect farm ownership and acreage as of the date of town plan adoption, or other date specified. Density study is based on the original farm acreage, NOT acreage currently owned.

Parcel #	Acres	Owner Name	CSM
070622280700	7.04	JOHN SAMZ & CASIE SAMZ	15442
070622280500	70.17	KIRK P LYNCH & LAURA C LYNCH	
070622285014	7.97	MARK T HAUKOOS & KATHY M HAUKOOS	08562
070622382050	86.47	PATRICIA A ROBERTS & ROBERTS TR, PATRICIA A	15442
070622381800	82.83	PATRICIA A ROBERTS & ROBERTS TR, PATRICIA A	15442
070622286850	4.69	PATRICIA A ROBERTS & ROBERTS TR, PATRICIA A	15442