

DRAFT: FOR DISCUSSION PURPOSES ONLY

IMPORTANT NOTE: ACREAGE VALUES AND OWNERSHIP HEREIN ARE DERIVED FROM HISTORICAL AND CURRENT RECORDS LOCATED AT THE DANE COUNTY DEPARTMENT OF PLANNING AND DEVELOPMENT (EG. GIS, PLAT BOOKS, ZONING PERMIT DATA, CSM'S, ETC). DENSITY POLICIES VARY AMONG TOWNS AND MAY REQUIRE INTERPRETATION.

Public Hearing Date	9/26/2017	Petition Number	11191	Applicant:	Eileen Statz
Town	Berry	A-1EX Adoption	12/12/1981	Orig Farm Owner	A.D. Dickson
Section:	32	Density Number	35	Original Farm Acres	39.95
Density Study Date	9/15/2017	Original Splits	1.14	Available Density Unit(s)	0

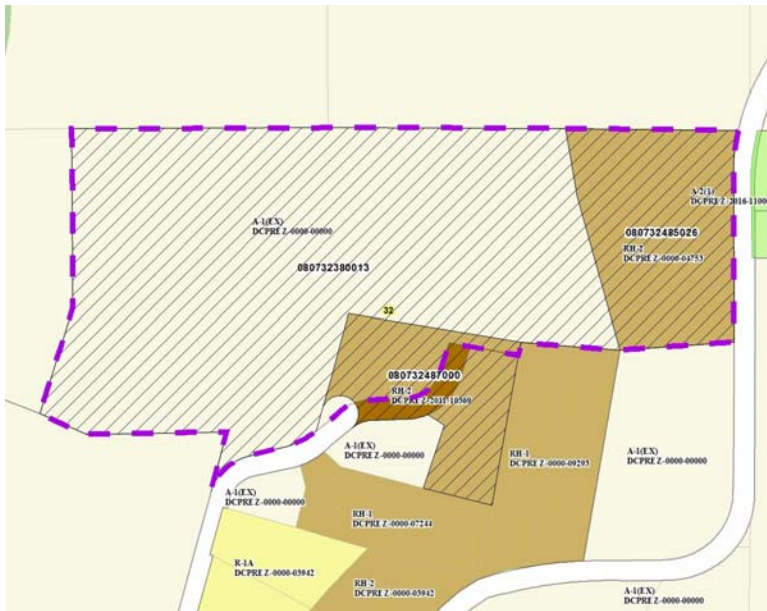

Reasons/Notes:

- [1] Original 1981 split available.
- [-1] Rezone 4753

No splits remain

Note: Parcels included in the density study reflect farm ownership and acreage as of the date of town plan adoption, or other date specified. Density study is based on the original farm acreage, NOT acreage currently owned.

Parcel #	Acres	Owner Name	CSM
080732487000	4.82	MARK D GRIESBACH & CINDY P GRIESBACH	13249
080732485026	7.1	MARK J STOVEKEN & KATHY J STOVEKEN	06199
080732380013	30.69	VERNON W STATZ & EILEEN M STATZ	