

# DRAFT: FOR DISCUSSION PURPOSES ONLY

IMPORTANT NOTE: ACREAGE VALUES AND OWNERSHIP HEREIN ARE DERIVED FROM HISTORICAL AND CURRENT RECORDS LOCATED AT THE DANE COUNTY DEPARTMENT OF PLANNING AND DEVELOPMENT (EG. GIS, PLAT BOOKS, ZONING PERMIT DATA, CSM'S, ETC). DENSITY POLICIES VARY AMONG TOWNS AND MAY REQUIRE INTERPRETATION.

<b>Public Hearing Date</b>	6/23/2020	<b>Petition Number</b>	11562	<b>Applicant:</b>	Carolyn Bradt
<b>Town</b>	Springdale	<b>A-1EX Adoption</b>		<b>Orig Farm Owner</b>	J & C Bradt
<b>Section:</b>	02	<b>Density Number</b>	25	<b>Original Farm Acres</b>	15.43
<b>Density Study Date</b>	6/2/2020	<b>Original Splits</b>	0.62	<b>Available Density Unit(s)</b>	1

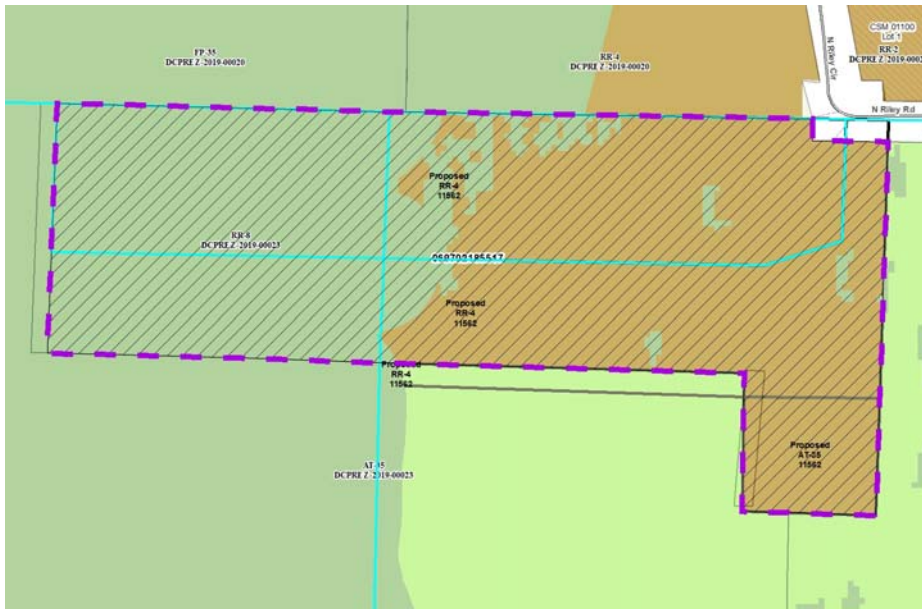

**Reasons/Notes:**

Town plan allows for one division of parcels of between 14 and 17 acres in size. Development should avoid resource protection corridors.

Note: Parcels included in the density study reflect farm ownership and acreage as of the date of town plan adoption, or other date specified. Density study is based on the original farm acreage, NOT acreage currently owned.

Parcel #	Acres	Owner Name	CSM
060702185517	15.43	CAROLYN J BRADT	