

# DRAFT: FOR DISCUSSION PURPOSES ONLY

IMPORTANT NOTE: ACREAGE VALUES AND OWNERSHIP HEREIN ARE DERIVED FROM HISTORICAL AND CURRENT RECORDS LOCATED AT THE DANE COUNTY DEPARTMENT OF PLANNING AND DEVELOPMENT (EG. GIS, PLAT BOOKS, ZONING PERMIT DATA, CSM'S, ETC). DENSITY POLICIES VARY AMONG TOWNS AND MAY REQUIRE INTERPRETATION.

<b>Public Hearing Date</b>	8/24/2021	<b>Petition Number</b>	11730	<b>Applicant:</b>	Mitch Seston
<b>Town</b>	Black Earth	<b>A-1EX Adoption</b>	8/15/1981	<b>Orig Farm Owner</b>	Coletta Lucey
<b>Section:</b>	21, 22	<b>Density Number</b>	35	<b>Original Farm Acres</b>	139.83
<b>Density Study Date</b>	8/24/2021	<b>Original Splits</b>	4	<b>Available Density Unit(s)</b>	2

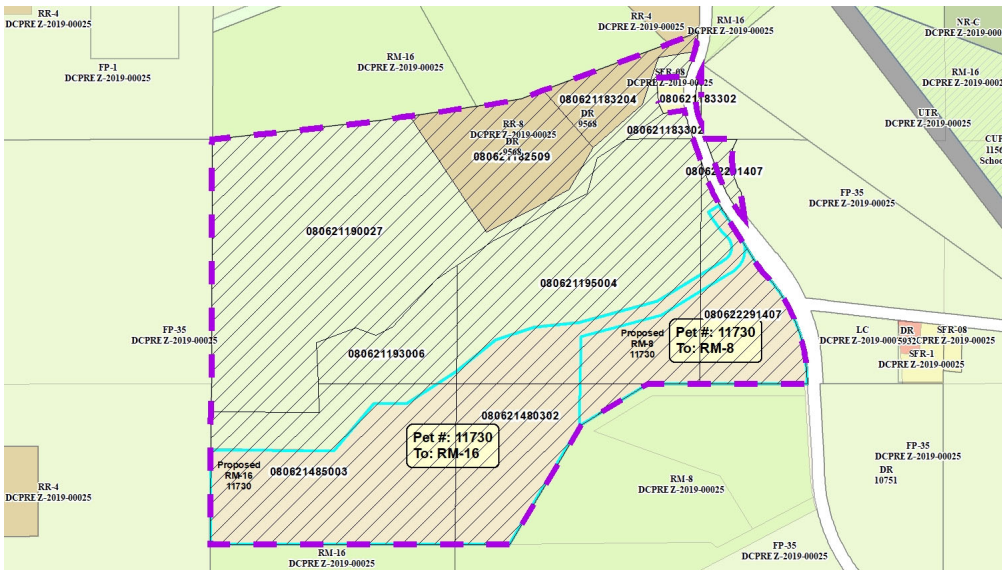

**Reasons/Notes:**

- [4] Original Housing Density Rights
- [-1] RR-8
- [-1] PIN #080621190027
- [2] Housing Density Right Remains

Note: Parcels included in the density study reflect farm ownership and acreage as of the date of town plan adoption, or other date specified. Density study is based on the original farm acreage, NOT acreage currently owned.

Parcel #	Acres	Owner Name	CSM
080622291407	9.88	MITCHEL LEWIS SESTON & JULIE A SESTON	
080621485003	24.44	MITCHEL LEWIS SESTON & JULIE A SESTON	
080621480302	11.58	MITCHEL LEWIS SESTON & JULIE A SESTON	
080621195004	31.9	MITCHEL LEWIS SESTON & JULIE A SESTON	
080621193006	6.47	MITCHEL LEWIS SESTON & JULIE A SESTON	
080621183302	0.92	MITCHEL LEWIS SESTON & JULIE A SESTON	
080621183204	4.08	PETER L JOPKE & ANGELINA L JOPKE	06869
080621182509	9.98	PETER L JOPKE & ANGELINA L JOPKE	
080621190027	40.59	VOSEN LIVING TRUST	