

There are no objections to this plat with respect to Secs. 236.15, 236.16, 236.20 and 236.21(1) and (2), Wis. Stats. as provided by s. 236.12, Wis. Stats.

Certified _____, 20____

Department of Administration

NORTH ADDITION TO GRANDVIEW COMMONS

A REPLAT OF LOTS 33-40, 57-61 AND 155-156 GRANDVIEW COMMONS, RECORDED IN VOLUME 58-005A OF PLATS ON PAGES 19-33 AS DOCUMENT NUMBER 3583911, DANE COUNTY REGISTRY, LOT 1, CERTIFIED SURVEY MAP NO. 10460, RECORDED IN VOLUME 61 OF CERTIFIED SURVEY MAPS ON PAGES 346-348 AS DOCUMENT NUMBER 3512375, DANE COUNTY REGISTRY AND A PARCEL OF LAND ALL LOCATED IN THE NE1/4 AND THE SE1/4 OF THE SW1/4 AND IN THE SE1/4 OF SECTION 2, T7N, R10E, CITY OF MADISON, DANE COUNTY, WISCONSIN

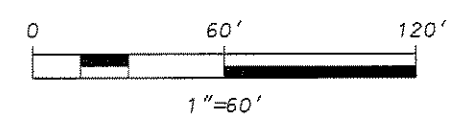
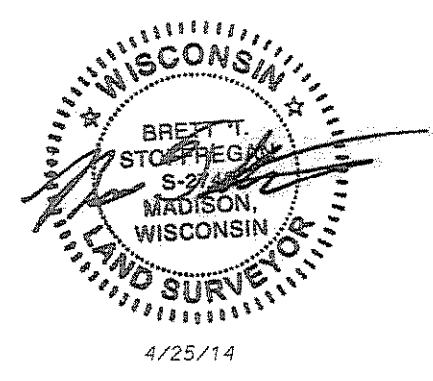

BEARINGS REFERENCED TO THE EAST LINE OF THE SOUTHWEST QUARTER OF SECTION 2, T7N, R10E BEARING S01°04'02"W WISCONSIN COUNTY COORDINATE SYSTEM (DANE ZONE)

Received: 04/25/2014
CPA
27247

D'ONOFRIO KOTTKE AND ASSOCIATES, INC.
7530 Westward Way, Madison, WI 53717
Phone: 608.833.7530 • Fax: 608.833.1089
YOUR NATURAL RESOURCE FOR LAND DEVELOPMENT

This instrument was drafted by D'Onofrio Kottke and Associates. FN:12-07-105

SHEET 4 OF 7