

SHEET INDEX

SIXTH ADDITION TO SMITH'S CROSSING

Being Lots 157-169, 174-181, 217-250, 256-408, Outlot 22, Outlot 24, Outlots 27-28, Outlot 29, vacated by court order (Case no 15-CV-1828, August 17, 2015, Document No. 5177829), Outlots 30-43, Outlot 45, the following streets discontinued by Common Council Resolution (No. 15/145, File No. 12,313, August 18, 2015) Corbet Street, Wildflower Way, Winding Stream Way, Cherry Crest Court, Italiante Drive, Butterfly Circle, part of Koshkonong Way, part of Brown Bear Way, part of Fair Pheasant Way and part of Leopold Way, First Addition to Smith's Crossing recorded in Volume 58-097A of Plats on Pages 501-521 as Document No. 4143211, Dane County Registry; located in the NE1/4-NW1/4, SE1/4-NW1/4, SW1/4-NW1/4, NW1/4-NE1/4, SE1/4-NE1/4, SW1/4-NE1/4, NE1/4-SE1/4, NW1/4-SE1/4, NW1/4-SW1/4, NE1/4-SW1/4 AND THE SE1/4-SW1/4, Section 13, T8N, R10E, City of Sun Prairie, Dane County, Wisconsin

There are no objections to this plat with respect to Secs. 236.15, 236.16, 236.20 and 236.21(1) and (2), Wis. Stats. as provided by s. 236.12, Wis. Stats.

Certified _____, 20__

Department of Administration

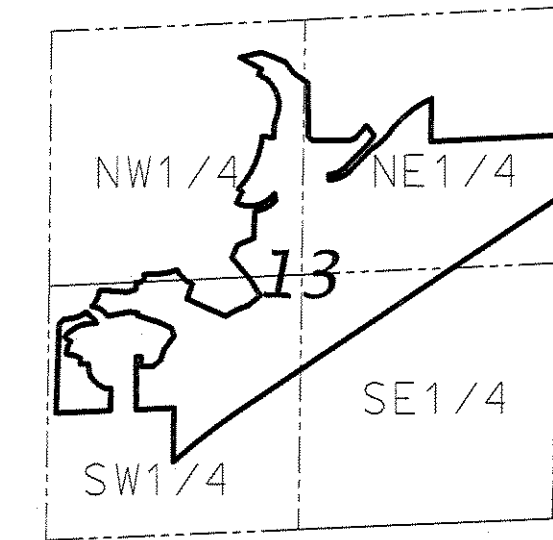

LOCATION MAP
NOT TO SCALE

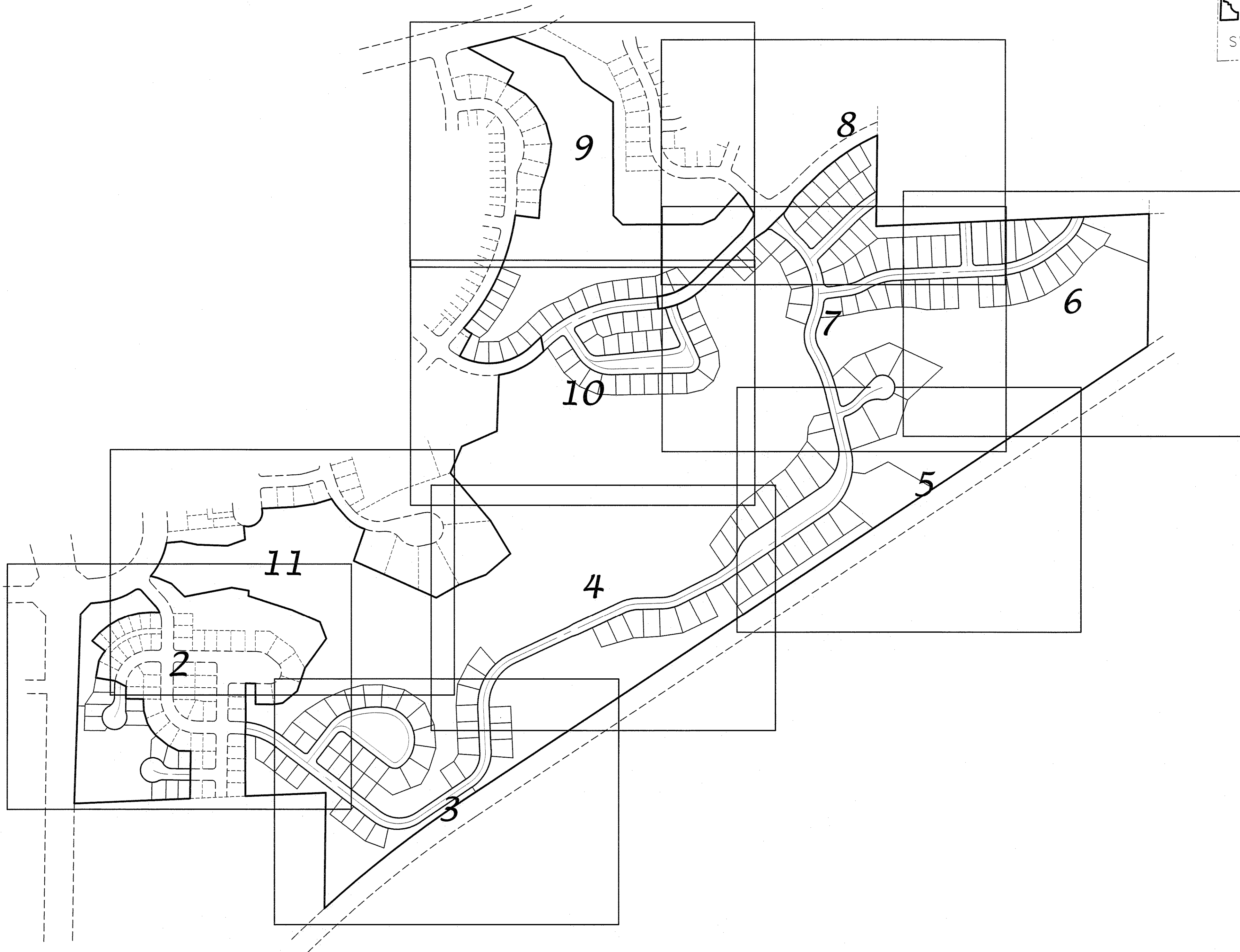

0 300' 600'
1"=300'

BEARINGS REFERENCED TO THE NORTH LINE OF THE NW1/4 OF SECTION 13, T8N-R10E ASSUMED TO BEAR S87°30'53"E

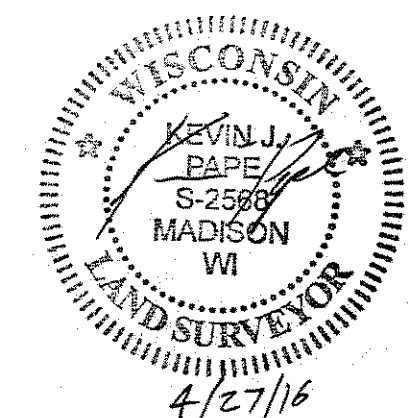

4/27/16

Received: 04/27/2016
CPA

27500

D'ONOFRIO KOTTKE AND ASSOCIATES, INC.

7530 Westward Way, Madison, WI 53717
Phone: 608.833.7530 • Fax: 608.833.1089

YOUR NATURAL RESOURCE FOR LAND DEVELOPMENT

FN:15-07-102