

AREA ANNEXED BY 2020

FINAL
February 18, 2005

BOUNDARY AGREEMENT: EXHIBIT "A" SOUTH CITY OF MADISON & TOWN OF BLOOMING GROVE

 SOUTH PHASED ANNEXATION AREA

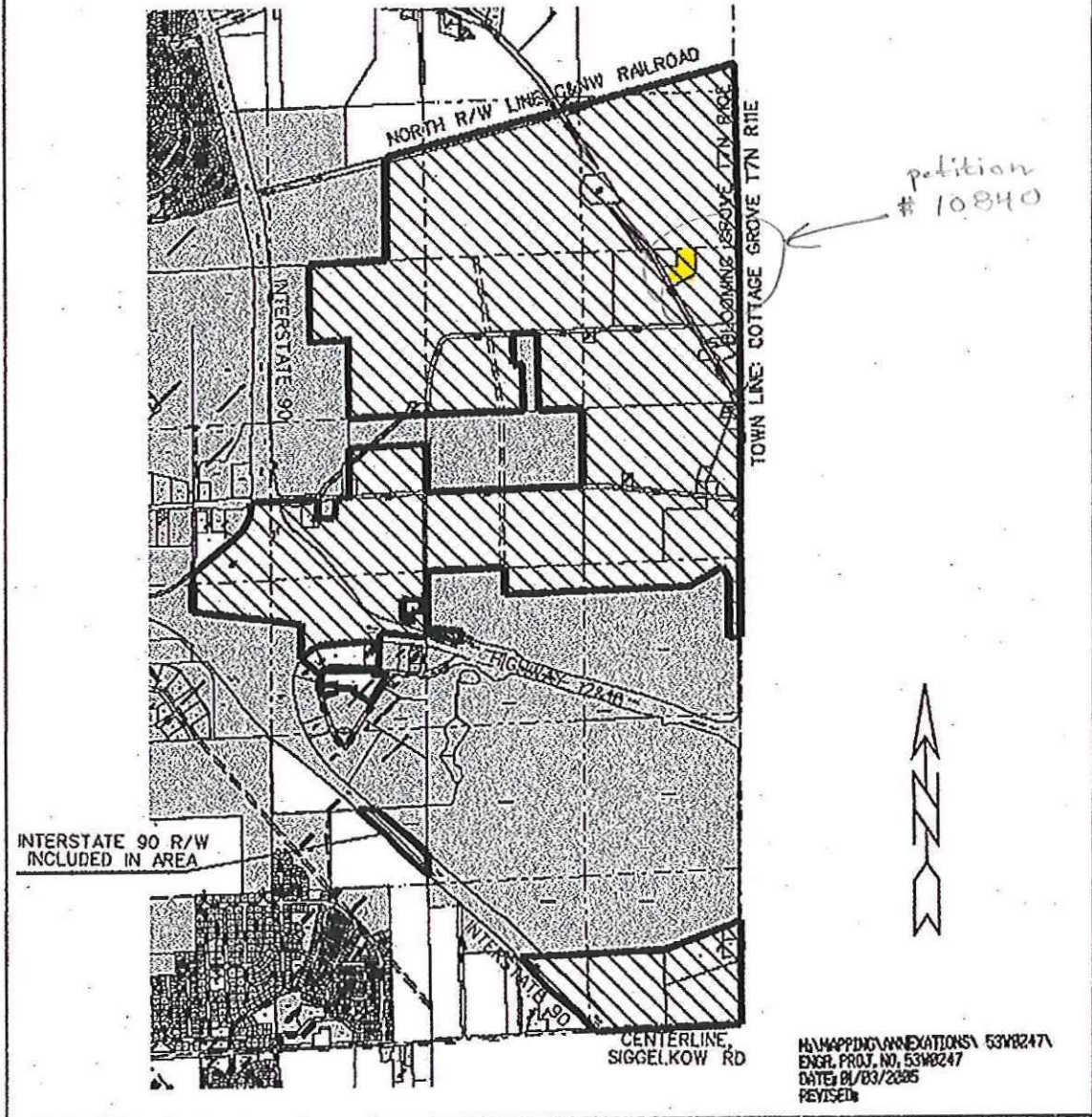

M:\MAPPING\ANNEXATIONS\ 5318247
ENGR. PROJ. NO. 5318247
DATE: 01/03/2005
REVISED:

adopt an ordinance annexing such territory. The annexation shall be effective as of 12:01 a.m. on the last Monday in December 2015. Unless otherwise agreed to by the Parties in writing, if the Town gives written notice to the City Clerk between January 1, 2015 and April 30, 2015 reminding the City of the City's right to annex under this subsection, then the City shall lose the right if it is not exercised by August 31, 2015. If the Town fails to give such notice and the City fails to exercise its right, then the City may, by June 30 of any year after 2015, adopt an ordinance annexing such territory effective at 12:01 a.m. on the last Monday in December of the same year.

As a complete alternative to the City adopting an ordinance annexing such territory as provided in this Section 2.B (1), the City and the Town may agree in writing to a different schedule for annexing all or part of such territory to the City after January 1, 2015.

- (2) All or part of Town territory east of the western right-of-way line of I-39/90, south of the northern Chicago & Northwestern Railroad right-of-way line and north of Siggelkow Road described and shown on Exhibit A (the "South Phased Annexation Area") that has not been voluntarily annexed to the City by January 1, 2020 may become a part of the City as follows:

At any time between January 1, 2020 and August 31, 2020, the City, upon a 2/3 vote of the elected members of the City's Common Council, may adopt an ordinance annexing such territory. The annexation shall be effective as of 12:01 a.m. on the last Monday in December 2020. Unless otherwise agreed to by the Parties in writing, if the Town gives written notice to the City Clerk between January 1, 2020 and April 30, 2020 reminding the City of the City's right to annex under this subsection, then the City shall lose the right if it is not exercised by August 31, 2020. If the Town fails to give such notice and the City fails to exercise its right, then the City may, by June 30 of any year after 2020, adopt an ordinance annexing such territory effective at 12:01 a.m. on the last Monday in December of the same year.

As a complete alternative to the City adopting an ordinance annexing such territory as provided in this Section 2.B.(2), the City and the Town may agree in writing to a different schedule for annexing all or part of such territory to the City after January 1, 2020.

- (3) Early annexations with the consent of the property owner are also permissible within the North and South Phased Annexation areas. Approval of resident electors shall not be required.