

Staff Report  Zoning and Land Regulation Committee Questions? Contact: Majid Allan: 267-2536 allan@countyofdane.com	<i>Public Hearing:</i> December 22, 2020		Petition 11625
	<i>Zoning Amendment Requested:</i> RM-8 Rural Mixed-Use District TO GC General Commercial District		<i>Town/Section:</i> COTTAGE GROVE, Section 16
	<i>Size:</i> 3.35 Acres	<i>Survey Required:</i> No	<i>Applicant:</i> COTTAGE GROVE, TOWN OF
	<i>Reason for the request:</i> Change zoning to allow for an electronic message board for emergency management services		<i>Address:</i> 4030 COUNTY HWY N

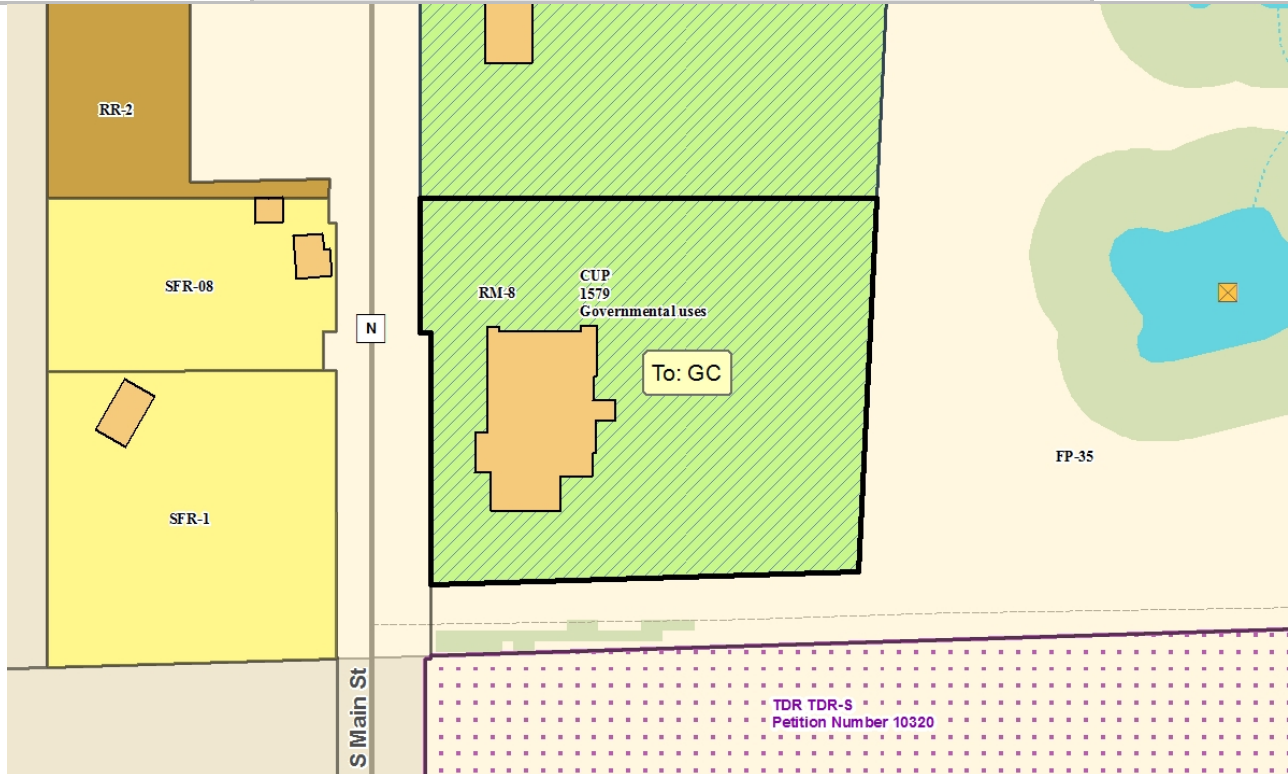

DESCRIPTION: The town of Cottage Grove on behalf of Deer-Grove Emergency Medical Services (DGEMS) is requesting GC (General Commercial) zoning for the 3.4 acre DGEMS administrative services property at 4030 County Highway N. The GC zoning is requested to allow installation of a electronic message sign. No change in land use is proposed.

OBSERVATIONS: Current land use of the property are the administrative offices for the Deer-Grove EMS. Neighboring land uses are the town of Cottage Grove town hall, scattered rural residential, agriculture / open space, and agricultural services. No sensitive environmental features observed. No new development proposed. Existing Conditional Use Permit #1579 for Governmental Uses will continue to remain in effect.

TOWN PLAN: The property is located in the town’s commercial planning area.

RESOURCE PROTECTION: No resource protection corridors located on the property.

STAFF: The proposed GC zoning is consistent with town plan policies and will enable installation of the planned electronic sign to provide timely information regarding EMS services, etc. Staff recommends approval of the petition with no conditions.

TOWN: The Town Board approved the petition with no conditions.