

# DRAFT: FOR DISCUSSION PURPOSES ONLY

IMPORTANT NOTE: ACREAGE VALUES AND OWNERSHIP HEREIN ARE DERIVED FROM HISTORICAL AND CURRENT RECORDS LOCATED AT THE DANE COUNTY DEPARTMENT OF PLANNING AND DEVELOPMENT (EG. GIS, PLAT BOOKS, ZONING PERMIT DATA, CSM'S, ETC). DENSITY POLICIES VARY AMONG TOWNS AND MAY REQUIRE INTERPRETATION.

**Applicant:** Michael Rumpf

<b>Town</b>	Cottage Grove	<b>A-1EX Adoption</b>	5/15/1982	<b>Orig Farm Owner</b>	George Hauge
<b>Section:</b>	36	<b>Density Number</b>	35	<b>Original Farm Acres</b>	79.19
<b>Density Study Date</b>	12/7/2016	<b>Original Splits</b>	2.26	<b>Available Density Unit(s)</b>	2

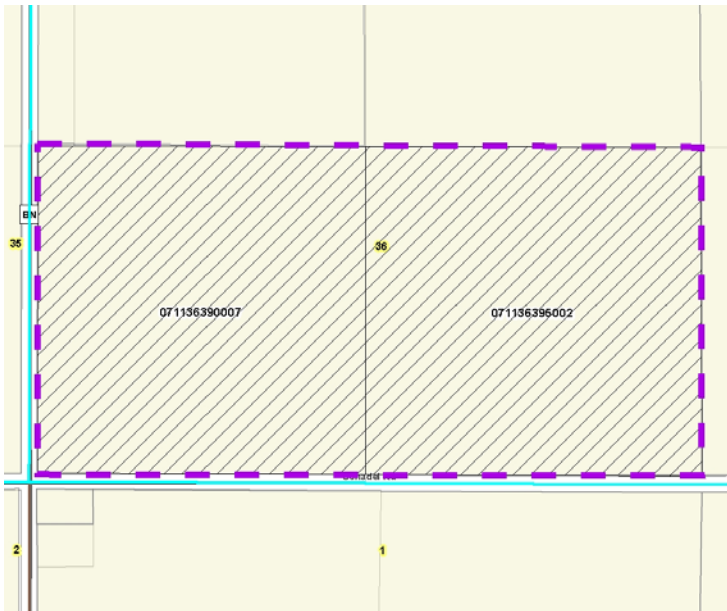

**Reasons/Notes:**

This property is located within an agricultural preservation area in which the town of Cottage Grove limits development to 1 Residential Development Unit (RDU) per 35 acres of land owned as of May 15, 1982. There are two (2) RDUs remaining.

Note: Parcels included in the density study reflect farm ownership and acreage as of the date of town plan adoption, or other date specified. Density study is based on the original farm acreage, NOT acreage currently owned.

Parcel #	Acres	Owner Name	CSM
071136395002	39.96	GEORGE HAUGE	
071136390007	38.91	GEORGE HAUGE	