

DRAFT: FOR DISCUSSION PURPOSES ONLY

IMPORTANT NOTE: ACREAGE VALUES AND OWNERSHIP HEREIN ARE DERIVED FROM HISTORICAL AND CURRENT RECORDS LOCATED AT THE DANE COUNTY DEPARTMENT OF PLANNING AND DEVELOPMENT (EG. GIS, PLAT BOOKS, ZONING PERMIT DATA, CSM'S, ETC). DENSITY POLICIES VARY AMONG TOWNS AND MAY REQUIRE INTERPRETATION.

Public Hearing Date	12/22/2020	Petition Number	11616	Applicant:	Chris Davis
Town	Cross Plains	A-1EX Adoption	12/26/1981	Orig Farm Owner	Connery, Tim
Section:	16	Density Number	35	Original Farm Acres	40.44
Density Study Date	12/1/2020	Original Splits	1.16	Available Density Unit(s)	1

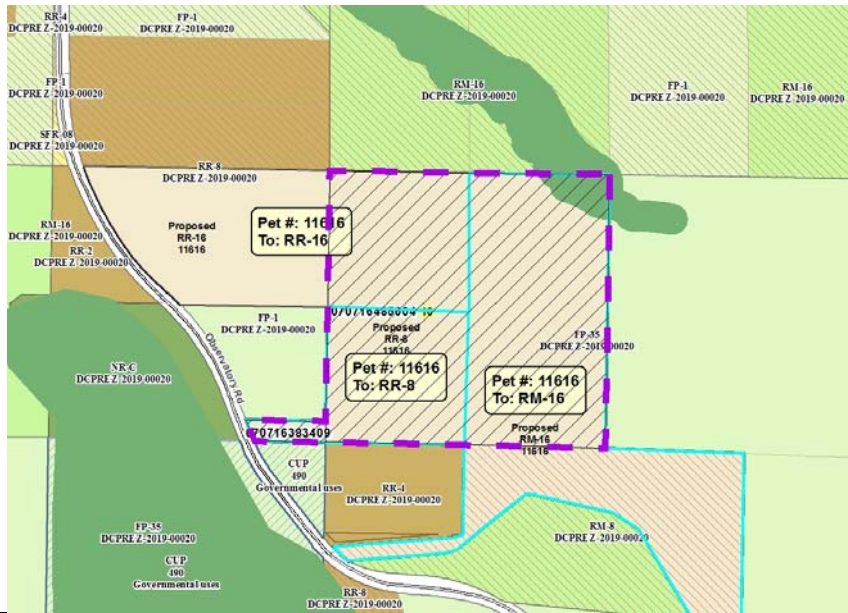

Reasons/Notes:
 Homesites created to date:
 NONE

Note: Parcels included in the density study reflect farm ownership and acreage as of the date of town plan adoption, or other date specified. Density study is based on the original farm acreage, NOT acreage currently owned.

Parcel #	Acres	Owner Name	CSM
070716485004	39.62	DANA T RADAVIDICH & LORI D RADAVIDICH	
070716383409	0.82	DANA T RADAVIDICH & LORI D RADAVIDICH	