

Dane County Contract Cover Sheet

Res 645
Significant

Dept./Division	Public Works, Highway & Transportation
Vendor Name	City of Verona
Vendor MUNIS #	4364 1391
Brief Contract Title/Description	Agreement for the reconstruction of CTH PD from Woods Rd to CTH M in the City of Verona
Contract Term	1/1/19 to 12/31/19
Total Contract Amount	\$ 881,000

Contract # <small>Admin will assign</small>	13812
Addendum	<input type="checkbox"/> Yes <input checked="" type="checkbox"/> No
Type of Contract	
<input checked="" type="checkbox"/>	Dane County Contract
<input type="checkbox"/>	Grant
<input type="checkbox"/>	County Lessee
<input type="checkbox"/>	County Lessor
<input type="checkbox"/>	Intergovernmental
<input type="checkbox"/>	Purchase of Property
<input type="checkbox"/>	Property Sale
<input type="checkbox"/>	Other

Purchasing Authority	<input type="checkbox"/> \$10,000 or under – Best Judgment (1 quote required)	
	<input type="checkbox"/> Between \$10,000 – \$36,000 (\$0 – \$25,000 Public Works) (3 quotes required)	
	<input type="checkbox"/> Over \$36,000 (\$25,000 Public Works) (Formal RFB/RFP required)	RFB/RFP #
	<input type="checkbox"/> Bid Waiver – \$36,000 or under (\$25,000 or under Public Works)	
	<input type="checkbox"/> Bid Waiver – Over \$36,000 (N/A to Public Works)	
	<input type="checkbox"/> N/A – Grants, Leases, Intergovernmental, Property Purchase/Sale, Other	

MUNIS Req.	Org Code	HWCONCAP	Obj Code	57256	Amount	\$ 881,000
Req #	Org Code		Obj Code		Amount	\$
Year	Org Code		Obj Code		Amount	\$

Resolution	A resolution is required if the contract exceeds \$100,000 (\$40,000 Public Works). A copy of the Resolution must be attached to the contract cover sheet.		
	<input type="checkbox"/> Contract does not exceed \$100,000 (\$40,000 Public Works) – a resolution is not required.		
	<input checked="" type="checkbox"/> Contract exceeds \$100,000 (\$40,000 Public Works) – resolution required.	Res #	645
	<input type="checkbox"/> A copy of the Resolution is attached to the contract cover sheet.	Year	2019

Contract Review/Approvals				
Initials	Dept.	Date In	Date Out	Comments
<i>Mg</i>	Received by DOA	10/2/19		
<i>aw</i>	Controller		10/2/19	
<i>Ge</i>	Purchasing	10/3/19	10/3/19	
<i>M</i>	Corporation Counsel	10/4/19	10/4/19	
<i>X</i>	Risk Management	10/2/19	10/3/19	
	County Executive			

Dane County Dept. Contact Info		Vendor Contact Info	
Name	Jim Matzinger	Name	Ellen Clark
Phone #	608-266-4040	Phone #	608-848-9947
Email	matzinger@countyofdane.com	Email	ellen.clark@ci.verona.wi.us
Address	2302 Fish Hatchery Rd, Madison	Address	111 Lincoln St, Verona WI 53593

Certification: The attached contract is a:	
<input checked="" type="checkbox"/>	Dane County Contract <u>without</u> any modifications.
<input type="checkbox"/>	Dane County Contract <u>with</u> modifications. The modifications have been reviewed by:
<input type="checkbox"/>	Non-standard contract.

Contract Cover Sheet Signature

Department Approval of Contract		
Dept. Head / Authorized Designee	Signature	Date
		10/2/19
	Printed Name	
	Gerald Mandli	

Contracts Exceeding \$100,000

Major Contracts Review – DCO Sect. 25.11(3)

Director of Administration	Signature	Date
		10/4/19
	Comments	
Corporation Counsel	Signature	Date
		10/4/19
	Comments	

AGREEMENT FOR THE RECONSTRUCTION OF CTH PD, FROM WOODS RD TO CTH M, IN THE CITY OF VERONA

The Dane County Department of Public Works, Highway & Transportation and representatives of the City of Verona have determined that CTH PD is in need of reconstruction from Woods Road to CTH M.

Funding for the construction of the project is to be accomplished in accordance with past policies of cost sharing on similar CTH projects.

After making the following transfer, the department has funds available in account HWCONCAP-57256 to cover the project costs. The County's maximum share is \$881,000.

NOW THEREFORE BE IT RESOLVED that the following fund transfer be made to increase the project construction budget:

Expense Budget:

HWCONCAP-57256, CTH PD	\$312,481
HWCONCAP-59064, CTH CV	\$(92,603)
HWCONCAP-59037, CTH DM	\$(56,984)
HWCONCAP-59173, CTH I	\$(49,778)
HWCONCAP-59072, CTH Z	\$(113,116)

NOW THEREFORE BE IT RESOLVED that the County Executive and the County Clerk be authorized and directed to execute this cost sharing agreement on behalf of Dane County, with the City of Verona.

BE IT FINALLY RESOVED that any unexpended funds as of December 31, 2019, in the above mentioned accounts be carried forward to 2020 .

**AGREEMENT FOR THE RECONSTRUCTION OF CTH PD, FROM WOODS ROAD TO
CTH M, IN THE CITY OF VERONA**

THIS AGREEMENT ("Agreement") is made and entered into by and between the County of Dane, a quasi-municipal corporation in the State of Wisconsin (hereinafter referred to as "COUNTY"), and the City of Verona; a municipal corporation in the State of Wisconsin (hereinafter referred to as "CITY")

WITNESSETH:

WHEREAS CITY and COUNTY have determined that CTH PD, from Woods Road to CTH M, requires design and reconstruction ("the Project") as shown in Exhibit A, which will require contributions from CITY and COUNTY; and

WHEREAS the costs of the Project will be financed by COUNTY and CITY funds; and

WHEREAS funding is to be accomplished in accordance with COUNTY policies and past practices of cost sharing on similar CTH projects; and

WHEREAS pursuant to Section 66.0301, Wis. Stats., CITY and COUNTY wish to formalize arrangements for the Project's cost;

NOW, THEREFORE, in consideration of the above premises and the mutual covenants of the parties hereinafter set forth, the receipt and sufficiency of which is acknowledged by each party for itself, CITY and COUNTY do agree as follows:

1. The Project cost share shall include the placement of curb and gutter, asphaltic pavement, signage and final pavement markings of a four lane divided urban roadway. The parties' shares of the Project costs are as detailed in the attached Exhibit B.
2. COUNTY and CITY agree to joint financial participation for the construction costs as set forth in this Agreement and the Dane County Dept. of Public Works, Highway and Transportation's Policy on Joint Projects with Municipalities.
3. The Project is intended to be substantially completed by November of 2020.
4. COUNTY's total obligations under this Agreement shall not exceed \$881,000. CITY's total obligations under this Agreement shall not exceed \$1,324,000. CITY shall be responsible for all costs associated with the PROJECT not covered by COUNTY pursuant to COUNTY'S cost-share policy or this Agreement.
5. COUNTY will reimburse CITY, within 60 days of billing, for completed services according to the responsibilities stated above.
6. During the term of this Agreement, CITY and COUNTY, each for itself, agree to abide by its own equal employment and nondiscrimination policies and affirmative action plan.

7. Each party shall be responsible for the consequences of its own acts, errors, or omissions and those of its employees, boards, commissions, agencies, officers, and representatives and shall be responsible for any losses, claims, and liabilities which are attributable to such acts, errors, or omissions including providing its own defense. In situations including joint liability, each party shall be responsible for the consequences of its own acts, errors, or omissions and those of its employees, agents, boards, commissions, agencies, officers and representatives. It is not the intent of the parties to impose liability beyond that imposed by state statutes. The obligations of the parties under this paragraph shall survive the expiration or termination of this Agreement.
8. This Agreement may only be amended in writing upon agreement by both parties. Any changes in Project costs shall be done by amendment.
9. Each party warrants for itself that it has complied with all necessary requirements to execute this Agreement and that the person executing this Agreement on its behalf is authorized to do so.
10. The parties may evidence their agreement to the foregoing upon one or several counterparts of this instrument, which together shall constitute a single instrument.

This Agreement is entered into on this _____ day of _____, 2019.

FOR THE COUNTY:

Date Signed: _____

Joe Parisi, Dane County Executive

Date Signed: _____

Scott McDonell, Dane County Clerk

FOR THE CITY OF VERONA:

Date Signed: 9/30/2019



Luke Diaz, Mayor

Date Signed: 9/30/2019



Ellen Clark, City Clerk

EXHIBIT A
Project Plan Overview

Project Management: WMS, Design: LHM, Checked: ZSL, Approved: ZSL, Date: 2018-04-23, Lead: WMS, Date: 2018-04-23, File: 101, 11, DWG, Date: 2018-04-23, File: 101, 11, DWG, Date: 2018-04-23, File: 101, 11, DWG

CTH PD RECONSTRUCTION 2016-123 WOODS ROAD TO CTH M

CITY OF VERONA
DANE COUNTY, WI

EXISTING FEATURES LEGEND

- PROPERTY LINE / RIGHT-OF-WAY
- RP RAP
- INDEX CONTOUR
- INTERMEDIATE CONTOUR
- TREE / BRUSH LINE
- BUILDING BOUNDARY
- CURB AND GUTTER
- EDGE OF ASPHALT
- CONCRETE JOINTS
- DRIVE LAKE BOUNDARY / CENTERLINE
- EDGE OF DRIVEWAY
- CONCRETE EDGE
- EDGE OF GRAVEL
- EDGE SIDEWALK
- UNDERGROUND CONDUIT
- UNDERGROUND ELECTRIC
- UNDERGROUND TELEPHONE
- UNDERGROUND GAS
- UNDERGROUND FIBER OPTIC
- UNDERGROUND CABLE TELEVISION
- OVERHEAD UTILITIES
- OVERHEAD GUY WIRE
- STORM SEWER AND MANHOLE
- STORM SEWER AND CATCH BASIN
- SANITARY SEWER AND MANHOLE, < 36INCH DIAMETER
- SANITARY SEWER AND MANHOLE, > 36INCH DIAMETER
- WATER MAIN AND VALVE
- HYDRANT LEAD, HYDRANT, AND VALVE

PROPOSED FEATURES LEGEND

- ALIGNMENT CENTERLINE
- CURB AND GUTTER
- EDGE OF PAVEMENT
- EDGE OF GRAVEL
- SAW CUT
- CURB AND GUTTER REMOVAL
- STORM SEWER AND MANHOLE
- STORM SEWER AND INLET
- PAVED PEDESTRIAN PATH
- GRANITE BLOCK WALL
- REMOVE PIPE
- REMOVE FENCE
- FENCE
- SLOPE INTERCEPT
- TEMPORARY LIMITED EASEMENT
- PROPOSED RIGHT OF WAY
- X REMOVE BRUSH OR TREE

PROJECT VICINITY MAP

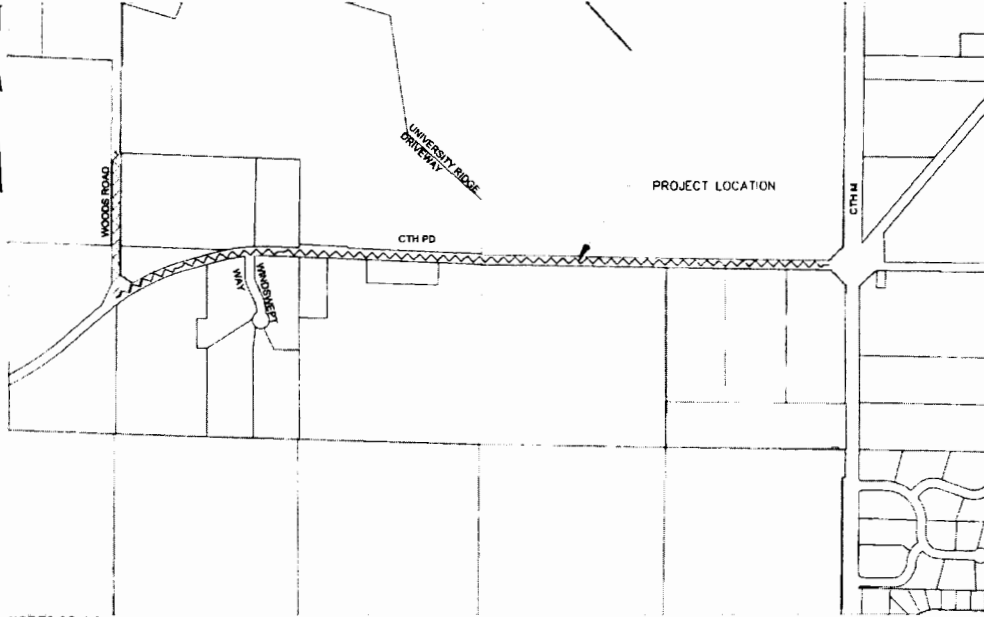

SYMBOLS

- BENCH MARK
- CONTROL POINT
- EXISTING CURB STORM INLET
- EXISTING STORM INLET
- APPROXIMATE SOIL BORING LOCATION AND NUMBER
- SHRUB
- TREE DECIDUOUS
- TREE CONIFEROUS
- 1" IRON PIPE
- PROPERTY IRON
- LIGHT POLE
- POLE, ELECTRIC
- POLE, ELECTRIC WITH LIGHT
- POLE, ELECTRIC TRANSMISSION
- END GUY WIRE
- PULL BOX, ELECTRIC
- ELECTRIC PEDESTAL
- ELECTRICAL METER
- TRAFFIC SIGNAL
- TRAFFIC SIGNAL WITH ARM
- TRAFFIC SIGNAL CONTROL BOX
- PULL BOX, TRAFFIC SIGNAL, 12"
- PULL BOX, TRAFFIC SIGNAL, 24"
- UTILITY MANHOLE
- UTILITY MARKER
- TELEPHONE PEDESTAL
- SPRINKLER HEAD
- DRAIN TILE, DAYLIGHT POINT
- SIGN
- FLAG POLE
- POST DELINEATOR

WISCONSIN
KELLY J WOLF
39796-6
PRAIRIE DU SAC
WIS.
PROFESSIONAL ENGINEER
Kelly J. Wolf
4-23-19

INDEX OF DRAWINGS

DRAWING NO.	SHEET NO.	ITEM DESCRIPTION
1		TITLE SHEET
2-3	CN	CONSTRUCTION NOTES
4	PO	PROJECT OVERVIEW
5-15	TS	TYPICAL SECTIONS
16-30	CD	CONSTRUCTION DETAILS
31-48	SD	WOODS SDD
50-60	PD	PLAN DETAILS
61-85	IS	INTERSECTION DETAILS
86-84	EC	EROSION CONTROL
85-92	SS	STORM SEWER
93-95	L	LANDSCAPING
98-102	PS	PERMANENT SIGNING & PERMANENT MARKING
103-105	LP	LIGHTING PLAN
106-180	TC	TRAFFIC CONTROL
181	DT	DETOUR ROUTE
182-184	AD	ALIGNMENT DATA
185-196	BP	TRANSPORTATION PROJECT PLAN
197-206	PP	PLAN AND PROFILES
207-272	XS	CROSS SECTIONS

PREPARED FOR

CITY OF
VERONA
111 LINCOLN STREET
VERONA, WI 53593
608-845-6495 tel
www.ci.verona.wi.us

POSITIONS SHOWN ON THESE PLANS ARE WISCONSIN COORDINATE REFERENCE SYSTEM COORDINATES (WISCRS), DANE COUNTY, MAD03(2011), IN U.S. SURVEY FEET. VALUES SHOWN ARE GRID COORDINATES, GRID BEARINGS, AND GRID DISTANCES. GRID DISTANCES MAY BE USED AS GROUND DISTANCES.

PREPARED BY

AECOM

AECOM
1350 DEMING WAY SUITE 100
MIDDLETON, WI 53562
608-836-8800 tel 608-836-8787 fax
www.aecom.com

CITY OF VERONA
CTH PD RECONSTRUCTION
2016-123 WOODS ROAD TO CTH M

AECOM

60530309

DANE COUNTY, WI

Project Management: Designer: L.W. Checkered: J.H.L. Approved: J.R.L. ANR03.27.14.M
 Printed By: mab2
 Plot File Date Created: Apr/25/2016 12:53 PM
 Layout Sheet Name: 01
 Plot Device: P:\00030309\WOODS_WOODS_010_000_000-SHEETS\020201_00.DWG

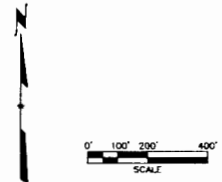
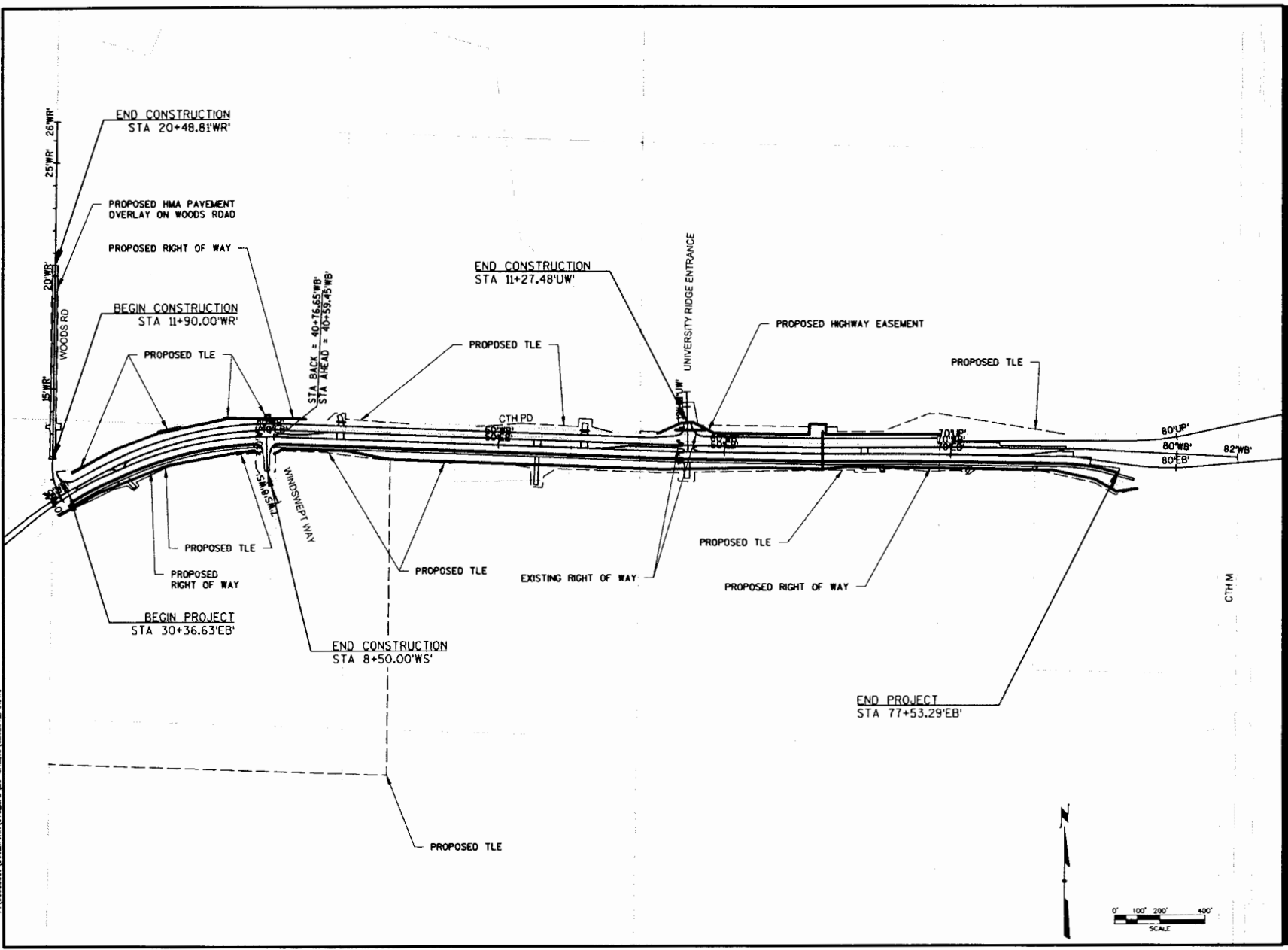

AECOM

PROJECT
 CTH PD
 RECONSTRUCTION
 2016-123
 WOODS ROAD TO CTH M
 VERONA, WISCONSIN

CLIENT
 CITY OF VERONA
 111 LINCOLN STREET
 VERONA, WISCONSIN 53583
 608-845-8495 tel
 www.ci.verona.wi.us

CONSULTANT
 AECOM
 1350 DEERING WAY SUITE 100
 MADISON, WI 53762
 608-836-8800 tel
 608-836-9767 fax
 www.aecom.com
 SUB-CONSULTANTS

REGISTRATION

ISSUE/REVISION

NO.	DATE	DESCRIPTION
1	4/18/2016	ORIGINAL

KEY PLAN

PROJECT NUMBER
 60530309
SHEET TITLE
 PROJECT OVERVIEW

SHEET NUMBER
 PD-1 4 of 272

EXHIBIT B
Cost Sharing Schedule

Estimate of Probable Project Cost
 CTH PD (Woods Road to CTH M)
 City of Verona ID 2016-123
 September 24, 2019

Item #	Item	Quantity	Units	Estimate Unit Cost	Estimate Total	CoV Split	Dane Co Split	CoV Split	Dane Co Split	Total	Notes
						%	%	\$	\$		
PROFESSIONAL SERVICES											
	Design - Permits, Plat, Plans, Specifications, and Estimate Preparation	1	LS	\$ 297,800.00	\$ 297,800.00	81%	19%	\$ 241,218.00	\$ 56,582.00	\$ 297,800.00	% Distribution based upon construction split of bid items
	Construction Administration	1	LS	\$ 79,361.00	\$ 79,361.00	81%	19%	\$ 64,282.41	\$ 15,078.59	\$ 79,361.00	
PAVEMENTS											
	Removing Asphaltic Surface Butt Joints	200	SY	\$ 25.00	\$ 5,000.00	50%	50%	\$ 2,500.00	\$ 2,500.00	\$ 5,000.00	
	Tack Coat	2,000	Gal	\$ 3.00	\$ 6,000.00	50%	50%	\$ 3,000.00	\$ 3,000.00	\$ 6,000.00	
	HMA Pavement 3 MT 58-28 S	6,500	Ton	\$ 75.00	\$ 487,500.00	50%	50%	\$ 243,750.00	\$ 243,750.00	\$ 487,500.00	
	HMA Pavement 4 MT 58-28 S	400	Ton	\$ 90.00	\$ 36,000.00	50%	50%	\$ 18,000.00	\$ 18,000.00	\$ 36,000.00	
	HMA Pavement 4 MT 58-28 H	4,100	Ton	\$ 80.00	\$ 328,000.00	50%	50%	\$ 164,000.00	\$ 164,000.00	\$ 328,000.00	
	Asphaltic Surface	1,300	Ton	\$ 80.00	\$ 104,000.00	50%	50%	\$ 52,000.00	\$ 52,000.00	\$ 104,000.00	
	Asphaltic Surface Temporary	30	Ton	\$ 200.00	\$ 6,000.00	50%	50%	\$ 3,000.00	\$ 3,000.00	\$ 6,000.00	
	Asphaltic Flumes	25	SY	\$ 70.00	\$ 1,718.89	50%	50%	\$ 859.44	\$ 859.44	\$ 1,718.89	
CONCRETE											
	Concrete Driveway 7-Inch	130	SY	\$ 60.00	\$ 7,800.00	50%	50%	\$ 3,900.00	\$ 3,900.00	\$ 7,800.00	
	Concrete Curb & Gutter 30-Inch Type D	8,700	LF	\$ 16.00	\$ 139,200.00	50%	50%	\$ 69,600.00	\$ 69,600.00	\$ 139,200.00	
	Concrete Sidewalk 7-Inch	600	SF	\$ 9.00	\$ 5,400.00	50%	50%	\$ 2,700.00	\$ 2,700.00	\$ 5,400.00	
	Curb Ramp Detectable Warning Field Natural Patina	60	SF	\$ 50.00	\$ 3,000.00	50%	50%	\$ 1,500.00	\$ 1,500.00	\$ 3,000.00	
	Concrete Median Sloped Nose	400	SF	\$ 10.00	\$ 4,000.00	50%	50%	\$ 2,000.00	\$ 2,000.00	\$ 4,000.00	
	Concrete Curb & Gutter 24-Inch Type D	8,050	LF	\$ 15.00	\$ 120,750.00	50%	50%	\$ 60,375.00	\$ 60,375.00	\$ 120,750.00	
	Concrete Curb & Gutter Special 24-Inch Type D	410	LF	\$ 18.00	\$ 7,380.00	50%	50%	\$ 3,690.00	\$ 3,690.00	\$ 7,380.00	
	36-Inch Concrete Gutter	170	LF	\$ 30.00	\$ 5,100.00	50%	50%	\$ 2,550.00	\$ 2,550.00	\$ 5,100.00	
PAVEMENT MARKINGS											
	Marking Line Epoxy 4-Inch	15,255	LF	\$ 0.75	\$ 11,441.25	50%	50%	\$ 5,720.63	\$ 5,720.63	\$ 11,441.25	
	Marking Line Epoxy 8-Inch	2,217	LF	\$ 1.00	\$ 2,217.00	50%	50%	\$ 1,108.50	\$ 1,108.50	\$ 2,217.00	
	Marking Arrow Epoxy	17	Each	\$ 250.00	\$ 4,250.00	50%	50%	\$ 2,125.00	\$ 2,125.00	\$ 4,250.00	
	Marking Word Epoxy	3	Each	\$ 300.00	\$ 900.00	50%	50%	\$ 450.00	\$ 450.00	\$ 900.00	
	Marking Symbol Epoxy	12	Each	\$ 225.00	\$ 2,700.00	50%	50%	\$ 1,350.00	\$ 1,350.00	\$ 2,700.00	
	Marking Stop Line Epoxy 18-Inch	45	LF	\$ 11.50	\$ 517.50	50%	50%	\$ 258.75	\$ 258.75	\$ 517.50	
	Marking Diagonal Epoxy 12-Inch	95	LF	\$ 8.75	\$ 831.25	50%	50%	\$ 415.63	\$ 415.63	\$ 831.25	
	Marking Chevron Epoxy 24-Inch	127	LF	\$ 12.50	\$ 1,587.50	50%	50%	\$ 793.75	\$ 793.75	\$ 1,587.50	
	Marking Crosswalk Epoxy Transverse Line 6-Inch	110	LF	\$ 9.50	\$ 1,045.00	50%	50%	\$ 522.50	\$ 522.50	\$ 1,045.00	
	Marking Curb Epoxy	235	LF	\$ 10.00	\$ 2,350.00	50%	50%	\$ 1,175.00	\$ 1,175.00	\$ 2,350.00	
	Marking Island Nose Epoxy	5	Each	\$ 200.00	\$ 1,000.00	50%	50%	\$ 500.00	\$ 500.00	\$ 1,000.00	

Estimate of Probable Project Cost
 CTH PD (Woods Road to CTH M)
 City of Verona ID 2016-123
 September 24, 2019

Item #	Item	Quantity	Units	Estimate Unit Cost	Estimate Total	CoV Split	Dane Co Split	CoV Split	Dane Co Split	Total	Notes
						%	%	\$	\$		
SIGNAGE											
	Posts Wood 4x6-Inch 12-FT	1	Each	\$ 65.00	\$ 65.00	50%	50%	\$ 32.50	\$ 32.50	\$ 65.00	
	Posts Wood 4x6-Inch 14-FT	39	Each	\$ 75.00	\$ 2,925.00	50%	50%	\$ 1,462.50	\$ 1,462.50	\$ 2,925.00	
	Posts Wood 4x6-Inch 16-FT	2	Each	\$ 85.00	\$ 170.00	50%	50%	\$ 85.00	\$ 85.00	\$ 170.00	
	Signs Type II Reflective H	225.39	SF	\$ 20.00	\$ 4,507.80	50%	50%	\$ 2,253.90	\$ 2,253.90	\$ 4,507.80	
	Signs Type II Reflective F	18.00	SF	\$ 30.00	\$ 540.00	50%	50%	\$ 270.00	\$ 270.00	\$ 540.00	
LIGHTING											
	CONDUIT RIGID NONMETALLIC SCHEDULE 40 2-INCH	1,722	L.F.	\$ 6.50	\$ 11,193.00	100%	0%	\$ 11,193.00	\$ -	\$ 11,193.00	
	CONDUIT RIGID NONMETALLIC SCHEDULE 40 3-INCH	746	L.F.	\$ 7.50	\$ 5,595.00	100%	0%	\$ 5,595.00	\$ -	\$ 5,595.00	
	Pull Boxes Non-Conductive 24x42-Inch	3	Each	\$ 1,500.00	\$ 4,500.00	100%	0%	\$ 4,500.00	\$ -	\$ 4,500.00	
	CONCRETE BASES TYPE 5	10	Each	\$ 700.00	\$ 7,000.00	100%	0%	\$ 7,000.00	\$ -	\$ 7,000.00	
	CONCRETE CONTROL CABINET BASE TYPE L30	1	Each	\$ 1,500.00	\$ 1,500.00	100%	0%	\$ 1,500.00	\$ -	\$ 1,500.00	
	Electrical Wire Lighting 12 AWG	3,144	LF	\$ 0.65	\$ 2,043.60	100%	0%	\$ 2,043.60	\$ -	\$ 2,043.60	
	Electrical Wire Lighting 8 AWG	9,420	L.F.	\$ 0.80	\$ 7,536.00	100%	0%	\$ 7,536.00	\$ -	\$ 7,536.00	
	Electrical Service Meter Breaker Pedestal CTH PD Lighting	1	LS	\$ 1,800.00	\$ 1,800.00	100%	0%	\$ 1,800.00	\$ -	\$ 1,800.00	
	Luminaires Utility LED B	20	Each	\$ 350.00	\$ 7,000.00	100%	0%	\$ 7,000.00	\$ -	\$ 7,000.00	
	Transport and Install Corridor Lighting Materials	1	LS	\$ 10,000.00	\$ 10,000.00	100%	0%	\$ 10,000.00	\$ -	\$ 10,000.00	
	Transformer Bases Breakaway 11 1/2-Inch Bolt Circle	10	Each	\$ 500.00	\$ 5,000.00	100%	0%	\$ 5,000.00	\$ -	\$ 5,000.00	
	Poles Type 5-Aluminum	10	Each	\$ 1,000.00	\$ 10,000.00	100%	0%	\$ 10,000.00	\$ -	\$ 10,000.00	
	Luminaire Arms Single member 4 1/2-Inch Clamp 6-FT	20	Each	\$ 250.00	\$ 5,000.00	100%	0%	\$ 5,000.00	\$ -	\$ 5,000.00	
	Lighting Control Cabinet 120/240 30-Inch	1	Each	\$ 7,000.00	\$ 7,000.00	100%	0%	\$ 7,000.00	\$ -	\$ 7,000.00	
SURVEYING											
	Landmark Reference Monuments	2	Each	\$ 1,000.00	\$ 2,000.00	50%	50%	\$ 1,000.00	\$ 1,000.00	\$ 2,000.00	
	Construction Staking	1	LS	\$ 65,000.00	\$ 65,000.00	50%	50%	\$ 32,500.00	\$ 32,500.00	\$ 65,000.00	
MOBILIZATION											
	Mobilization and Contract Administration	1	Each	\$ 100,000.00	\$ 100,000.00	50%	50%	\$ 50,000.00	\$ 50,000.00	\$ 100,000.00	
LANDSCAPING											
	Trees	98	Each	\$ 625.00	\$ 61,250.00	100%	0%	\$ 61,250.00	\$ -	\$ 61,250.00	
	Shrubs	46	Each	\$ 75.00	\$ 3,450.00	100%	0%	\$ 3,450.00	\$ -	\$ 3,450.00	
INCIDENTAL CONSTRUCTION											
	Raze residential dwellings	2	Each	\$ 20,000.00	\$ 40,000.00	100%	0%	\$ 40,000.00	\$ -	\$ 40,000.00	
SUBTOTALS											
	Sub-total - Construction				\$ 1,660,763.79			\$ 925,315.69	\$ 735,448.09	\$ 1,660,763.79	
	Construction Contingencies			10%	\$ 166,076.38			\$ 92,531.57	\$ 73,544.81	\$ 166,076.38	
	Sub-total - Professional Services				\$ 377,161.00			\$ 305,500.41	\$ 71,660.59	\$ 377,161.00	
	Estimated Cost				\$ 2,204,001.17					\$ 2,204,001.17	
											Use
City of Verona								\$ 1,323,347.67		\$ 1,324,000.00	
Dane County									\$ 880,653.49	\$ 881,000.00	
										\$ 2,205,000.00	