

DRAFT: FOR DISCUSSION PURPOSES ONLY

IMPORTANT NOTE: ACREAGE VALUES AND OWNERSHIP HEREIN ARE DERIVED FROM HISTORICAL AND CURRENT RECORDS LOCATED AT THE DANE COUNTY DEPARTMENT OF PLANNING AND DEVELOPMENT (EG. GIS, PLAT BOOKS, ZONING PERMIT DATA, CSM'S, ETC). DENSITY POLICIES VARY AMONG TOWNS AND MAY REQUIRE INTERPRETATION.

Public Hearing Date	7/25/2023	Petition Number	11958	Applicant:	Arthur Post
Town	Perry	A-1EX Adoption	8/22/1979	Orig Farm Owner	Eggiman Motors & Equip Sales, Inc
Section:	03, 04	Density Number	35	Original Farm Acres	236.98
Density Study Date	6/6/2023	Original Splits	6.77	Available Density Unit(s)	3

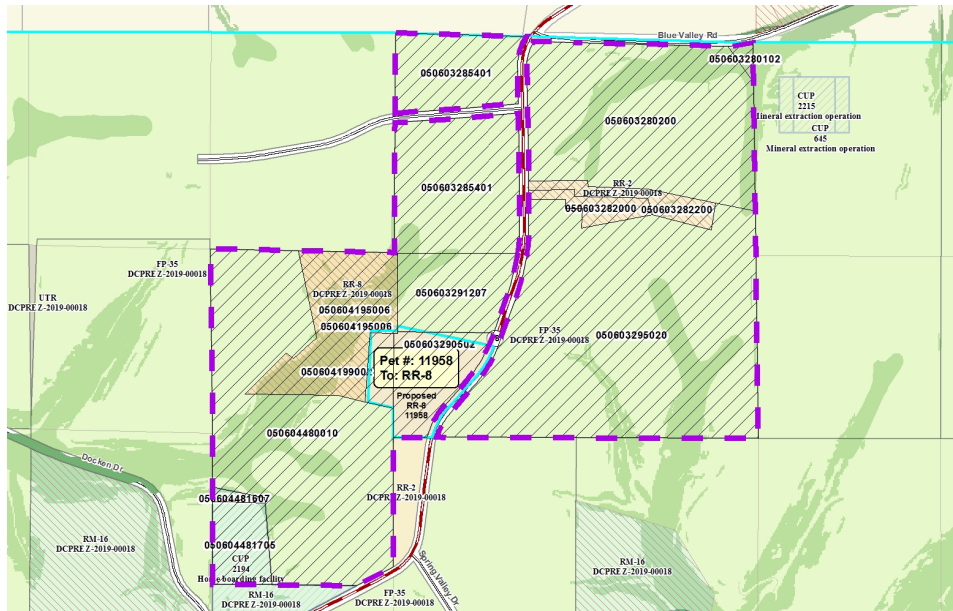

Reasons/Notes:
 Homesites created to date: 3 per CSM 4715 and 9962 (2 lots). 1 homesite allocated to land owned by Arthur and Lilliam Post.

Note: Parcels included in the density study reflect farm ownership and acreage as of the date of town plan adoption, or other date specified. Density study is based on the original farm acreage, NOT acreage currently owned.

Parcel #	Acres	Owner Name	CSM
050603280102	0.59	ALBERT BILSIE & NANCY BILSIE	
050604481705	5.47	ANDREW R MLSNA & ANGELE M MLSNA	
050604481607	0.62	ANDREW R MLSNA & ANGELE M MLSNA	
050604480010	48.58	ANDREW R MLSNA & ANGELE M MLSNA	
05060419002	2.23	ARTHUR L POST & LILLIAM M POST	
050603291207	10.35	ARTHUR L POST & LILLIAM M POST	
050603290502	8.51	ARTHUR L POST & LILLIAM M POST	
050603285401	30.99	ARTHUR L POST & LILLIAM M POST	
050603280200	39.19	CHAD S HEFTY & JANELLE M HEFTY	
050603295020	68.97	GERALD W KELLER & JUDITH A KELLER	

Note: Parcels included in the density study reflect farm ownership and acreage as of the date of town plan adoption, or other date specified. Density study is based on the original farm acreage, NOT acreage currently owned.

050604195006	15.33	JEFFREY A GORMAN & MICHELLE S GORMAN	04715
050603282200	3.46	JOHN G FLEMING & KIMBERLY A FLEMING	09962
050603282000	2.7	MARK E EASTMAN & JANET L EASTMAN	09962