

DRAFT: FOR DISCUSSION PURPOSES ONLY

IMPORTANT NOTE: ACREAGE VALUES AND OWNERSHIP HEREIN ARE DERIVED FROM HISTORICAL AND CURRENT RECORDS LOCATED AT THE DANE COUNTY DEPARTMENT OF PLANNING AND DEVELOPMENT (EG. GIS, PLAT BOOKS, ZONING PERMIT DATA, CSM'S, ETC). DENSITY POLICIES VARY AMONG TOWNS AND MAY REQUIRE INTERPRETATION.

Public Hearing Date	7/24/2018	Petition Number	11310	Applicant:	BRADY C GOMEZ
Town	Perry	A-1EX Adoption	8/22/1979	Orig Farm Owner	Matthias, V.W.
Section:	29, 32	Density Number	35	Original Farm Acres	89.19
Density Study Date	5/23/2018	Original Splits	2.55	Available Density Unit(s)	3

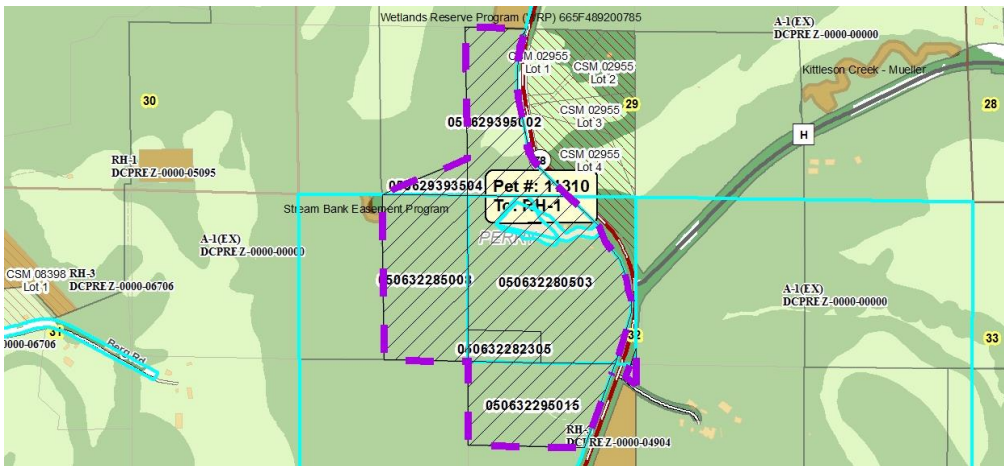

Reasons/Notes:

Homesites created to date:
NONE

New development should avoid resource protection corridors.

Note: Parcels included in the density study reflect farm ownership and acreage as of the date of town plan adoption, or other date specified. Density study is based on the original farm acreage, NOT acreage currently owned.

Parcel #	Acres	Owner Name	CSM
050632285008	20.32	BRADY C GOMEZ	
050632280503	32.09	BRADY C GOMEZ	
050629395002	14.97	BRADY C GOMEZ	
050629393504	2.3	BRADY C GOMEZ	
050632295015	16.18	CHRYSALIS BIOSCIENCES CORPORATION	
050632282305	3.33	CHRYSALIS BIOSCIENCES CORPORATION	