

DRAFT: FOR DISCUSSION PURPOSES ONLY

IMPORTANT NOTE: ACREAGE VALUES AND OWNERSHIP HEREIN ARE DERIVED FROM HISTORICAL AND CURRENT RECORDS LOCATED AT THE DANE COUNTY DEPARTMENT OF PLANNING AND DEVELOPMENT (EG. GIS, PLAT BOOKS, ZONING PERMIT DATA, CSM'S, ETC). DENSITY POLICIES VARY AMONG TOWNS AND MAY REQUIRE INTERPRETATION.

Public Hearing Date 7/22/2014		Petition Number 10719		Applicant: Donald Pauli	
Town	Montrose	A-1EX Adoption	9/11/1978	Orig Farm Owner	Pauli, Donald
Section:	09	Density Number	35	Original Farm Acres	142.88
Density Study Date	7/22/2014	Original Splits	4.08	Available Density Unit(s)	3

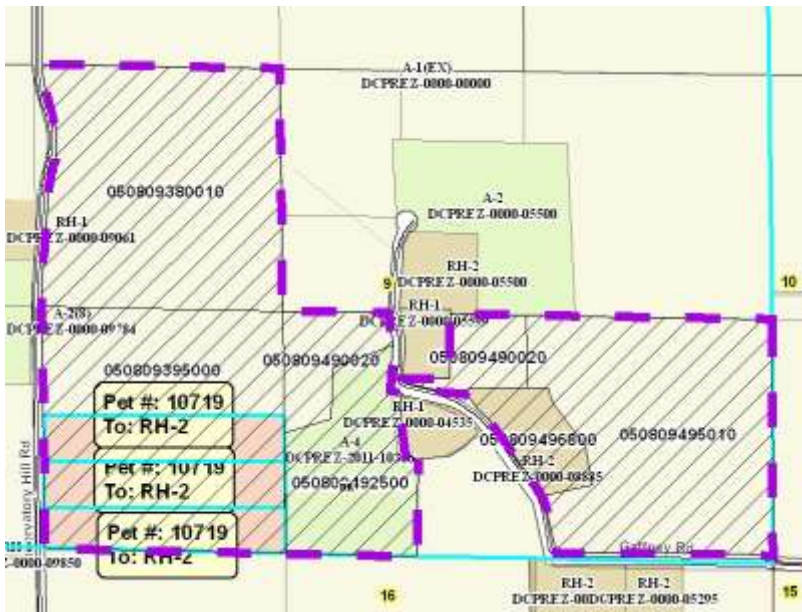

Reasons/Notes:

Homesites created to date: ONE (CSM 11048). CSM 13233 is deed restricted to ag use only and does not count as a split. If approved, Petition 10719 would exhaust the splits allocated to this property under the town/county plan.

Note: Parcels included in the density study reflect farm ownership and acreage as of the date of town plan adoption, or other date specified. Density study is based on the original farm acreage, NOT acreage currently owned.

Parcel #	Acres	Owner Name	CSM
050809496800	5.16	BRADLEY KRAMER & RUTH E KRAMER	11048
050809492500	14.37	JOHN K SHAW & JENNIFER R SIEVERT	13233
050809495010	35.28	PAULI REV LIVING TR, DONALD F & MARIE M	
050809490020	9.75	PAULI REV LIVING TR, DONALD F & MARIE M	
050809395000	39.78	PAULI REV LIVING TR, DONALD F & MARIE M	
050809380010	38.53	PAULI REV LIVING TR, DONALD F & MARIE M	