

DRAFT: FOR DISCUSSION PURPOSES ONLY

IMPORTANT NOTE: ACREAGE VALUES AND OWNERSHIP HEREIN ARE DERIVED FROM HISTORICAL AND CURRENT RECORDS LOCATED AT THE DANE COUNTY DEPARTMENT OF PLANNING AND DEVELOPMENT (EG. GIS, PLAT BOOKS, ZONING PERMIT DATA, CSM'S, ETC). DENSITY POLICIES VARY AMONG TOWNS AND MAY REQUIRE INTERPRETATION.

Public Hearing Date	2/25/2020	Petition Number	11515	Applicant:	Tom and Linda Holmes
Town	Oregon	A-1EX Adoption	1/5/1995	Orig Farm Owner	Edwin & Mildred Christensen
Section:	06	Density Number	35	Original Farm Acres	97.19
Density Study Date	7/20/2015	Original Splits	2.78	Available Density Unit(s)	3

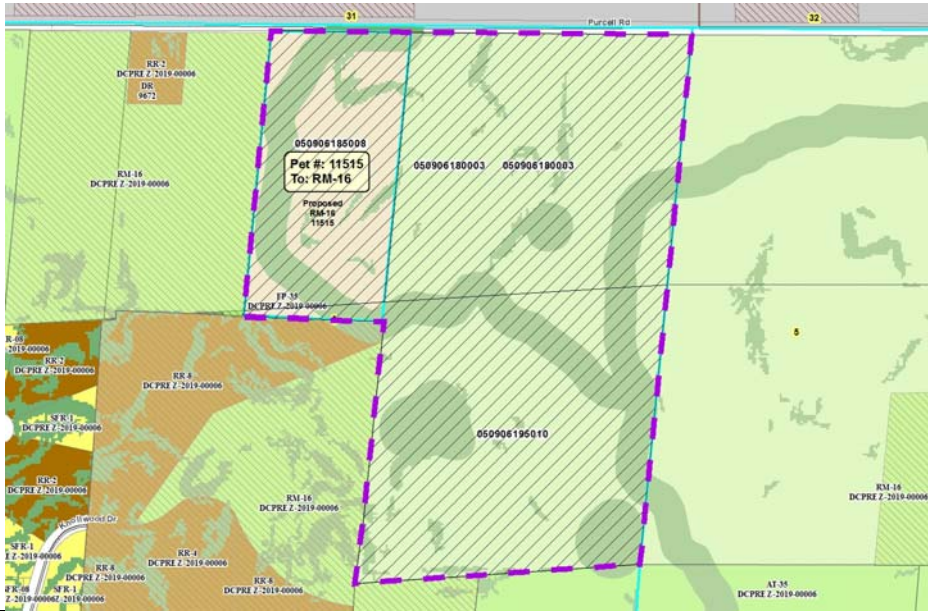

Reasons/Notes:

Homesites created to date:
 NONE
 NOTE: Separation of existing residence would not count against town density policy. New development should avoid resource protection corridors.

Note: Parcels included in the density study reflect farm ownership and acreage as of the date of town plan adoption, or other date specified. Density study is based on the original farm acreage, NOT acreage currently owned.

Parcel #	Acres	Owner Name	CSM
050906195010	40.67	ANCHOR-T RANCH LLC	
050906185008	19.46	ANCHOR-T RANCH LLC	
050906180003	37.07	ANCHOR-T RANCH LLC	