

# Dane County Rezone & Conditional Use Permit

Application Date	Petition Number
05/16/2016	DCPREZ-2016-11006
Public Hearing Date	C.U.P. Number
07/26/2016	

OWNER INFORMATION		AGENT INFORMATION	
OWNER NAME WAYNE S WEBER	PHONE (with Area Code) (608) 225-5205	AGENT NAME	PHONE (with Area Code)
BILLING ADDRESS (Number & Street) 2821 PRAIRIE CIR		ADDRESS (Number & Street)	
(City, State, Zip) VERONA, WI 53593		(City, State, Zip)	
E-MAIL ADDRESS wweber@edgeone.com		E-MAIL ADDRESS	

ADDRESS/LOCATION 1		ADDRESS/LOCATION 2		ADDRESS/LOCATION 3	
ADDRESS OR LOCATION OF REZONE/CUP		ADDRESS OR LOCATION OF REZONE/CUP		ADDRESS OR LOCATION OF REZONE/CUP	
2821 Prairie Circle					
TOWNSHIP VERONA	SECTION 7	TOWNSHIP	SECTION	TOWNSHIP	SECTION
PARCEL NUMBERS INVOLVED		PARCEL NUMBERS INVOLVED		PARCEL NUMBERS INVOLVED	
0608-074-8512-0					

REASON FOR REZONE			CUP DESCRIPTION	
CREATING TWO RESIDENTIAL LOTS				
FROM DISTRICT:	TO DISTRICT:	ACRES	DANE COUNTY CODE OF ORDINANCE SECTION	ACRES
RH-2 Rural Homes District	RH-1 Rural Homes District	2.75		
RH-2 Rural Homes District	RH-1 Rural Homes District	2.5		

C.S.M REQUIRED? <input checked="" type="checkbox"/> Yes <input type="checkbox"/> No Applicant Initials _____	PLAT REQUIRED? <input type="checkbox"/> Yes <input checked="" type="checkbox"/> No Applicant Initials _____	DEED RESTRICTION REQUIRED? <input type="checkbox"/> Yes <input type="checkbox"/> No Applicant Initials _____	INSPECTOR'S INITIALS  SCW1	SIGNATURE:(Owner or Agent) 
				PRINT NAME: Wayne Weber
				DATE: 5/20/16



DANE COUNTY  
PLANNING & DEVELOPMENT

#306

Zoning Division  
Room 116, City-County Building  
210 Martin Luther King Jr. Blvd.  
Madison, Wisconsin 53703-3342  
Phone: (608) 266-4266  
Fax: (608) 267-1540

11006

Zoning Change Application

Items that must be submitted with your application:

- o Written Legal Description of the proposed Zoning Boundaries  
Legal description of the land that is proposed to be changed. The description may be a lot in a plat, Certified Survey Map, or an exact metes and bounds description. A separate legal description is required for each zoning district proposed. The description shall include the area in acres or square feet.
- o Scaled Drawing of the location of the proposed Zoning Boundaries  
The drawing shall include the existing and proposed zoning boundaries of the property. All existing buildings shall be shown on the drawing. The drawing shall include the area in acres or square feet.

Owner's Name WAYNE Weber/Tammy Heydle Agent's Name \_\_\_\_\_  
 Address 2821 Prairie Cir. Verona Address 53593  
 Phone 608-225-5205 Phone \_\_\_\_\_  
 Email WWeber@edgeone.com Email \_\_\_\_\_  
TammyHeydle@hotmail.com Email \_\_\_\_\_

Town: Verona Parcel numbers affected: 062/0.608-074-8512-0

Section: 01 Property address or location: 2821 Prairie Cir Verona WI

Zoning District change: (To / From / # of acres) RH2 to RH1 Split 5.25 acres  
to 2 (TWO) Lots 2.75 acres and 2.5 acres

Soil classifications of area (percentages) Class I soils: \_\_\_\_\_% Class II soils: \_\_\_\_\_% Other: \_\_\_\_\_%

Narrative: (reason for change, intended land use, size of farm, time schedule)

Separation of buildings from farmland

Creation of a residential lot

Compliance for existing structures and/or land uses

Other:

\_\_\_\_\_

\_\_\_\_\_

\_\_\_\_\_

\_\_\_\_\_

\_\_\_\_\_

I authorize that I am the owner or have permission to act on behalf of the owner of the property.  
Submitted By: Wayne Weber

Date: 5/14/16



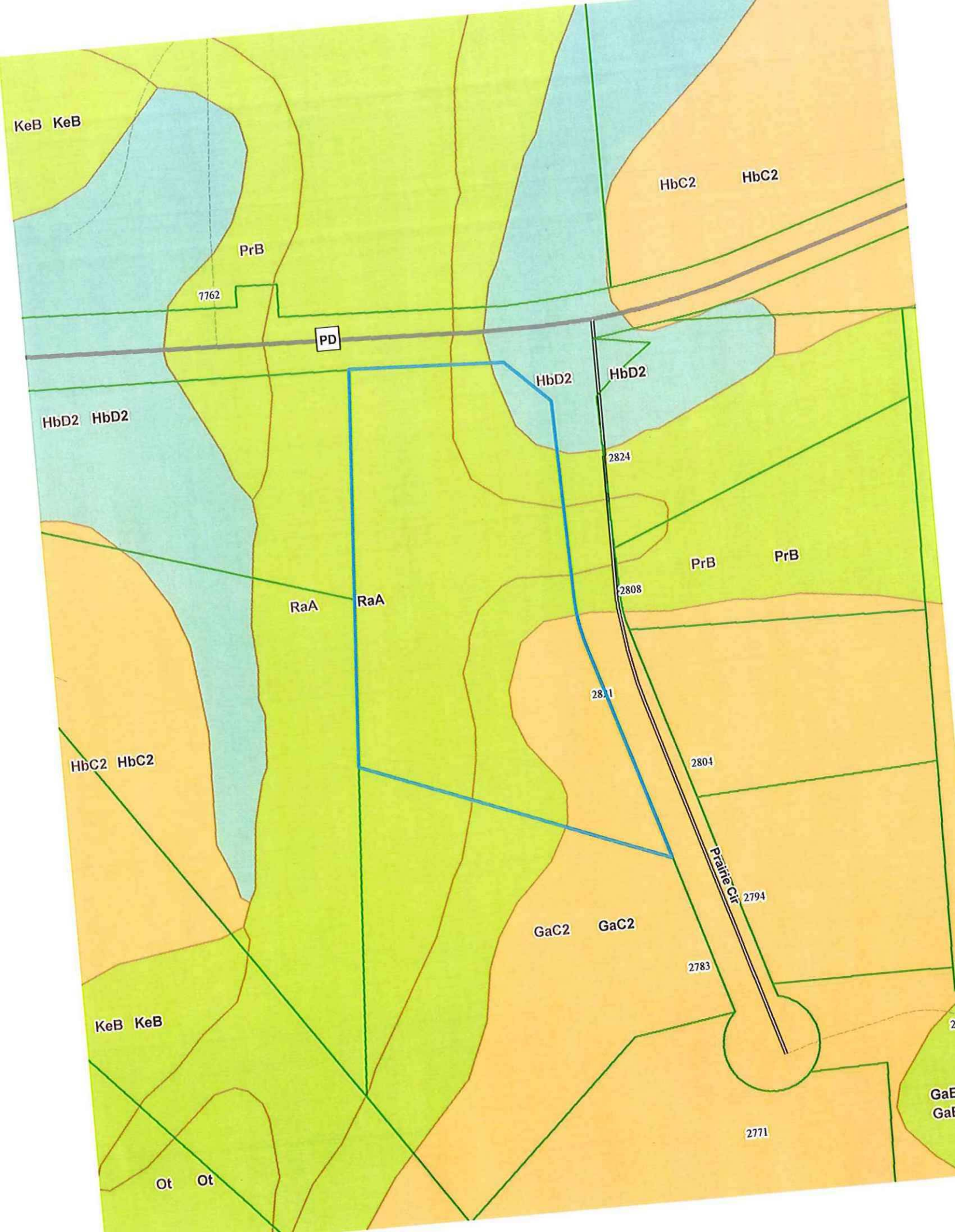



**LEGAL DESCRIPTIONS FOR REZONING**

**DELAYED EFFECTIVE DATE REQUESTED.**

**ZONE FROM RH-2 TO RH-1**

**Wayne Weber  
2821 Prairie Circle  
Verona, WI 53593**

**LOT 1**

Part of Lot 2, Certified Survey Map No. 9599, being located in the SE ¼ of Section 7, T6N, R8E, Town of Verona, Dane County, Wisconsin, being further described as follows:

Commencing at the West ¼ corner of said Section 7; thence S88°38'16"E 3426.66 feet along the east-west ¼ line; thence S2°48'39"W 50.01 feet to the northwest corner of said Lot 2, said point also being the point of beginning.

Thence S88°38'16"E 254.70 feet; thence S46°34'36"E 88.70 feet; thence S00°48'00"E 279.18 feet; thence S86°27'15"W 341.64 feet; thence N02°48'39"E 367.75 feet to the point of beginning. Contains 2.626 acres.

**LOT 2**

Part of Lot 2, Certified Survey Map No. 9599, being located in the SE ¼ of Section 7, T6N, R8E, Town of Verona, Dane County, Wisconsin, being further described as follows:

Commencing at the West ¼ corner of said Section 7; thence S88°38'16"E 3426.66 feet along the east-west ¼ line; thence S02°48'39"W 417.76 feet to the point of beginning.

Thence N86°27'15"E 341.64 feet; thence 78.21 feet along the arc of a curve concaved easterly, having a radius of 283.00 feet and a long chord bearing S08°43'00"E 77.96 feet; thence S16°38'00"E 330.24 feet; thence N70°04'42"W 486.59 feet; thence N02°48'39"E 206.80 feet to the point of beginning. Contains 2.625 acres.