

QUARRY VISTA

ALL OF LOTS 1-3, CERTIFIED SURVEY MAP NUMBER 11159, AS RECORDED IN VOLUME 67 OF CERTIFIED SURVEY MAPS, ON PAGES 152-154, AS DOCUMENT NUMBER 3959694, DANE COUNTY REGISTRY, ALL OF CERTIFIED SURVEY MAP NUMBER 61, AS RECORDED IN VOLUME 1 OF CERTIFIED SURVEY MAPS, ON PAGE 61, AS DOCUMENT NUMBER 1031106, DANE COUNTY REGISTRY, ALSO PART OF THE NORTHEAST, SOUTHEAST AND SOUTHWEST QUARTERS OF SECTION 07, ALSO PART OF THE NORTHWEST AND NORTHEAST QUARTERS OF THE NORTHWEST QUARTER OF SECTION 18, ALL IN TOWNSHIP 06 NORTH, RANGE 09 EAST, CITY OF FITCHBURG, DANE COUNTY, WISCONSIN.

751.75' TO COMPUTED CENTER OF SECTION 07. ACTUAL CENTER OF SECTION FALLS IN WORKING QUARRY

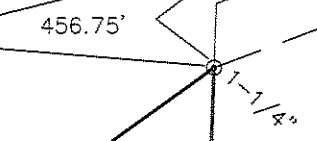

EXISTING ZONING DETAIL

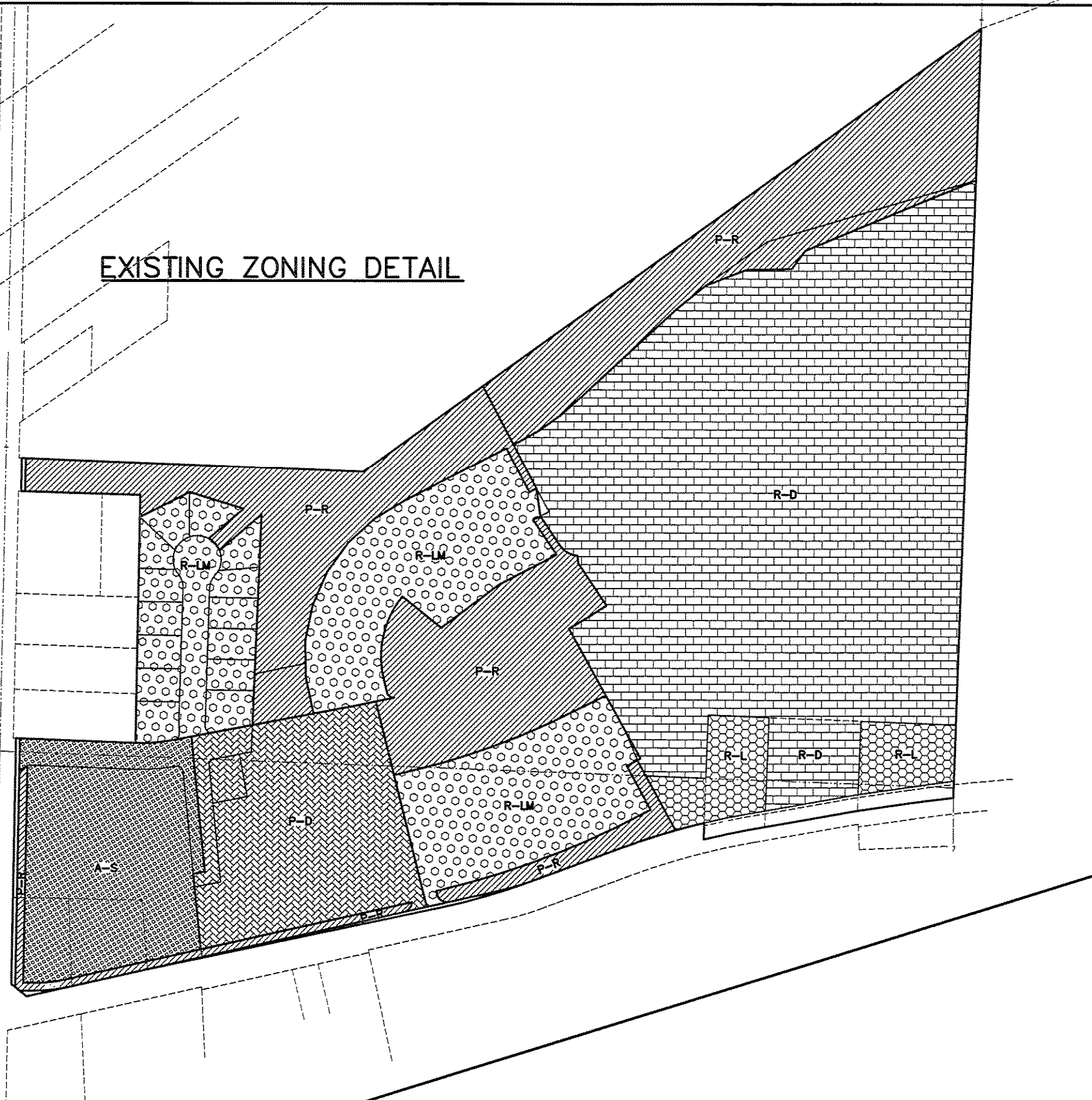

GRID NORTH BEARS ARE REFERENCED TO THE WISCONSIN COMMONS SYSTEM (DANE ZONE) WEST LINE OF THE SOUTHWEST QUARTER OF SECTION 07-06-09 BEARS NOT TO SCALE

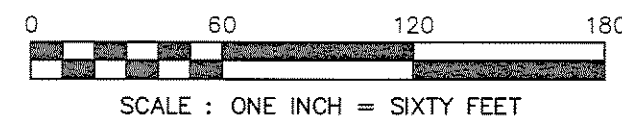

There are no objections to this plat with respect to Secs. 236.15, 236.16, 236.20 and 236.21(1) and (2), Wis Stats. as provided by s. 236.12, Wis. Stats.

Certified _____, 20__

Department of Administration

F. E. M. 4. 6. 2

OUTLOT 1

"DEDICATED TO THE CITY OF FITCHBURG FOR PARK/DRAINAGE/TRAIL/ENVIRONMENTAL CORRIDOR"

OUTLOT 2

"PRIVATE, RESERVED FOR FUTURE USE"

EXISTING ENVIRONMENTAL CORRIDOR

EXISTING QUARRY FLOOR

(N 53°41'02" E 1901.22')
(N 5°05'00" E 1804.16')

(N 54°13'37" E 188.34')

(S 01°55'05" W 1910.74')

(N 45°25'15" E 318.00')

(N 47°25'50" E 74.87')

(N 62°28'47" E 286.29')

(S 27°31'37" E 123.00')

EAST LINE OF THE SOUTHWEST QUARTER OF SECTION 07-06-09

(S 01°55'05" W 1910.74')

1511.99'

381.70'

LOT 2
C.S.M. 110.2.1

LANDS

NOTES:

- 1) See sheet 5 for Notes, Curve Table and Lot Area Table.
- 2) See sheet 4 for legend.

SURVEYED BY:

Burse
surveying & engineering inc.
2801 International Lane, Suite 101
Madison, WI 53704 608.250.9263
Fax: 608.250.9266
email: mburse@bse-inc.net
www.bursesurveyengr.com



Revised: 04-07-2015 MMB

SEE SHEET 1 FOR PLAT CONTINUATION

SEE SHEET 4 FOR PLAT CONTINUATION