

STRANG

ARCHITECTURE
ENGINEERING
INTERIOR DESIGN

MADISON, WI | WAUKESHA, WI



ENGINEERING | ARCHITECTURE | SURVEYING
FUNDING | PLANNING | ENVIRONMENTAL
3702 Parkview St Madison, WI 53704
(608) 242-7779 www.msa-ps.com
© MSA Professional Services, Inc.

BUILDING AREA KEY PLAN

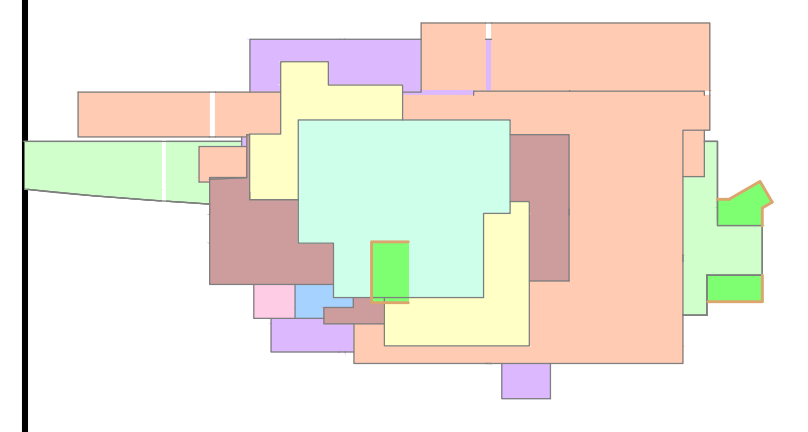

COMPLEX BUILDING KEY PLAN

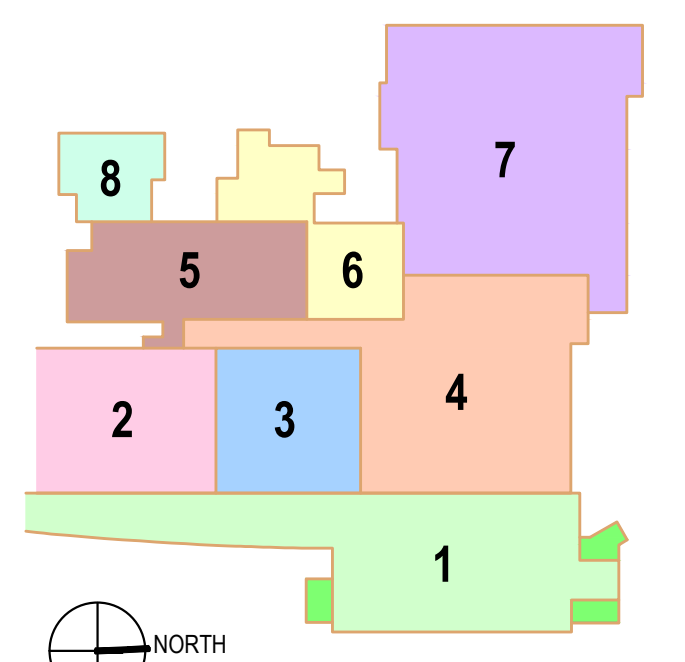

REVISIONS		
No.	DESCRIPTION	DATE

**CD SET
EARLY START PERMIT
DESIGN PACKAGE 1A**

COPYRIGHT STRANG, INC.	2024
DRAWING SET	EARLY START PERMIT DP 1A
DATE	03/20/2024
PROJECT NO.	2023159
PROJECT TITLE	

LABCORP - CELL AND GENE THERAPY EXPANSION

3301 KINSMAN BOULEVARD
MADISON, WI 53704

SHEET NAME
HEIGHT VARIANCE EXHIBIT

SHEET NO.
C201

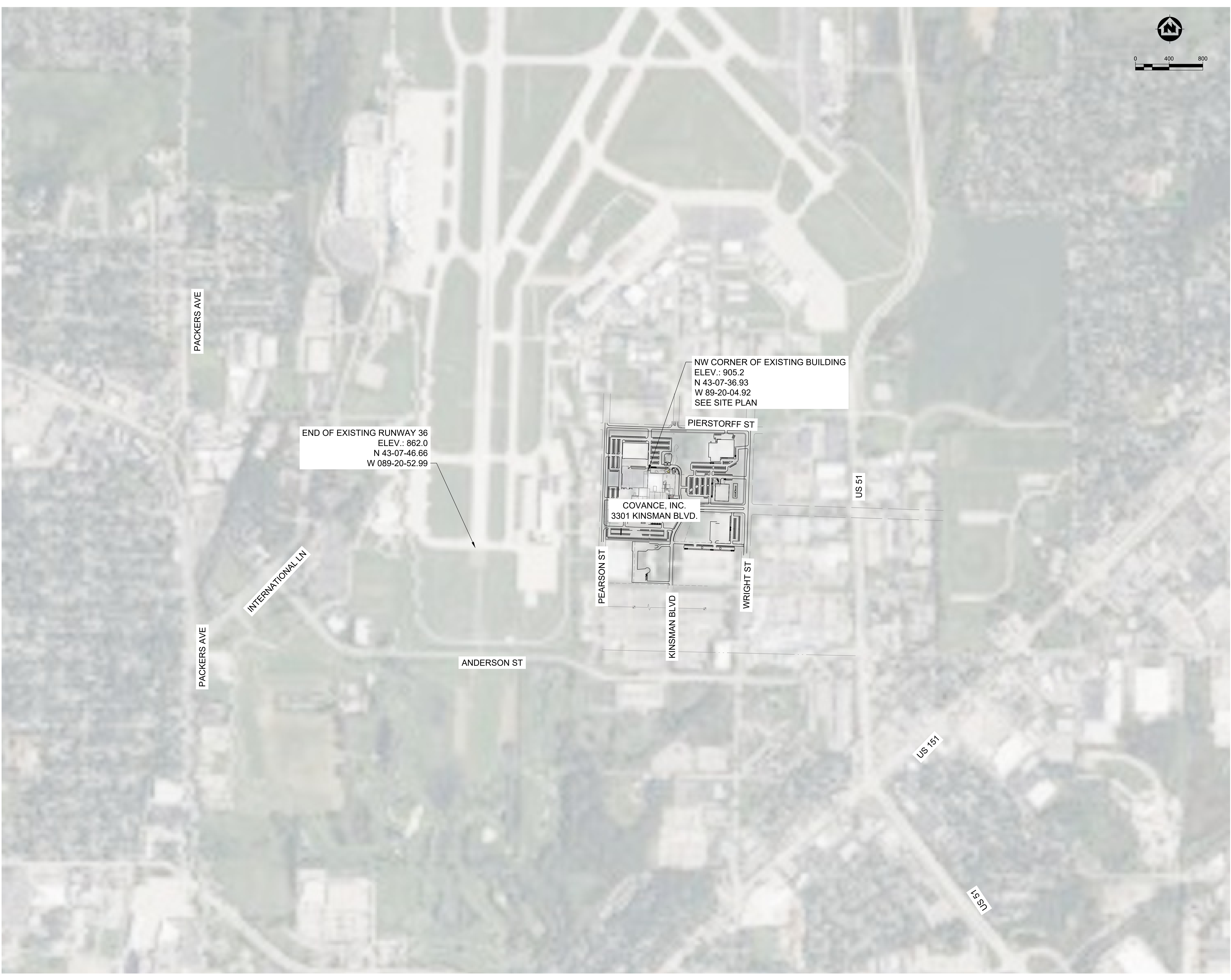

PACKERS AVE

PACKERS AVE

INTERNATIONAL LN

END OF EXISTING RUNWAY 36
ELEV.: 862.0
N 43-07-46.66
W 089-20-52.99

ANDERSON ST

PEARSON ST

KINSMAN BLVD

WRIGHT ST

NW CORNER OF EXISTING BUILDING
ELEV.: 905.2
N 43-07-36.93
W 89-20-04.92
SEE SITE PLAN

PIERSTORFF ST

COVANCE, INC.
3301 KINSMAN BLVD.

US 51

US 151

US 51

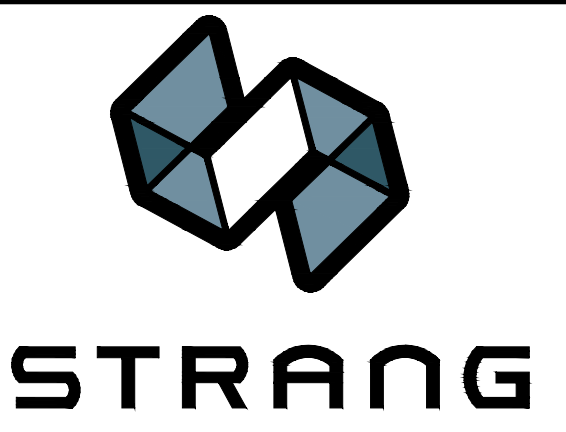
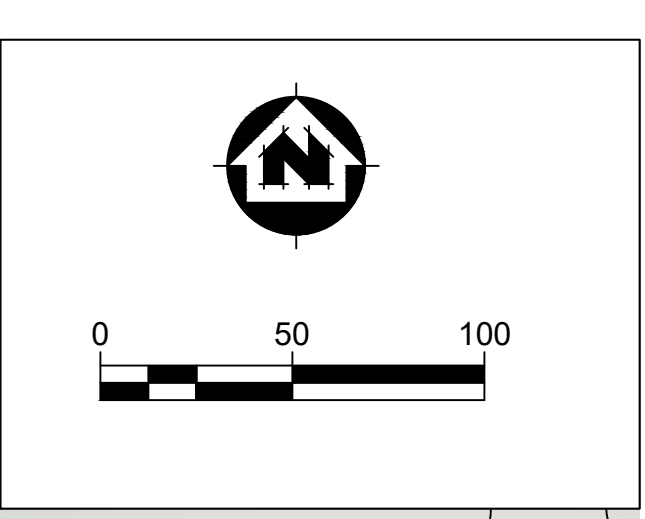
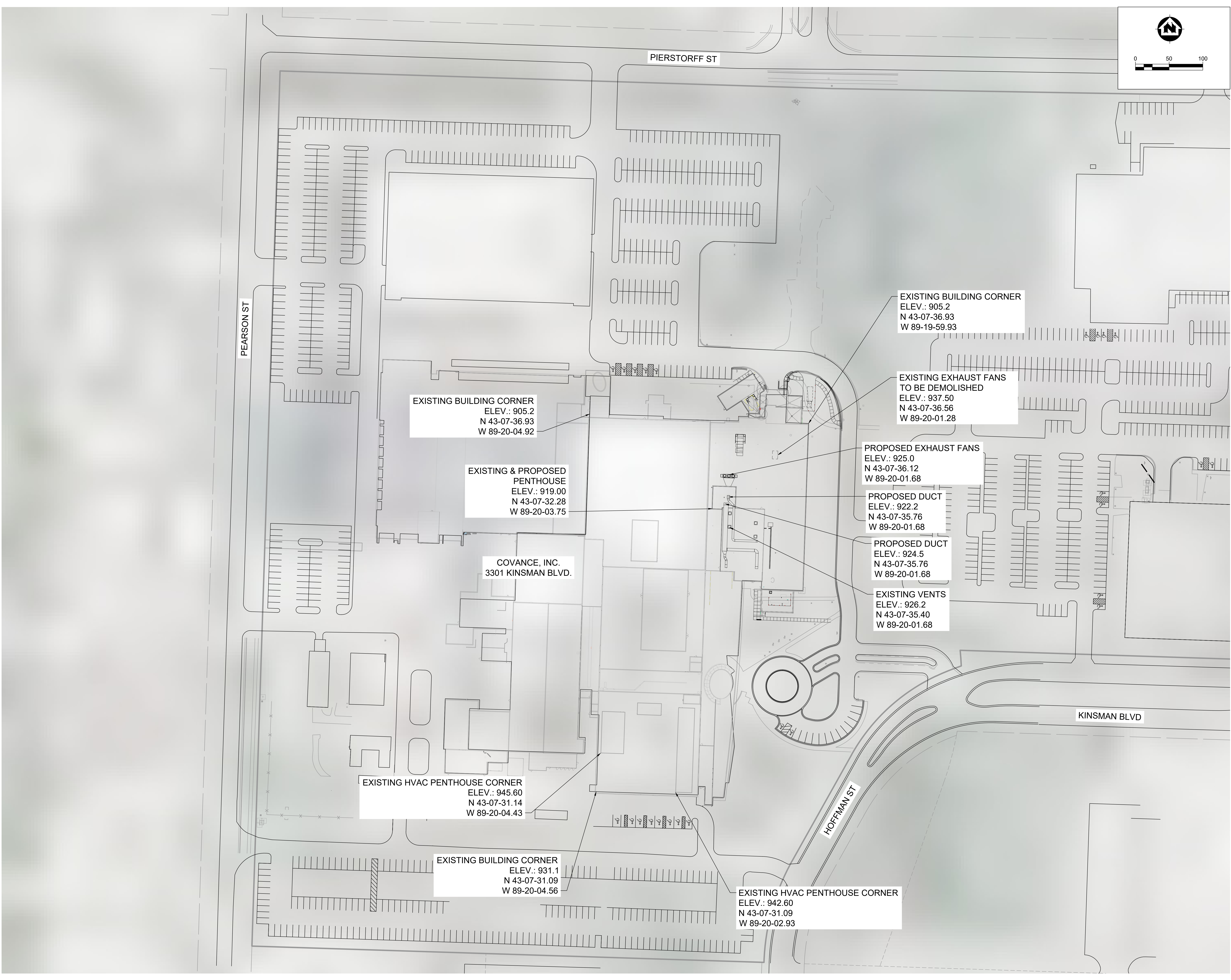

ARCHITECTURE
ENGINEERING
INTERIOR DESIGN

MADISON, WI | WAUKESHA, WI



ENGINEERING | ARCHITECTURE | SURVEYING
FUNDING | PLANNING | ENVIRONMENTAL
1702 Parkview St Madison, WI 53704
(608) 242-7779 www.msa-ps.com
© MSA Professional Services, Inc.

BUILDING AREA KEY PLAN

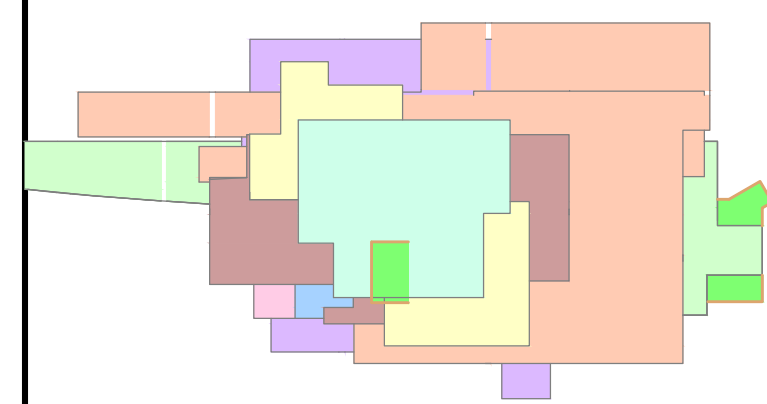

COMPLEX BUILDING KEY PLAN

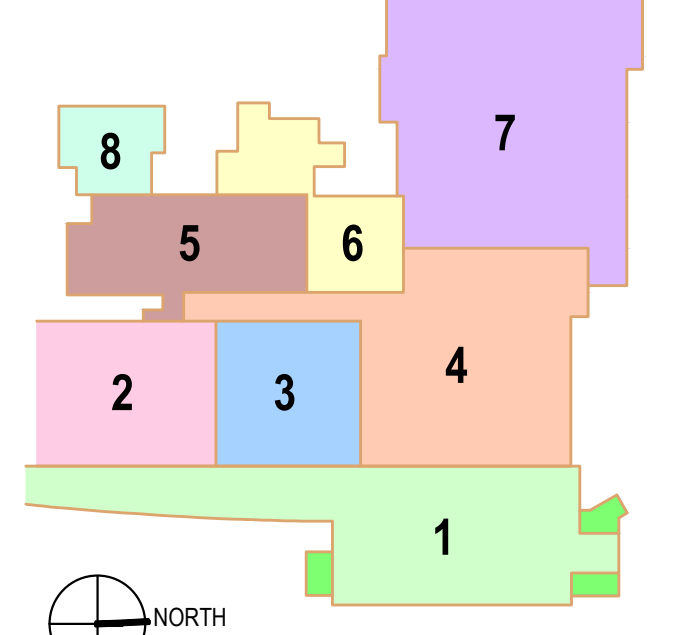

REVISIONS		
No.	DESCRIPTION	DATE

**CD SET
EARLY START PERMIT
DESIGN PACKAGE 1A**

COPYRIGHT STRANG, INC. 2024

DRAWING SET EARLY START PERMIT DP 1A

DATE 03/20/2024

PROJECT NO. 2023159

PROJECT TITLE

**LABCORP - CELL AND
GENE THERAPY
EXPANSION**

3301 KINSMAN BOULEVARD
MADISON, WI 53704

SHEET NAME
**HEIGHT VARIANCE
EXHIBIT**

SHEET NO.

C201