

# DRAFT: FOR DISCUSSION PURPOSES ONLY

IMPORTANT NOTE: ACREAGE VALUES AND OWNERSHIP HEREIN ARE DERIVED FROM HISTORICAL AND CURRENT RECORDS LOCATED AT THE DANE COUNTY DEPARTMENT OF PLANNING AND DEVELOPMENT (EG. GIS, PLAT BOOKS, ZONING PERMIT DATA, CSM'S, ETC). DENSITY POLICIES VARY AMONG TOWNS AND MAY REQUIRE INTERPRETATION.

<b>Public Hearing Date</b>	10/22/2019	<b>Petition Number</b>	11480	<b>Applicant:</b>	MEINHOLZ LIVING TR
<b>Town</b>	Black Earth	<b>A-1EX Adoption</b>	8/15/1981	<b>Orig Farm Owner</b>	Kelter, Lee
<b>Section:</b>	22, 23	<b>Density Number</b>	35	<b>Original Farm Acres</b>	125.87
<b>Density Study Date</b>	10/22/2019	<b>Original Splits</b>	3.6	<b>Available Density Unit(s)</b>	1

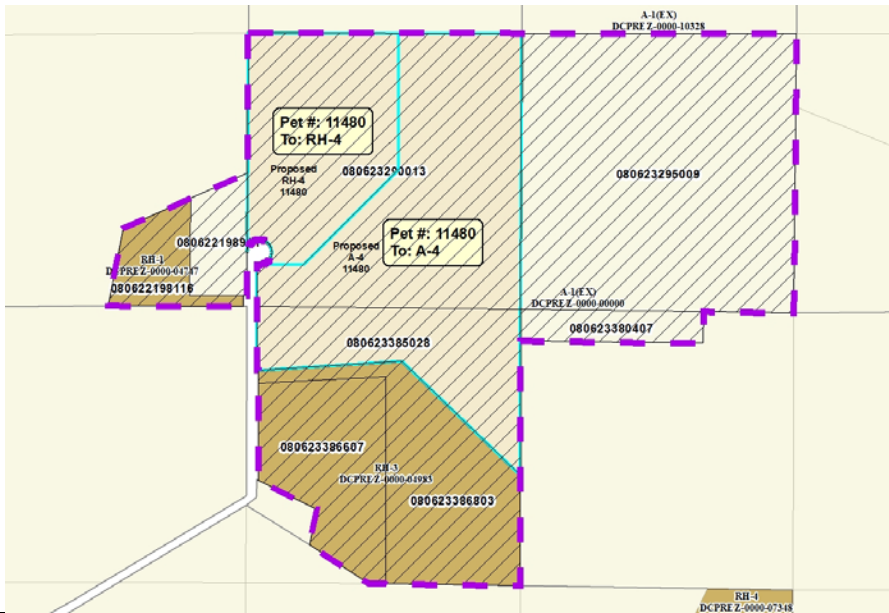

**Reasons/Notes:**

Town Policy: round up splits.  
 3.6 = 4 Total splits.  
 [-2] CSM 06455  
 [-1] CSM 06177  
 [0] Original Farm home on PIN 08062219801  
 [1] remaining split proposal would use the final split.

Note: Parcels included in the density study reflect farm ownership and acreage as of the date of town plan adoption, or other date specified. Density study is based on the original farm acreage, NOT acreage currently owned.

Parcel #	Acres	Owner Name	CSM
080623386607	10.66	CHARLES A BRUHN & CONNIE M BRUHN	06455
080623380407	3.07	GERALD G WENDT & JACQUELINE A WENDT	
080623295009	40.54	GERALD G WENDT & JACQUELINE A WENDT	
080622198116	3.93	JEFF S ELISOFFER & DEBRA J ELISOFFER	06177
080623386803	13.36	JEFFREY L BRANAN	06455
080623385028	11.47	MEINHOLZ LIVING TR	
080623290013	39.5	MEINHOLZ LIVING TR	
080622198901	3.34	TREVOR LAUFENBERG	