

DRAFT: FOR DISCUSSION PURPOSES ONLY

IMPORTANT NOTE: ACREAGE VALUES AND OWNERSHIP HEREIN ARE DERIVED FROM HISTORICAL AND CURRENT RECORDS LOCATED AT THE DANE COUNTY DEPARTMENT OF PLANNING AND DEVELOPMENT (EG. GIS, PLAT BOOKS, ZONING PERMIT DATA, CSM'S, ETC). DENSITY POLICIES VARY AMONG TOWNS AND MAY REQUIRE INTERPRETATION.

Public Hearing Date	3/26/2024	Petition Number	12017	Applicant:	PLYMOUTH STONE LLC
Town	Springdale	A-1EX Adoption		Orig Farm Owner	Robert Kallath
Section:	35	Density Number	17	Original Farm Acres	34.76
Density Study Date	1/31/2024	Original Splits	2.04	Available Density Unit(s)	3

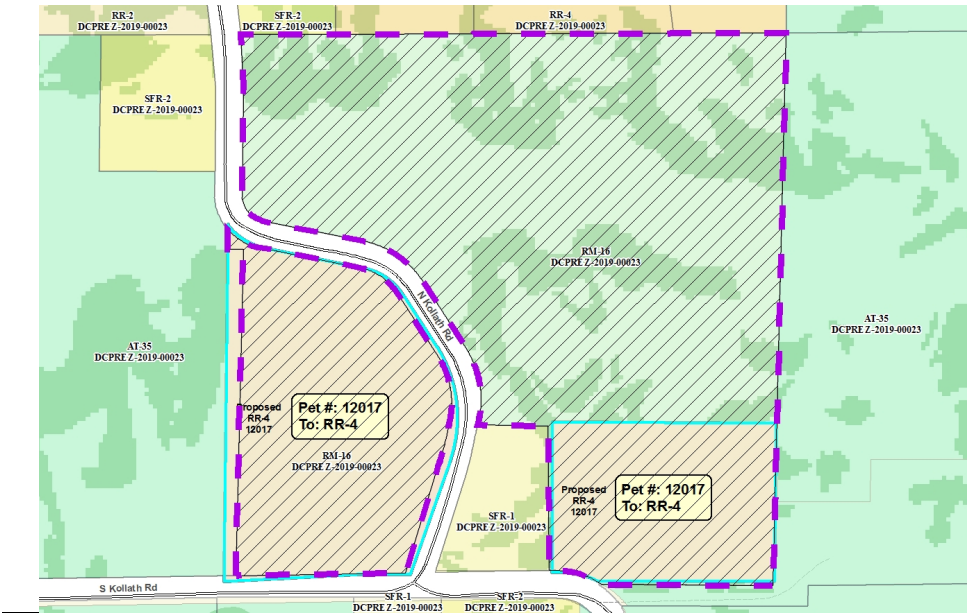

Reasons/Notes:

Development qualifies for Density Option 2 (1:17 acres) under town/county plan. Springdale allows for 1 additional homesite for owner of remainder of property. If Petition 12017 is approved, this will exhaust the development potential of the property.

Note: Parcels included in the density study reflect farm ownership and acreage as of the date of town plan adoption, or other date specified. Density study is based on the original farm acreage, NOT acreage currently owned.

Parcel #	Acres	Owner Name	CSM
060735180010	34.76	PLYMOUTH STONE LLC	