

DRAFT: FOR DISCUSSION PURPOSES ONLY

IMPORTANT NOTE: ACREAGE VALUES AND OWNERSHIP HEREIN ARE DERIVED FROM HISTORICAL AND CURRENT RECORDS LOCATED AT THE DANE COUNTY DEPARTMENT OF PLANNING AND DEVELOPMENT (EG. GIS, PLAT BOOKS, ZONING PERMIT DATA, CSM'S, ETC). DENSITY POLICIES VARY AMONG TOWNS AND MAY REQUIRE INTERPRETATION.

Applicant: Schmidt Farm Trust

Town	Vienna	A-1EX Adoption	1/1/1984	Orig Farm Owner	Schmidt, Thomas C.
Section:	33	Density Number	75	Original Farm Acres	216.14
Density Study Date	8/16/2023	Original Splits	2.88	Available Density Unit(s)	2

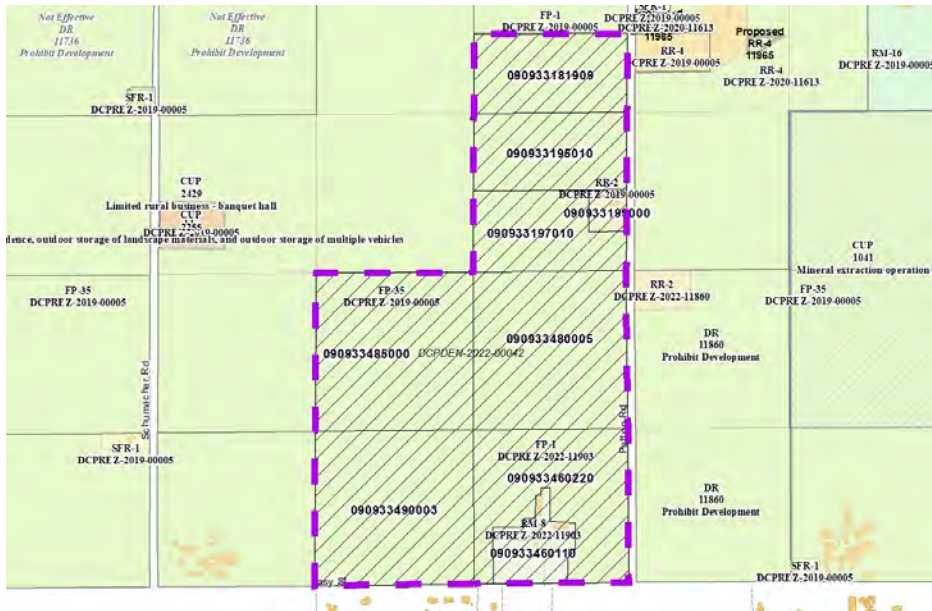

Reasons/Notes:

[2] Original Splits.
None taken to date, by Town rules and policies.
Landowners need minimum 75 acres to be eligible to claim splits per the Town rules.

Note: Parcels included in the density study reflect farm ownership and acreage as of the date of town plan adoption, or other date specified. Density study is based on the original farm acreage, NOT acreage currently owned.

Parcel #	Acres	Owner Name	CSM
090933460220	30.12	DD ACRES LLC	16186
090933490003	39.46	KIG PROPERTIES LLC	
090933485000	40.25	KIG PROPERTIES LLC	
090933480005	39.2	KIG PROPERTIES LLC	
090933197010	17.45	KIG PROPERTIES LLC	
090933460110	8.32	MAIER LIVING TR, PATRICK & COURTNEY	16186
090933199000	2.55	SARA A KRABbenhOFT & JOSEPH K KRABbenhOFT	09556
090933195010	19.13	SCHMIDT FARM TR	
090933181909	19.58	SCHMIDT FARM TR	