

DRAFT: FOR DISCUSSION PURPOSES ONLY

IMPORTANT NOTE: ACREAGE VALUES AND OWNERSHIP HEREIN ARE DERIVED FROM HISTORICAL AND CURRENT RECORDS LOCATED AT THE DANE COUNTY DEPARTMENT OF PLANNING AND DEVELOPMENT (EG. GIS, PLAT BOOKS, ZONING PERMIT DATA, CSM'S, ETC). DENSITY POLICIES VARY AMONG TOWNS AND MAY REQUIRE INTERPRETATION.

Public Hearing Date	12/20/2023	Petition Number	11996	Applicant:	ROEHRIG BROTHERS LLC
Town	Primrose	A-1EX Adoption	12/16/1985	Orig Farm Owner	Yaun, Arnold
Section:	32	Density Number	35	Original Farm Acres	152.56
Density Study Date	12/5/2023	Original Splits	4.36	Available Density Unit(s)	2

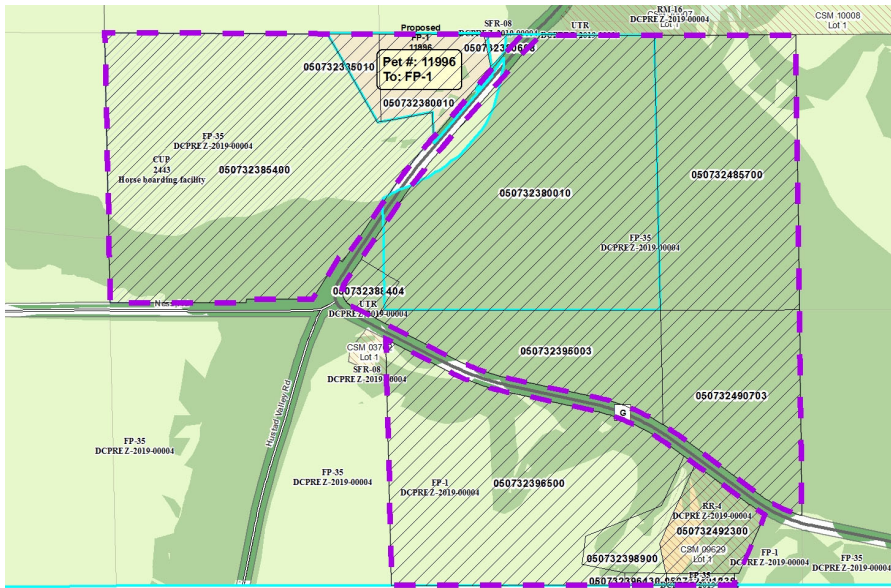

Reasons/Notes:

Homesites created to date: 2 per: CSM 9629 & SFR-08 zoning on PIN 050732380608, Owners of 35 acres or more should record agreement on allocation of remaining homesites. Development should avoid resource protection corridors.

Note: Parcels included in the density study reflect farm ownership and acreage as of the date of town plan adoption, or other date specified. Density study is based on the original farm acreage, NOT acreage currently owned.

Parcel #	Acres	Owner Name	CSM
050732492300	3.94	ALFRED O ANDERSON & CHRISTOPHER R HAGEMAN	09629
050732398900	2.55	CHRISTOPHER R HAGEMAN & BARBARA I PLUS	
050732396500	26.07	CHRISTOPHER R HAGEMAN & BARBARA I PLUS	
050732388404	1.03	DANE COUNTY	
050732380608	0.35	PHILLIP A LEHMAN	
050732491830	0.43	RICHARD A YAUN & BEVERLY S YAUN	
050732396430	0.27	RICHARD A YAUN & BEVERLY S YAUN	
050732490703	12.01	ROEHRIG BROTHERS LLC	
050732485700	20.49	ROEHRIG BROTHERS LLC	
050732395003	9.92	ROEHRIG BROTHERS LLC	

Note: Parcels included in the density study reflect farm ownership and acreage as of the date of town plan adoption, or other date specified. Density study is based on the original farm acreage, NOT acreage currently owned.

050732385010	1.3	ROEHRIG BROTHERS LLC
050732380010	36.91	ROEHRIG BROTHERS LLC
050732385400	37.28	TROY J KNAPP & JAMES R MANSHARDT