

DRAFT: FOR DISCUSSION PURPOSES ONLY

IMPORTANT NOTE: ACREAGE VALUES AND OWNERSHIP HEREIN ARE DERIVED FROM HISTORICAL AND CURRENT RECORDS LOCATED AT THE DANE COUNTY DEPARTMENT OF PLANNING AND DEVELOPMENT (EG. GIS, PLAT BOOKS, ZONING PERMIT DATA, CSM'S, ETC). DENSITY POLICIES VARY AMONG TOWNS AND MAY REQUIRE INTERPRETATION.

| | | | | | |
|--------------------------------------|-----------|------------------------------|-----------|------------------------------------|-------------|
| Public Hearing Date 9/20/2022 | | Petition Number 11872 | | Applicant: PLENDL LIVING TR | |
| Town | Mazomanie | A-1EX Adoption | 3/29/1979 | Orig Farm Owner | Dale Bender |
| Section: | 01 | Density Number | 40 | Original Farm Acres | 181.47 |
| | 36 | Original Splits | 4.54 | Available Density Unit(s) | 0 |

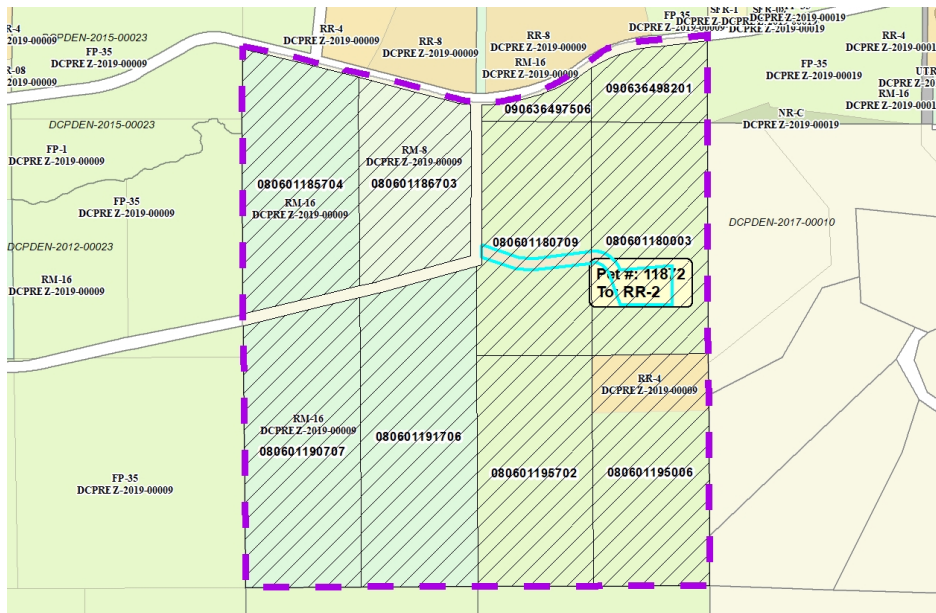

Reasons/Notes:

[5] original splits
 [-1] 080601190707
 [-1] 080601191706
 [-1] 080601195006
 [-1] 080601185704
 [-1] 080601186703
 There are no splits left on the property

Note: Parcels included in the density study reflect farm ownership and acreage as of the date of town plan adoption, or other date specified. Density study is based on the original farm acreage, NOT acreage currently owned.

| Parcel # | Acres | Owner Name | CSM |
|--------------|-------|--|-------|
| 080601190707 | 24.26 | DOUGLAS J SCHULTZ & CARMEN M M SCHULTZ | 05548 |
| 080601185704 | 20.86 | DOUGLAS J SCHULTZ & CARMEN M M SCHULTZ | 05548 |
| 080601191706 | 26.68 | LARRY L KAHLER & LENI M KAHLER | 05548 |
| 080601186703 | 15.16 | LARRY L KAHLER & LENI M KAHLER | 05548 |
| 090636498201 | 6.39 | PLENDL LIVING TR | |
| 090636497506 | 2.39 | PLENDL LIVING TR | |
| 080601195702 | 20.1 | PLENDL LIVING TR | |
| 080601195006 | 20.34 | PLENDL LIVING TR | |
| 080601180709 | 19.77 | PLENDL LIVING TR | |
| 080601180003 | 20.41 | PLENDL LIVING TR | |