

File: W:\2022\220716_Brumm - 4301 Hwy 101 Hwy 101\220716_DWG\Engineering Layout Site Plan User: adam Refined: Sep 16, 2022 - 8:46am

Building Set Back 15 ft

HC

Changes made by Zac Brumm
7-21-2023

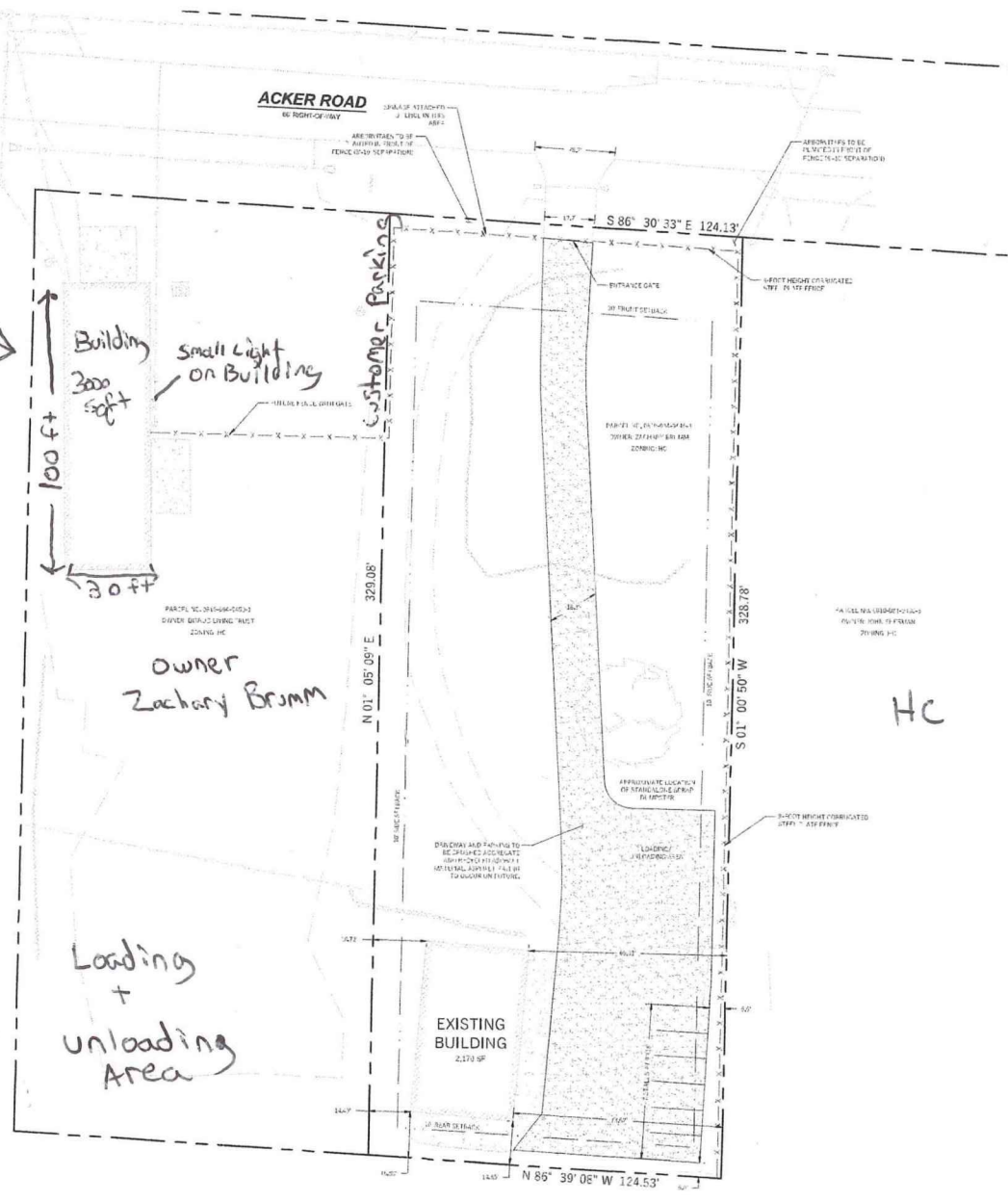

LEGEND (PROPOSED)

- PROPERTY PROPERTY BOUNDARY
- SETBACK LINES
- TRAVEL LANE/PARKING



GENERAL NOTES

1. THE DEVELOPER SHALL BE RESPONSIBLE FOR OBTAINING ALL NECESSARY PERMITS AND APPROVALS FROM THE TOWNSHIP AND COUNTY BEFORE COMMENCING CONSTRUCTION. THE DEVELOPER SHALL BE RESPONSIBLE FOR OBTAINING ALL NECESSARY PERMITS AND APPROVALS FROM THE TOWNSHIP AND COUNTY BEFORE COMMENCING CONSTRUCTION.
2. THE DEVELOPER SHALL BE RESPONSIBLE FOR OBTAINING ALL NECESSARY PERMITS AND APPROVALS FROM THE TOWNSHIP AND COUNTY BEFORE COMMENCING CONSTRUCTION.
3. THE DEVELOPER SHALL BE RESPONSIBLE FOR OBTAINING ALL NECESSARY PERMITS AND APPROVALS FROM THE TOWNSHIP AND COUNTY BEFORE COMMENCING CONSTRUCTION.
4. THE DEVELOPER SHALL BE RESPONSIBLE FOR OBTAINING ALL NECESSARY PERMITS AND APPROVALS FROM THE TOWNSHIP AND COUNTY BEFORE COMMENCING CONSTRUCTION.
5. THE DEVELOPER SHALL BE RESPONSIBLE FOR OBTAINING ALL NECESSARY PERMITS AND APPROVALS FROM THE TOWNSHIP AND COUNTY BEFORE COMMENCING CONSTRUCTION.
6. THE DEVELOPER SHALL BE RESPONSIBLE FOR OBTAINING ALL NECESSARY PERMITS AND APPROVALS FROM THE TOWNSHIP AND COUNTY BEFORE COMMENCING CONSTRUCTION.

SEE INFORMATION BLOCK

SEE INFORMATION BLOCK FOR:
 - PROPERTY INFORMATION
 - SETBACKS
 - ZONING
 - UTILITIES
 - ETC.

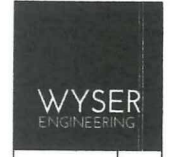

BRUMM PROPERTY DEVELOPMENT
 TOWN OF BURKE, DANE COUNTY, WI
 SHEET TITLE: SITE PLAN
 4301 ACKER ROAD
 MADISON, WI 53704

Revisions:		
No.	Date	Description

Graphic Scale: 0' 5' 10' 20' 30'

Wuser Number: 22-0910

Set Type: REVIEW

Date Issued: 09/16/2022

Sheet Number: C100

DIGGER OUTLINE
 Toll Free (800) 242-8511 or 811
 Home Based TDD (800) 542-8299
 www.DiggerOutline.com

HC