

DRAFT: FOR DISCUSSION PURPOSES ONLY

IMPORTANT NOTE: ACREAGE VALUES AND OWNERSHIP HEREIN ARE DERIVED FROM HISTORICAL AND CURRENT RECORDS LOCATED AT THE DANE COUNTY DEPARTMENT OF PLANNING AND DEVELOPMENT (EG. GIS, PLAT BOOKS, ZONING PERMIT DATA, CSM'S, ETC). DENSITY POLICIES VARY AMONG TOWNS AND MAY REQUIRE INTERPRETATION.

Public Hearing Date	7/28/2020	Petition Number	11570	Applicant:	JDJ RIPP FARMS LLC
Town	Dane	A-1EX Adoption	6/28/1979	Orig Farm Owner	Harry B. Benson
Section:	01	Density Number	35	Original Farm Acres	326.07
Density Study Date	6/3/2020	Original Splits	9.32	Available Density Unit(s)	0

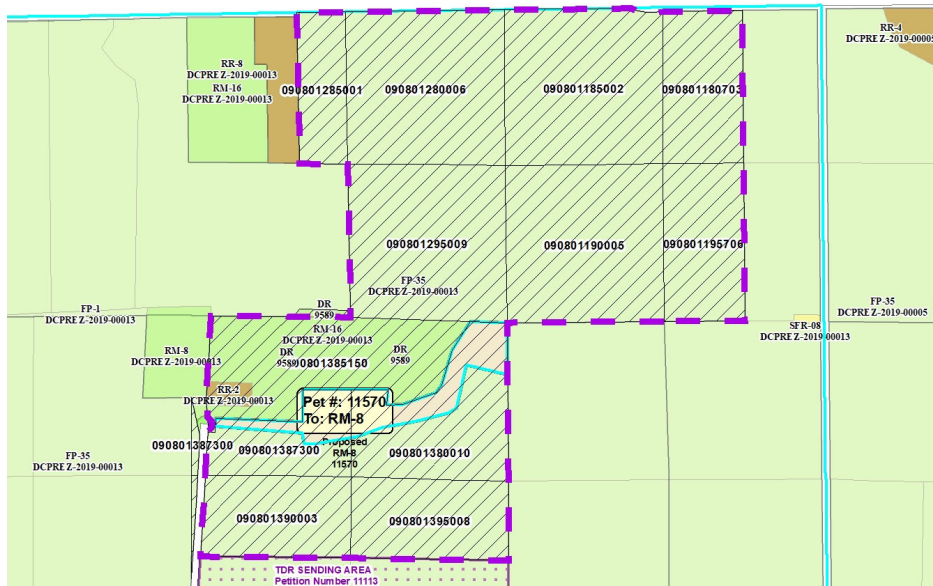

Reasons/Notes:

- [9] Original Housing Density Rights
- [-1] Parcel #090801385150
- [8] HDR Remaining

Note: Parcels included in the density study reflect farm ownership and acreage as of the date of town plan adoption, or other date specified. Density study is based on the original farm acreage, NOT acreage currently owned.

Parcel #	Acres	Owner Name	CSM
090801395008	20.37	JDJ RIPP FARMS LLC	
090801390003	19.98	JDJ RIPP FARMS LLC	
090801387300	15.86	JDJ RIPP FARMS LLC	
090801380010	27.66	JDJ RIPP FARMS LLC	
090801385150	34.53	JOHN J PERSIKE & JENNIFER A BUSHNELL-PERSIKE	
090801295009	39.42	ROBERT H BENSON & ANNE N BENSON	
090801285001	11.71	ROBERT H BENSON & ANNE N BENSON	
090801280006	39.07	ROBERT H BENSON & ANNE N BENSON	
090801195706	20.47	ROBERT H BENSON & ANNE N BENSON	
090801190005	40	ROBERT H BENSON & ANNE N BENSON	

Note: Parcels included in the density study reflect farm ownership and acreage as of the date of town plan adoption, or other date specified. Density study is based on the original farm acreage, NOT acreage currently owned.

090801185002	39.49	ROBERT H BENSON & ANNE N BENSON
--------------	-------	---------------------------------

090801180703	19.56	ROBERT H BENSON & ANNE N BENSON
--------------	-------	---------------------------------
