

DANE COUNTY
REGIONAL AIRPORT
MADISON

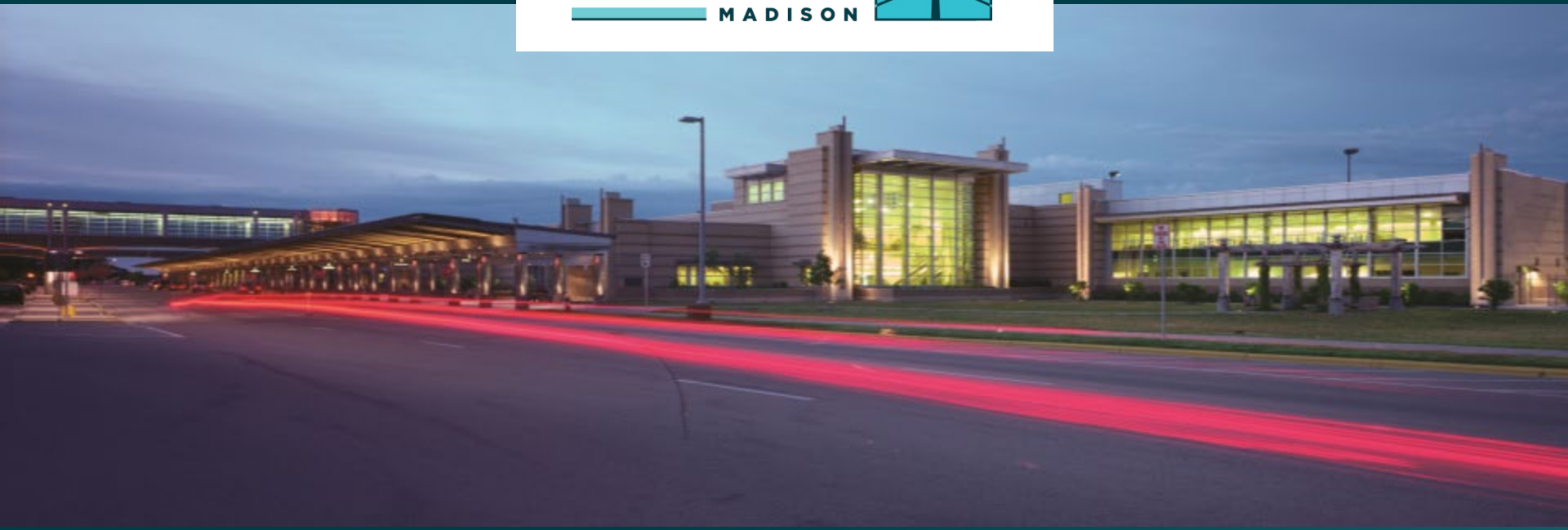

Proposed FY 2021 Budget

September 10, 2020

It's all about the journey.

Projected Revenue to Expenses

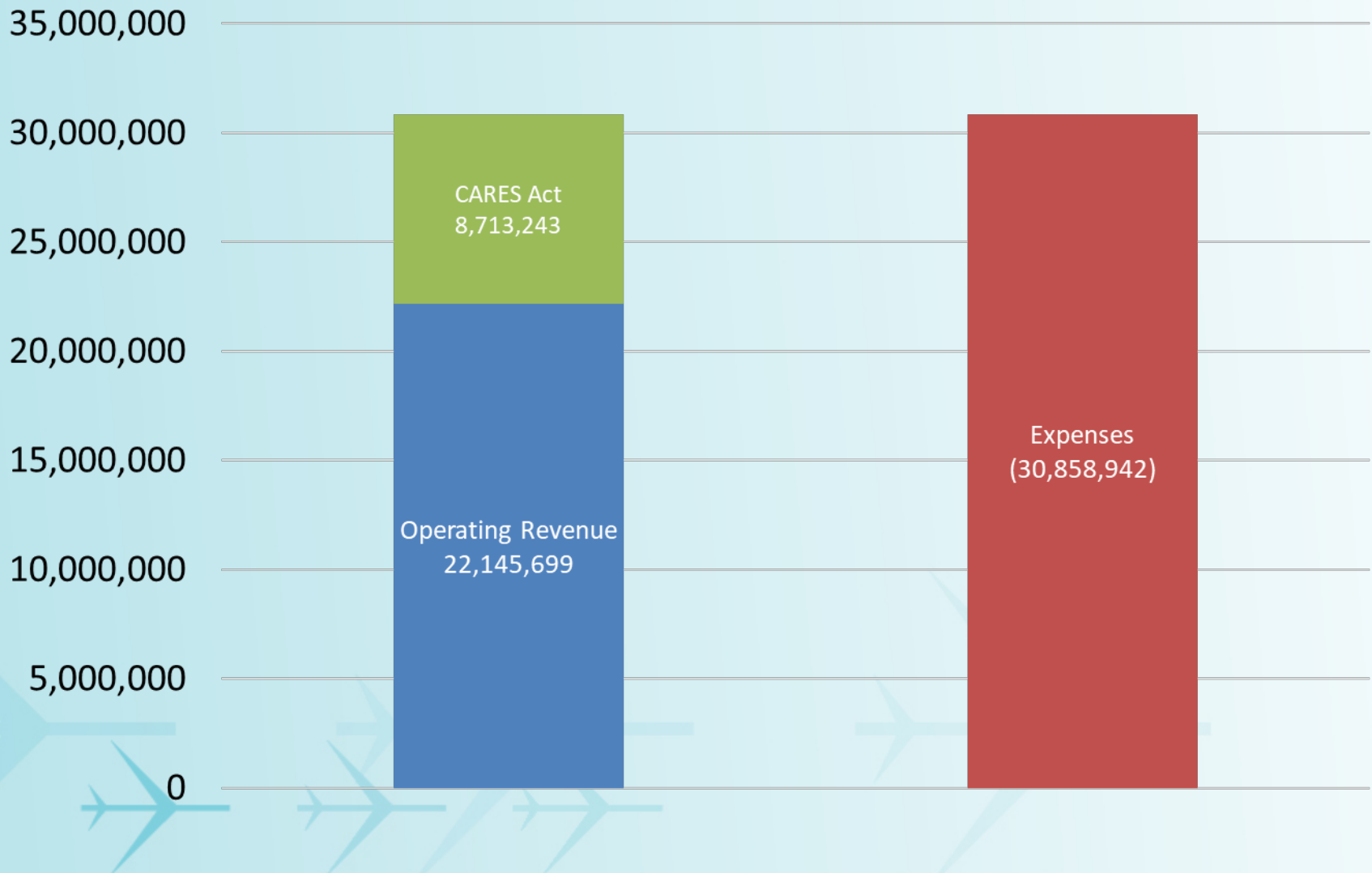

2021 Operating Revenues

Revenue by Category

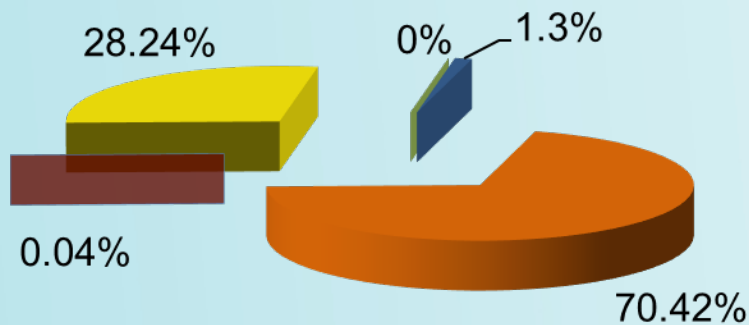

- Public Charge for Service - 70.42%
- Fines, Forfeits & Penalties - 0.04%
- CARES ACT Funding - 28.24%
- Intergovernmental Revenue - 0%
- Miscellaneous - 1.30%

Revenue by Source

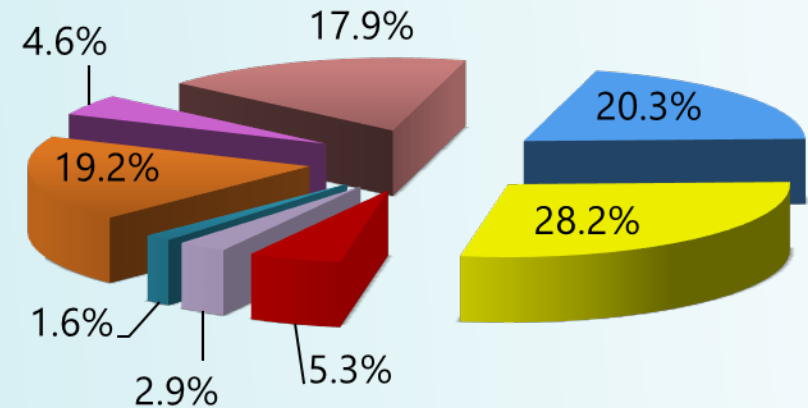

- Airline - 20.3%
- Rental Cars - 5.3%
- Retail - 1.6%
- Airpark - 4.6%
- Parking - 19.2%
- Food - 2.9%
- Other - 17.9%
- CARES Act - 28.2%

2021 Proposed Operating Expenses

- Personal Services
- Operating Expenditures
- Contractual Services
- Operating Capital

\$10,000,000
\$8,000,000
\$6,000,000
\$4,000,000
\$2,000,000
\$0

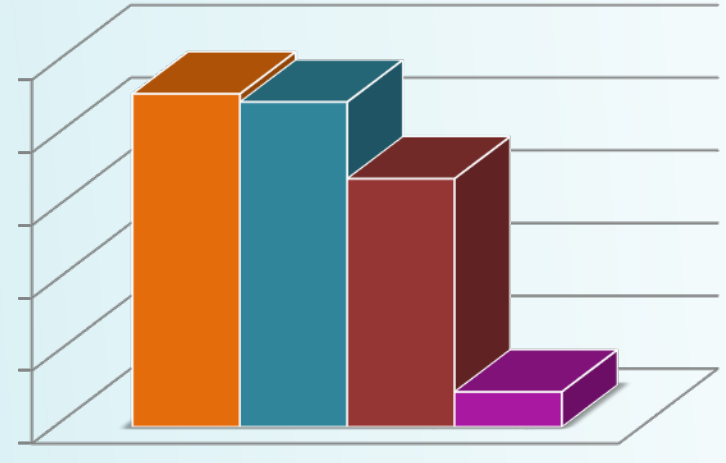

- Personal Services - 35.4%
- Operating Expenditures - 34.5%
- Contractual Services - 26.4%
- Operating Capital - 3.7%



2021 Budget Highlights

1.0 FTE Mechanic Added	\$90,432
Debt Service	
Principal	\$4,585,000
Interest	\$336,706
Total 2021 Debt Service	\$4,921,706
Capital Improvement Plan	
Mower	\$125,000
Parking Ticket Equipment	\$155,000
Tractor	\$156,000
Snow Blower	\$900,000
Combined Federal Projects	\$1,386,500
Terminal Modernization	\$40,000,000
Total 2021 CIP Budgeted	\$42,722,500

Changes in 2021

► Airline Charges

- Sig Rental Rate: \$28.85 ▲ 0.06%
- Landing Fee: \$2.90 ▼ 1%

► Passengers

- 1,320,000 ▼ 40%

► Landed Weight

- 931,200 ▼ 40%

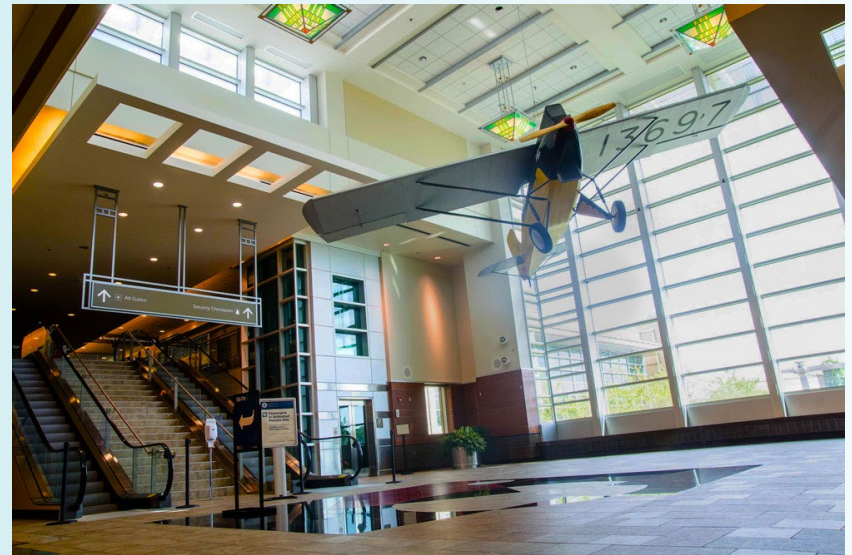

DANE COUNTY
REGIONAL AIRPORT
MADISON



Questions?

It's all about the journey.