

DRAFT: FOR DISCUSSION PURPOSES ONLY

IMPORTANT NOTE: ACREAGE VALUES AND OWNERSHIP HEREIN ARE DERIVED FROM HISTORICAL AND CURRENT RECORDS LOCATED AT THE DANE COUNTY DEPARTMENT OF PLANNING AND DEVELOPMENT (EG. GIS, PLAT BOOKS, ZONING PERMIT DATA, CSM'S, ETC). DENSITY POLICIES VARY AMONG TOWNS AND MAY REQUIRE INTERPRETATION.

Public Hearing Date	3/23/2021	Petition Number	11662	Applicant:	Derick G Babler
Town	Dane	A-1EX Adoption	6/28/1979	Orig Farm Owner	Doral Clark
Section:	08	Density Number	35	Original Farm Acres	162.31
Density Study Date	3/23/2021	Original Splits	4.64	Available Density Unit(s)	2

Reasons/Notes:

[4] Original building sites. Based on the "current ownership" policies of the Town. Each 40 would net [1] building right. (Lange and Hartmann) Neither parcel has ROW access.

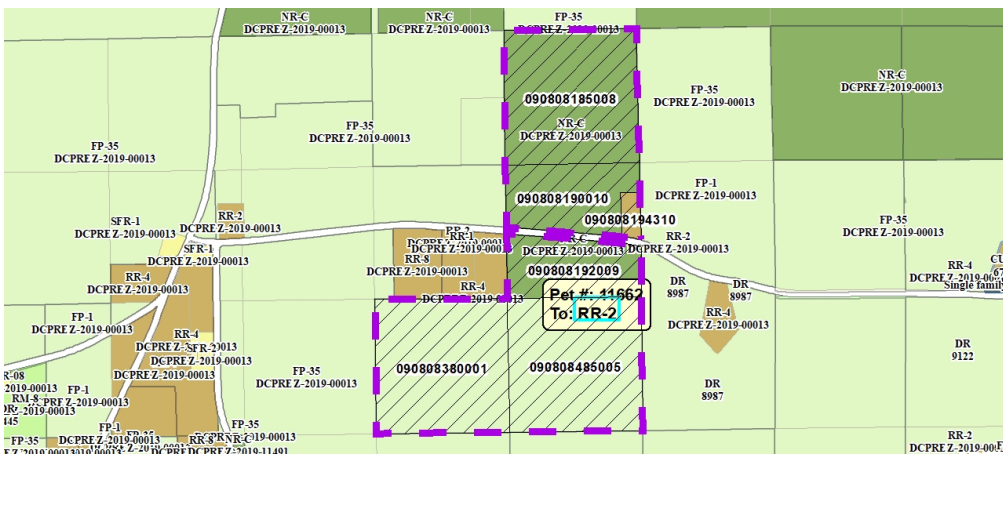

Note: Parcels included in the density study reflect farm ownership and acreage as of the date of town plan adoption, or other date specified. Density study is based on the original farm acreage, NOT acreage currently owned.

Parcel #	Acres	Owner Name	CSM
090808194310	2.05	JEFFREY B PEDERSEN & AMY L PEDERSEN	08922
090808485005	41.13	RUSSELL D HARTMANN & DARLENE M HARTMANN	
090808380001	40.93	THOMAS E LANGE	
090808192009	17.97	WI DNR	
090808190010	19.18	WI DNR	
090808185008	41.05	WI DNR	