

DRAFT: FOR DISCUSSION PURPOSES ONLY

IMPORTANT NOTE: ACREAGE VALUES AND OWNERSHIP HEREIN ARE DERIVED FROM HISTORICAL AND CURRENT RECORDS LOCATED AT THE DANE COUNTY DEPARTMENT OF PLANNING AND DEVELOPMENT (EG. GIS, PLAT BOOKS, ZONING PERMIT DATA, CSM'S, ETC). DENSITY POLICIES VARY AMOONG TOWNS AND MAY

Applicant: Sinon Galvin

Public Hearing Date: 8/27/2024

Petition Number: 12083

Town: Black Earth

Orig Farm Owner: Noreen George Lucey

Density Study Date: 4/20/2022

Original Farm Acres: 230.84

Section: 32, 33, 28

Available Density Unit(s): 5

Adoption Date: 8/14/1981

Original Splits: 6.6

Density Number: 35

Accela Number: DCPREZ-2024-12083

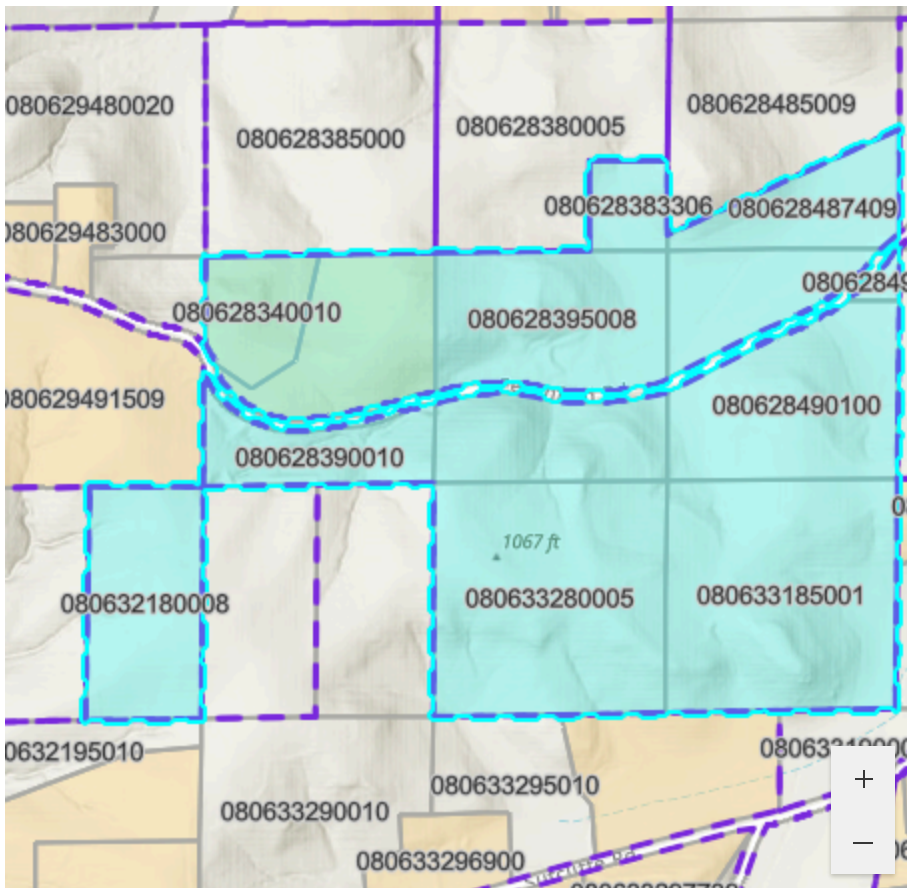

Reasons / Notes:

[7] Original Splits - None taken to date
Per ROD DOC 3200052 [6] splits go with 080628390003 and 080632180008 [-2] splits for the RR-8 and RR-16 lots north of Fesenfeld Rd [5] Splits Remain

Note: Parcels included in the density study reflect farm ownership and acreage as of the date of town plan adoption, or other date specified. Density study is based on the original farm acreage, NOT acreage currently

DRAFT: FOR DISCUSSION PURPOSES ONLY

Applicant: Sinon Galvin

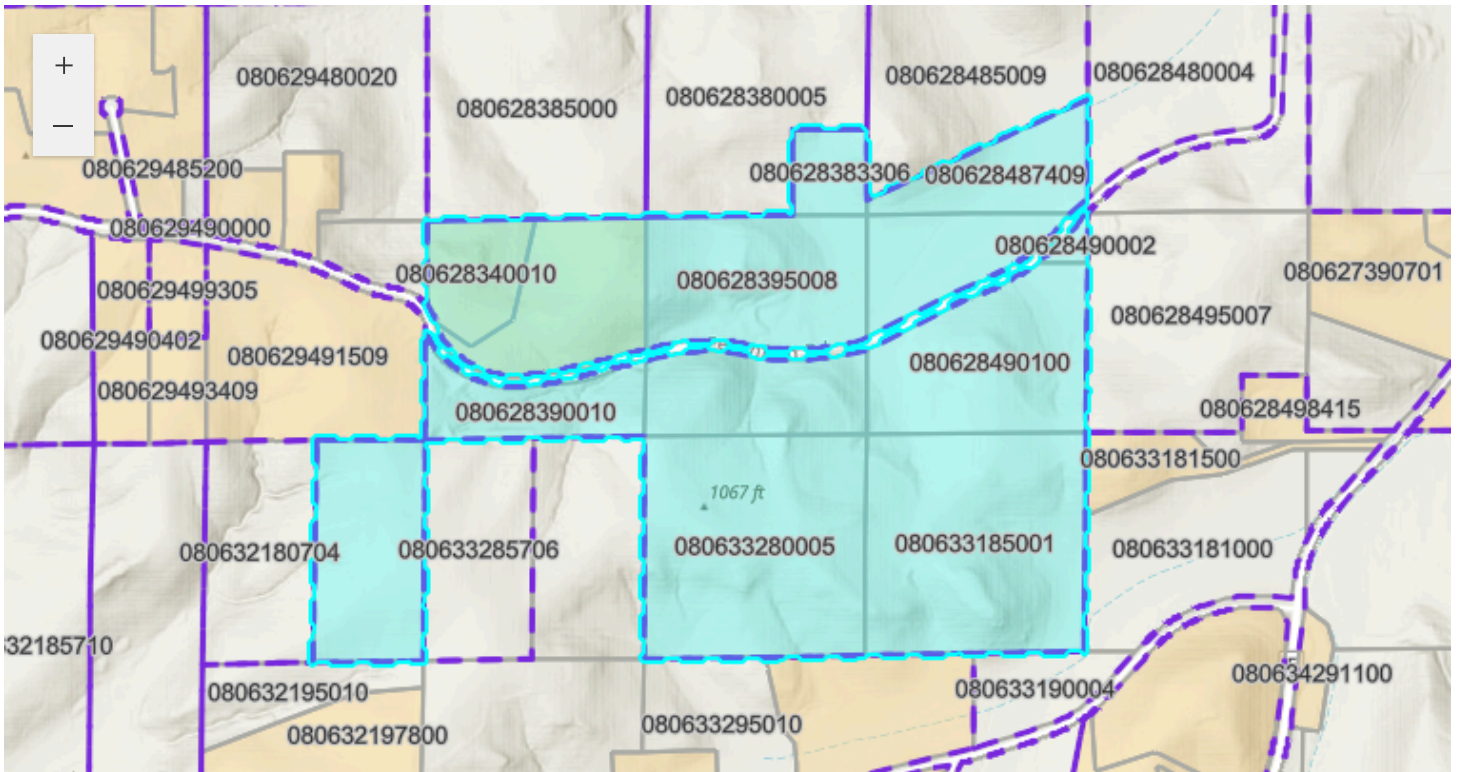

Esri, NASA, NGA, USGS, FEMA | Esri Community Maps Contributors, County of Dane, Esri, TomTom, Garmin, SafeGrap... Powered by Esri

Parcel Number	Acres	Owner	CSM
080628340010	8.91	KOWALSKI REV TR, TIMOTHY EDWARD	16350
080628340120	17.29	KOWALSKI REV TR, TIMOTHY EDWARD	16350
080628383306	5.38	MARK LUCEY	
080628390010	11.22	BORODINLAAN LLC	
080628487409	11.66	MARK LUCEY	
080628490002	0.93	MARK LUCEY	
080628490100	36.71	MARK LUCEY	
080632180008	20.14	BORODINLAAN LLC	
080633280005	40.44	MARK LUCEY	
080628395008	38.2	MARK LUCEY	
080633185001	39.95	MARK LUCEY	