

DRAFT: FOR DISCUSSION PURPOSES ONLY

IMPORTANT NOTE: ACREAGE VALUES AND OWNERSHIP HEREIN ARE DERIVED FROM HISTORICAL AND CURRENT RECORDS LOCATED AT THE DANE COUNTY DEPARTMENT OF PLANNING AND DEVELOPMENT (EG. GIS, PLAT BOOKS, ZONING PERMIT DATA, CSM'S, ETC). DENSITY POLICIES VARY AMOONG TOWNS AND MAY

Applicant: Esser Trust

Public Hearing Date: 11/19/2024

Petition Number: 12114

Town: Cross Plains	Orig Farm Owner: Miller, Arnold Tr.
Density Study Date: 9/26/2024	Original Farm Acres: 123.43
Section: 34	Available Density Unit(s): 1
Adoption Date: 12/25/1981	Original Splits: 3.53
Density Number: 35	Accela Number: 12114

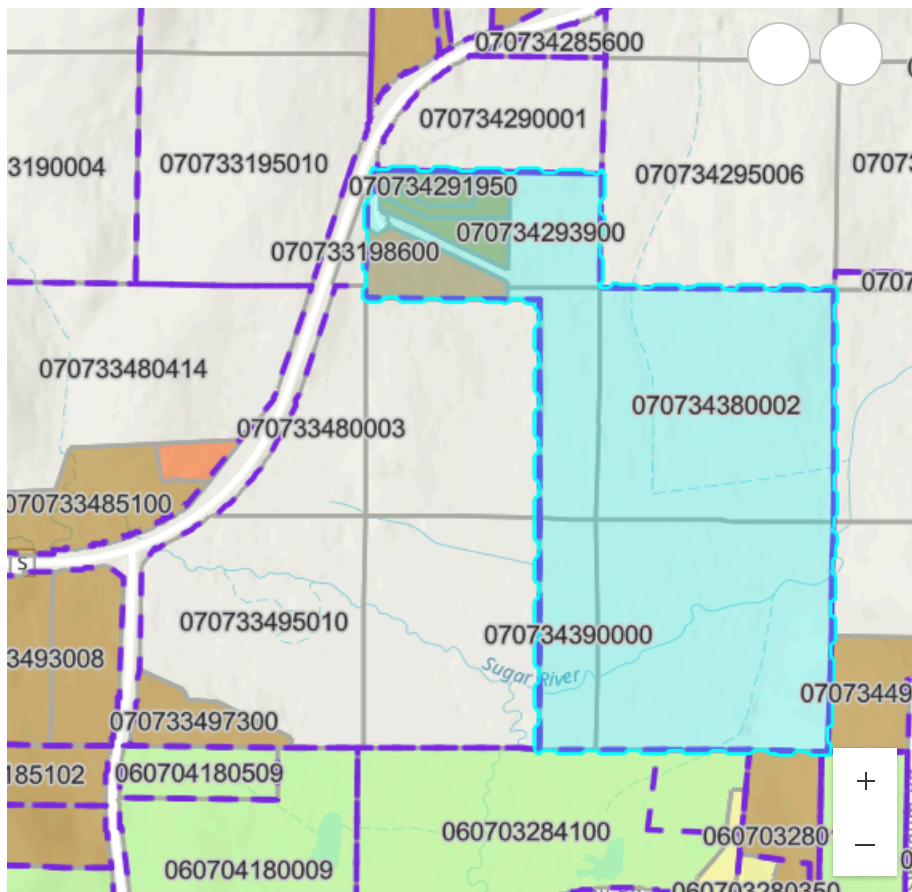

Reasons / Notes:

The original farm unit was eligible for 4 density units. 3 prior density units taken per CSM 11166 (lot 4 split the existing farm residence, which does not count). One density unit remains and would be exhausted if the TDR proposal is approved.

Note: Parcels included in the density study reflect farm ownership and acreage as of the date of town plan adoption, or other date specified. Density study is based on the original farm acreage, NOT acreage currently

DRAFT: FOR DISCUSSION PURPOSES ONLY

Print

Applicant: Esser Trust

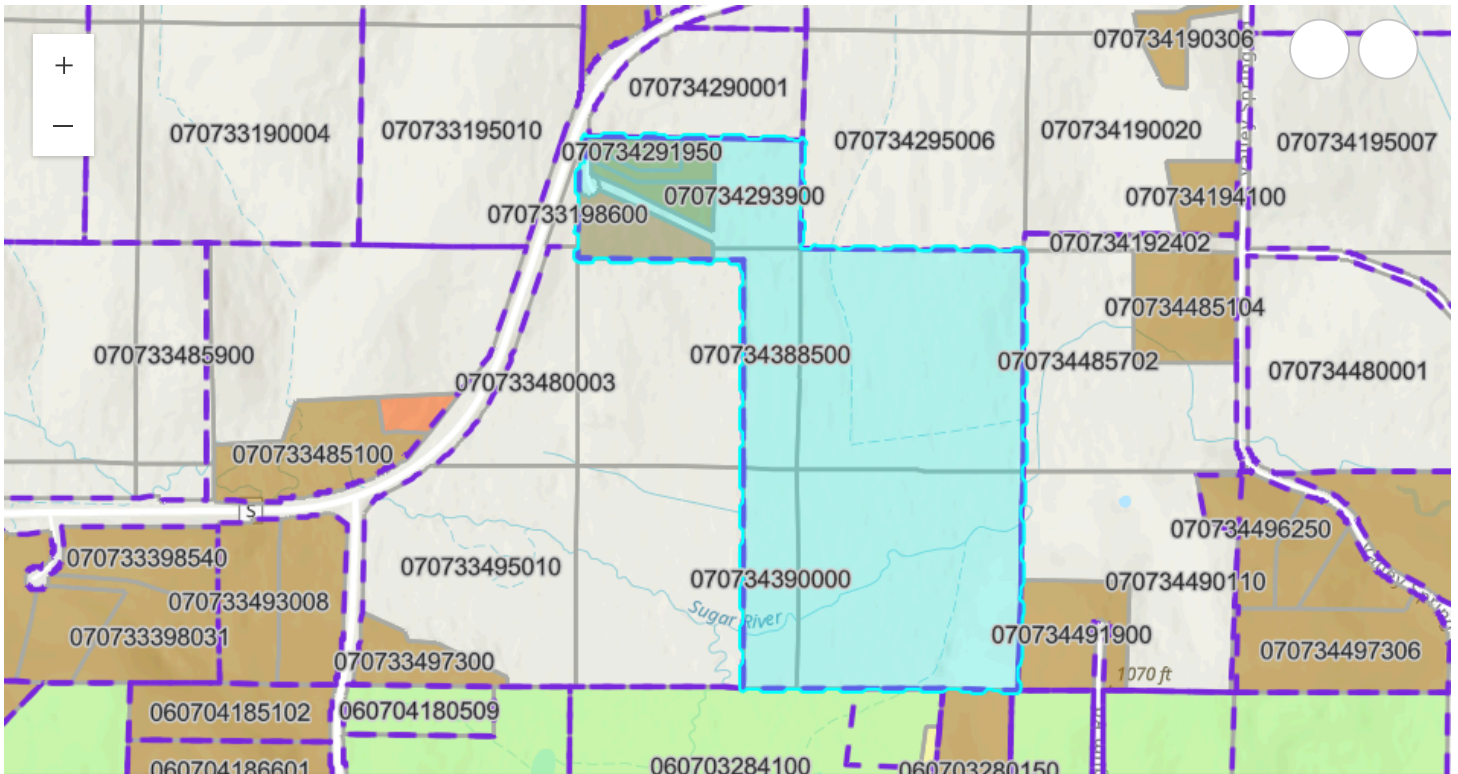

Esri, NASA, NGA, USGS, FEMA | Esri Community Maps Contributors, County of Dane, Esri, TomTom, Garmin, SafeGrap... Powered by Esri

Parcel Number	Acres	Owner	CSM
070734291950	2.05	ESSER FAMILY TR	11166
070734292200	2.11	ESSER FAMILY TR	11166
070734292450	2.45	ESSER FAMILY TR	11166
070734292700	5.23	JOSEPH C HANAUER & SUSAN P HANAUER	11166
070734293900	9.21	ESSER FAMILY TR	
070734380002	41.05	ESSER FAMILY TR	
070734388500	10.46	ESSER FAMILY TR	
070734390000	10	ESSER FAMILY TR	
070734395005	40.35	ESSER FAMILY TR	