



Note: Density policies vary by town. Farmstead ownership is based on the date farmland preservation zoning. This report is based on the best property information available to staff. Please contact staff with questions at (608) 266-4266. Learn about density studies at <https://danecountyplanning.com/Permits-Applications/Density->

Applicant: Muddy Beaver Enterprises

Farmstead Owner: Betty & Fred Woldt

Accela ID:

Farmland Preservation Enacted: 9/9/1979

Density Study Date: 6/30/2025

Density Factor: 1:75 acres

Public Hearing Date: 8/26/2025

Farmstead Acres: 58.61

Town: York

Available Density Unit(s): 0

Section(s): 13

Original Splits: 0.78

Petition Number: 12190

Justification: Under 75 acres, so no density units. Current home predates York's density policy date of 8-28-80 and separation of the home does not count as a split.

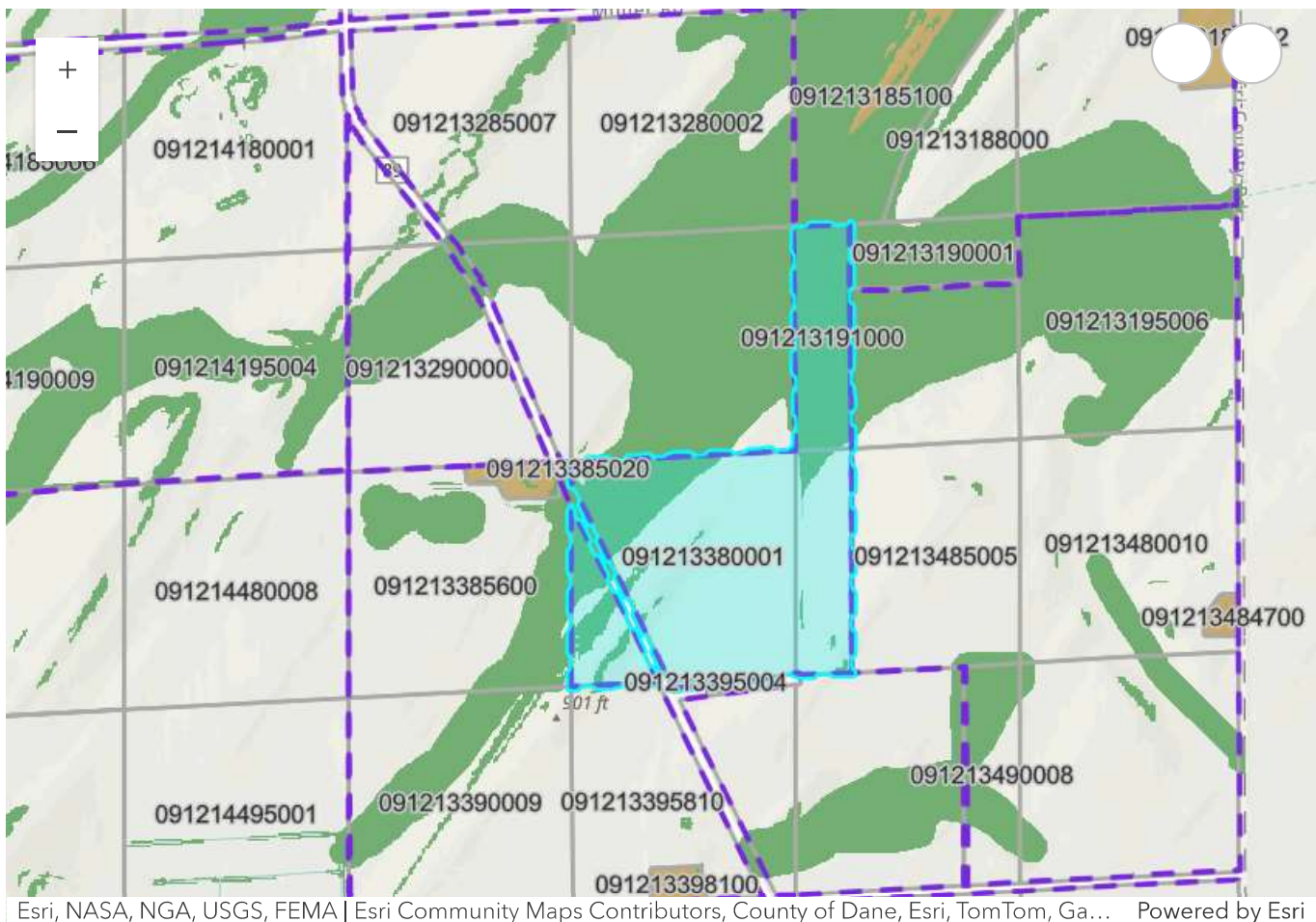

FARMLAND PRESERVATION DENSITY STUDY

Print

Applicant: Muddy Beaver Enterprises

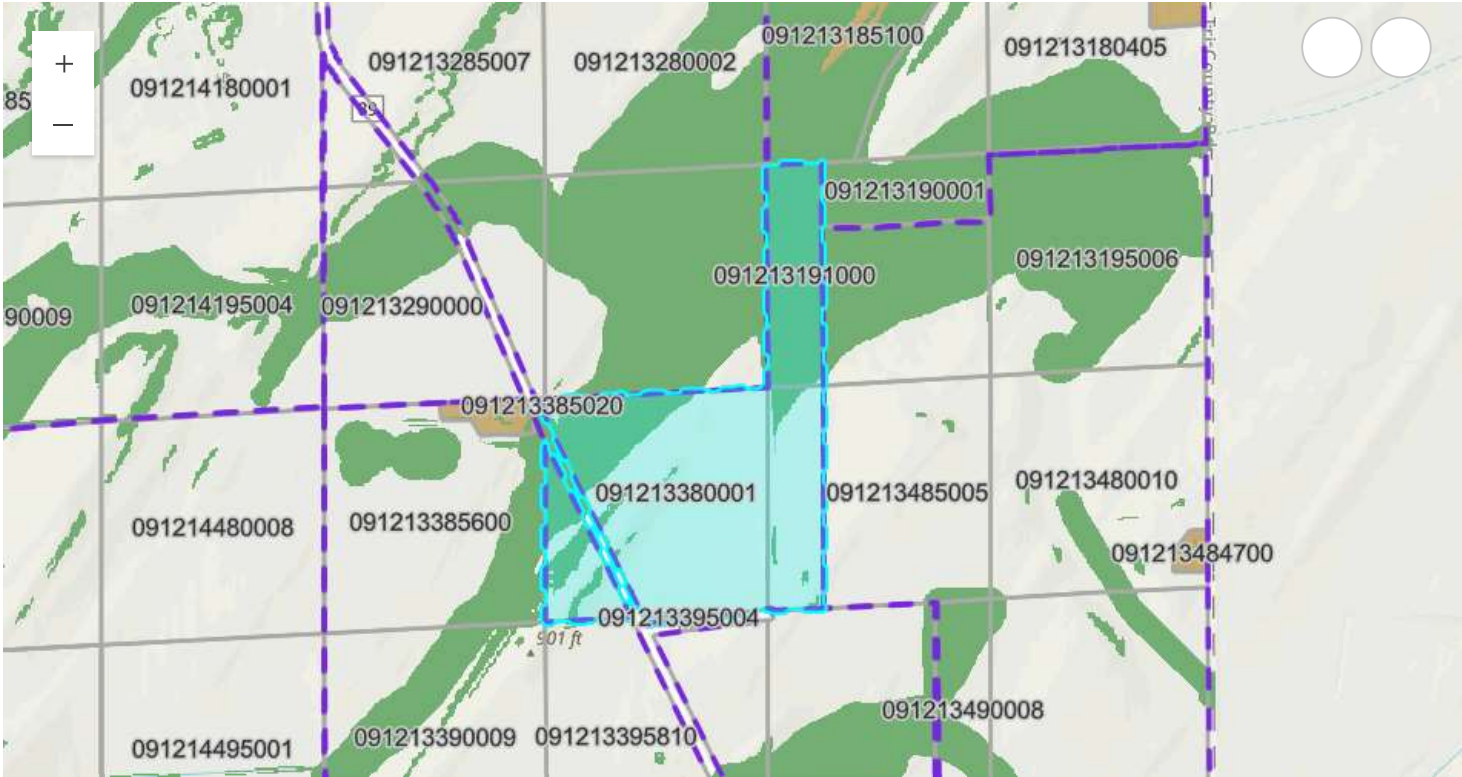

Esri, NASA, NGA, USGS, FEMA | Esri Community Maps Contributors, County of Dane, Esri, TomTom, Garmin, SafeGrap... Powered by Esri

Parcel Number	Acres	Owner	CSM
091213191000	10.01	MUDDY BEAVER ENTERPRISES LLC	
091213380001	38.26	MUDDY BEAVER ENTERPRISES LLC	
091213395004	0.34	MUDDY BEAVER ENTERPRISES LLC	
091213486004	10	MUDDY BEAVER ENTERPRISES LLC	