

FARMLAND PRESERVATION DENSITY STUDY

Note: Density policies vary by town. Farmstead ownership is based on the date farmland preservation zoning. This report is based on the best property information available to staff. Please contact staff with questions at (608) 266-4266. Learn about density studies at <https://danecountyplanning.com/Permits-Applications/Density-Study>

Applicant: Town of Dunkirk

Farmstead Owner: Segebrecht, Roger

Accele ID: 12262

Farmland Preservation Enacted: 12/16/1979

Density Study Date: 2/20/2026

Density Factor: 1:40acres

Town: Dunkirk

Farmstead Acres: 74.62

Section(s): 17

Available Density Unit(s): 1

Original Density Units: 1.87

Justification: The 1979 Segebrecht farm totaled approximately 75 acres. There appear to have been two residences on the property as of 7/1/1979 based on a review of historical aerial photos and site plans. One density unit remains for a replacement home. If the petition is approved, it appears the eligible splits will be exhausted.

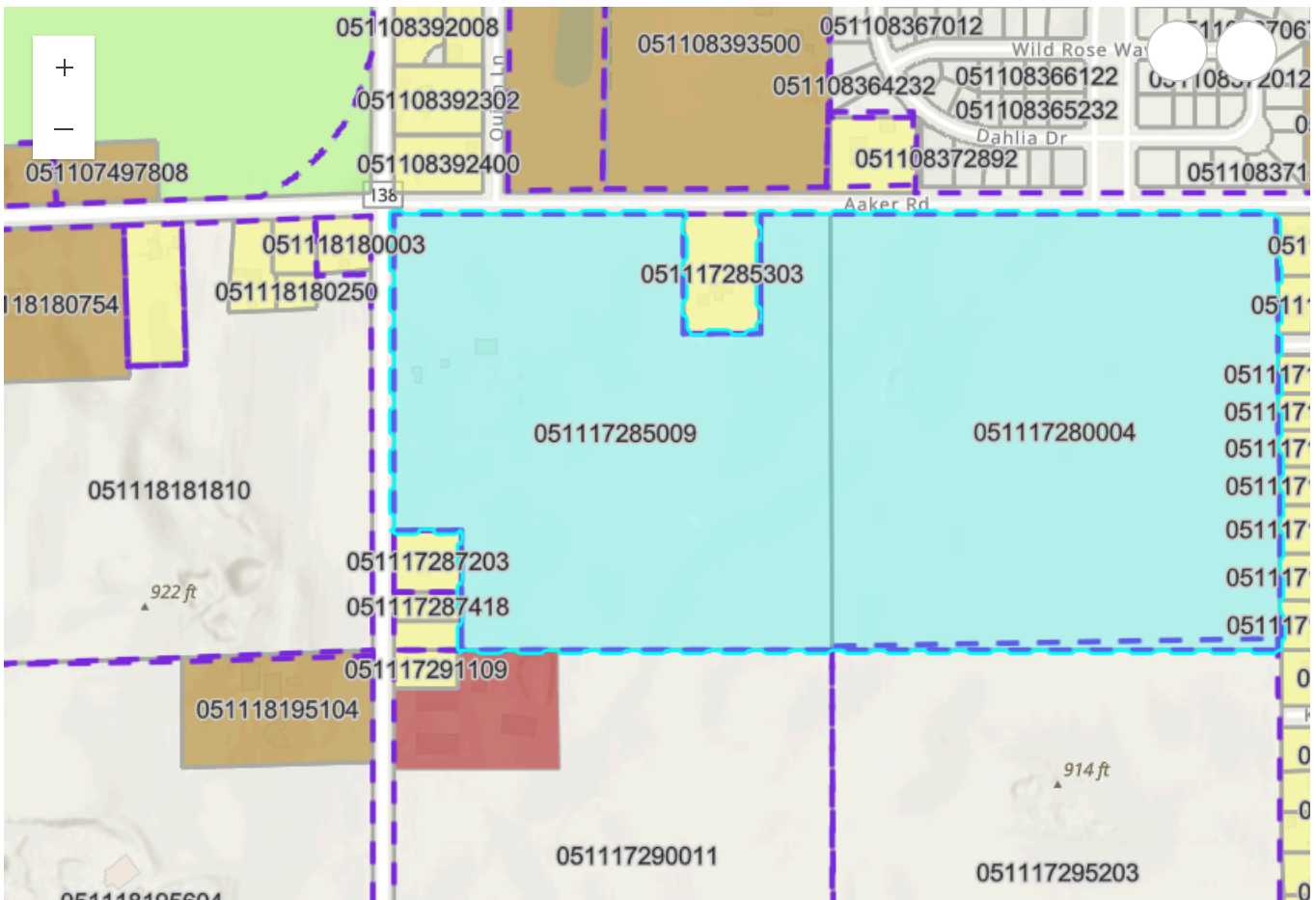

FARMLAND PRESERVATION DENSITY STUDY

Applicant: Town of Dunkirk

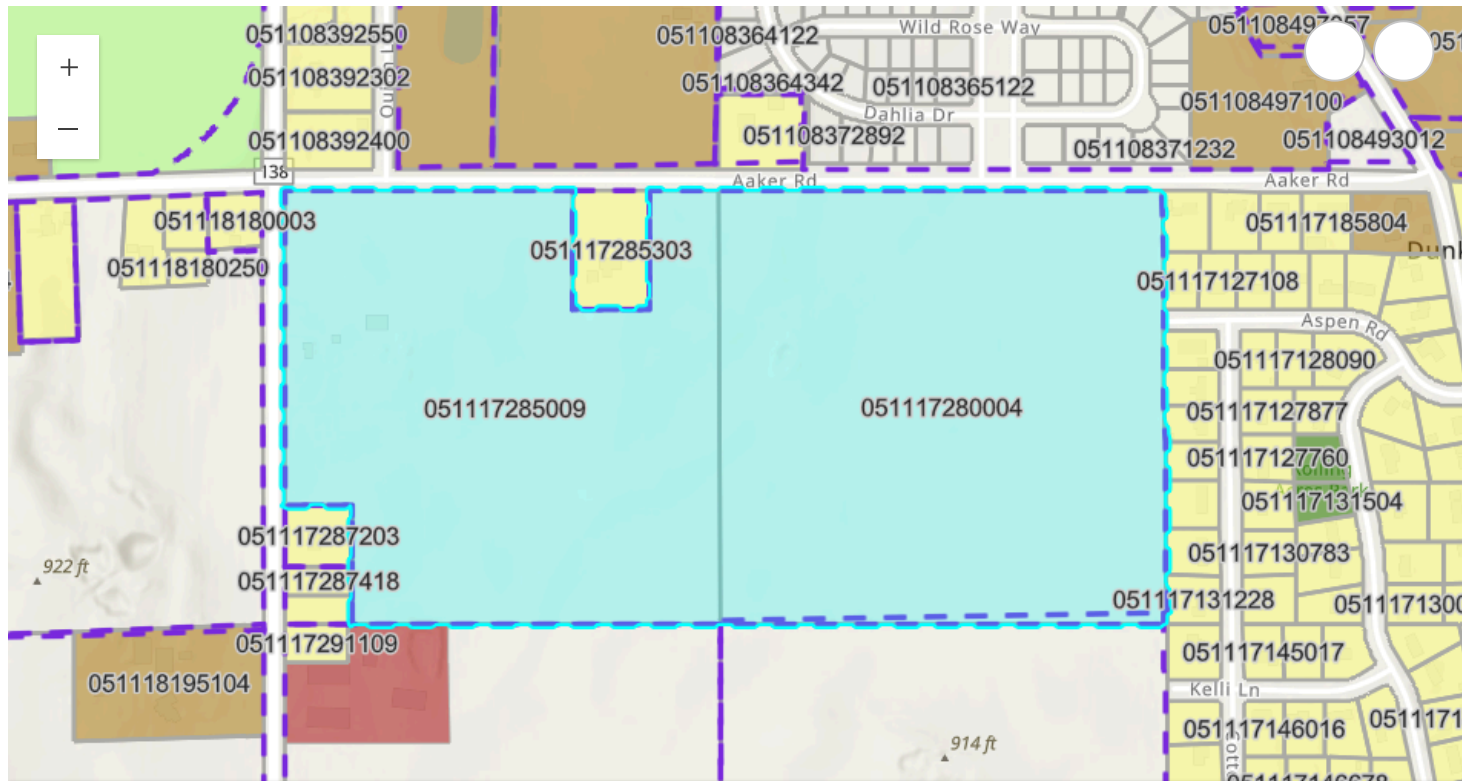

Esri, NASA, NGA, USGS, FEMA | Esri Community Maps Contributors, County of Dane, © OpenStreetMap, Microsoft, Esri... Powered by Esri

Parcel Number	Acres	Owner	CSM
051117285009	35.09	SEGEBRECHT FARMS LLC	
051117280004	39.53	SEGEBRECHT FARMS LLC	