

# DRAFT: FOR DISCUSSION PURPOSES ONLY

IMPORTANT NOTE: ACREAGE VALUES AND OWNERSHIP HEREIN ARE DERIVED FROM HISTORICAL AND CURRENT RECORDS LOCATED AT THE DANE COUNTY DEPARTMENT OF PLANNING AND DEVELOPMENT (EG. GIS, PLAT BOOKS, ZONING PERMIT DATA, CSM'S, ETC). DENSITY POLICIES VARY AMONG TOWNS AND MAY REQUIRE INTERPRETATION.

<b>Public Hearing Date</b>	1/22/2024	<b>Petition Number</b>	12000	<b>Applicant:</b>	BARMAN LIVING TR
<b>Town</b>	Cross Plains	<b>A-1EX Adoption</b>	12/26/1981	<b>Orig Farm Owner</b>	Laufenberg, Gary & Marjorie
<b>Section:</b>	20	<b>Density Number</b>	35	<b>Original Farm Acres</b>	208.96
<b>Density Study Date</b>	11/30/2023	<b>Original Splits</b>	5.97	<b>Available Density Unit(s)</b>	0

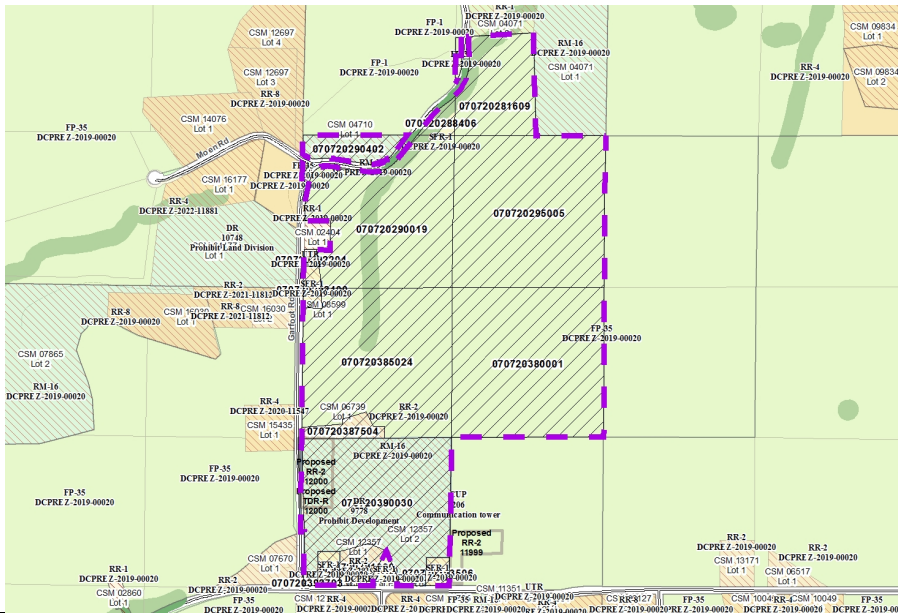

### Reasons/Notes:

Homesites created to date: 6 per CSMs 4710, 8465, 8466, 8599, 12357, Lot 1 and SFR-1 zoning on PIN 070720288406.

NOTES: CSM 6739 separated an existing farmstead; CSM 12357, Lot 2 is deed restricted against residences.

Note: Parcels included in the density study reflect farm ownership and acreage as of the date of town plan adoption, or other date specified. Density study is based on the original farm acreage, NOT acreage currently owned.

Parcel #	Acres	Owner Name	CSM
070720390030	32.03	BARMAN LIVING TR	12357
070720391000	2.63	BRENDAN J CLARK & PAULA A CLARK	12357
070720292400	1.29	GEORGE SAPON & MANDI SAPON	08599
070720292204	0.4	GEORGE SAPON & MANDI SAPON	
070720290402	4.25	GREGORY K HARTIG & KIMBERLY J HARTIG	04710
070720288406	1.44	GREGORY K HARTIG & KIMBERLY J HARTIG	
070720392703	1.31	JAMES D BRATTON & CATHERINE WALSH-BRATTON	08465
070720387504	2.35	KIP R KALSCHUR & JANET H KALSCHUR	06739
070720385024	36.42	KIP R KALSCHUR & JANET H KALSCHUR	
070720380001	40.04	KIP R KALSCHUR & JANET H KALSCHUR	

Note: Parcels included in the density study reflect farm ownership and acreage as of the date of town plan adoption, or other date specified. Density study is based on the original farm acreage, NOT acreage currently owned.

070720295005	40.46	KIP R KALSCHEUR & JANET H KALSCHEUR	
070720290019	31.55	KIP R KALSCHEUR & JANET H KALSCHEUR	
070720281609	13.38	KIP R KALSCHEUR & JANET H KALSCHEUR	
070720393506	1.18	MICHAEL JAMES HARROP	08466