

DRAFT: FOR DISCUSSION PURPOSES ONLY

IMPORTANT NOTE: ACREAGE VALUES AND OWNERSHIP HEREIN ARE DERIVED FROM HISTORICAL AND CURRENT RECORDS LOCATED AT THE DANE COUNTY DEPARTMENT OF PLANNING AND DEVELOPMENT (EG. GIS, PLAT BOOKS, ZONING PERMIT DATA, CSM'S, ETC). DENSITY POLICIES VARY AMONG TOWNS AND MAY REQUIRE INTERPRETATION.

Public Hearing Date	6/18/2024	Petition Number	12059	Applicant:	Jadrien Deibler
Town	Perry	A-1EX Adoption	8/22/1979	Orig Farm Owner	Komesar, Neil K.
Section:	07	Density Number	35	Original Farm Acres	122.09
Density Study Date	4/29/2024	Original Splits	3.49	Available Density Unit(s)	2

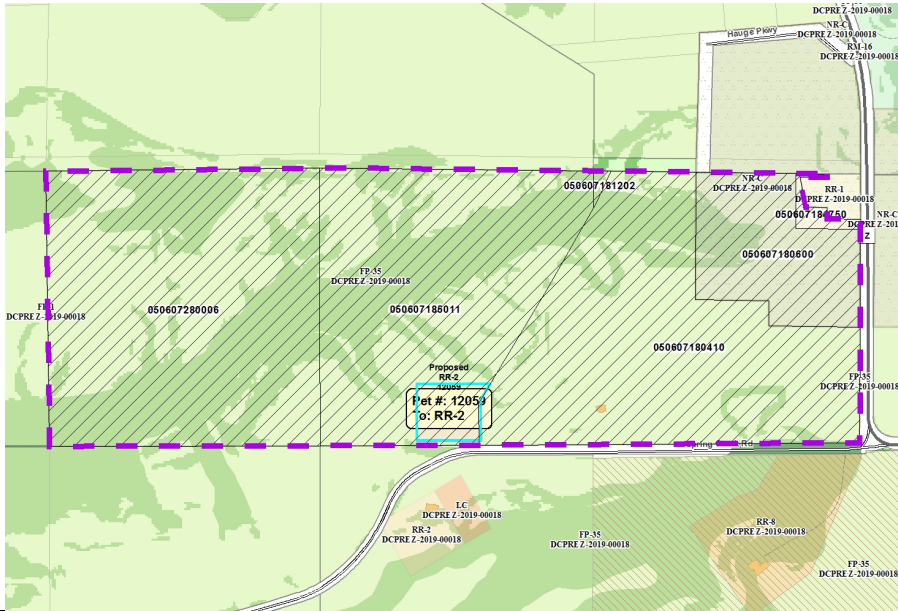

Reasons/Notes:

Homesites created to date:
 1 per existing home on PIN 0506-071-8041-0
 New development should avoid resource protection corridors.

Note: Parcels included in the density study reflect farm ownership and acreage as of the date of town plan adoption, or other date specified. Density study is based on the original farm acreage, NOT acreage currently owned.

Parcel #	Acres	Owner Name	CSM
050607180410	35.65	CRAIG H BLUSCHKE & LINDA L JOHNSON	
050607280006	41.66	JADRIEN DEIBLER	
050607185011	32.96	JADRIEN DEIBLER	
050607181202	0.18	JADRIEN DEIBLER	
050607184750	0.73	PERRY HAUGE LOG CHURCH PRESERVATION ASSOCIATION INC	
050607180600	10.9	PERRY, TOWN OF	