

# DRAFT: FOR DISCUSSION PURPOSES ONLY

IMPORTANT NOTE: ACREAGE VALUES AND OWNERSHIP HEREIN ARE DERIVED FROM HISTORICAL AND CURRENT RECORDS LOCATED AT THE DANE COUNTY DEPARTMENT OF PLANNING AND DEVELOPMENT (EG. GIS, PLAT BOOKS, ZONING PERMIT DATA, CSM'S, ETC). DENSITY POLICIES VARY AMONG TOWNS AND MAY REQUIRE INTERPRETATION.

<b>Public Hearing Date</b>	5/28/2024	<b>Petition Number</b>	12041	<b>Applicant:</b>	MCGREE and CHRISTEL
<b>Town</b>	Vermont	<b>A-1EX Adoption</b>	10/12/1979	<b>Orig Farm Owner</b>	Fred O. Stampfli
<b>Section:</b>	16, 17	<b>Density Number</b>	35	<b>Original Farm Acres</b>	170.04
<b>Density Study Date</b>	9/7/2021	<b>Original Splits</b>	4.86	<b>Available Density Unit(s)</b>	4

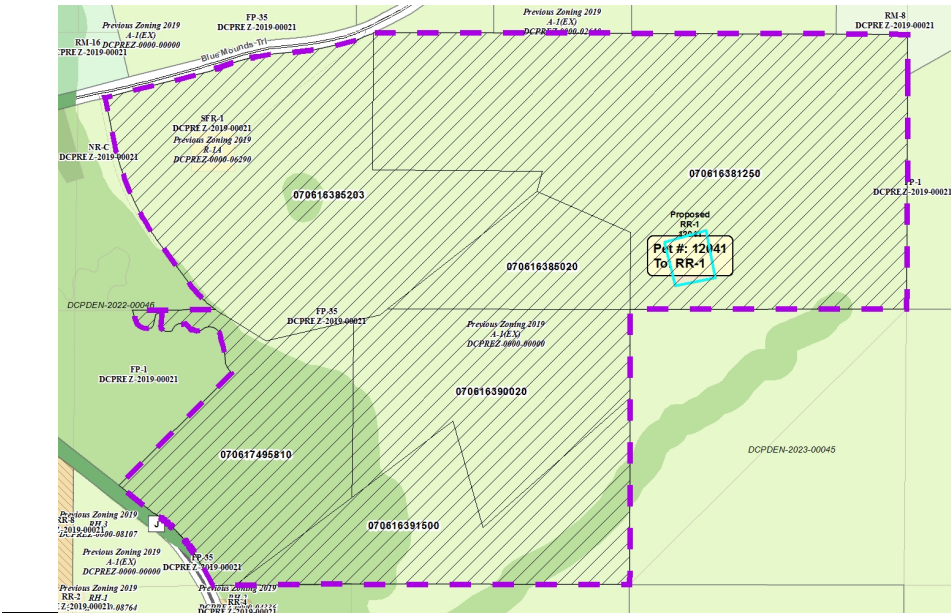

**Reasons/Notes:**  
 Homesites created to date: 1 per Rezone 06290.  
 2 potential homesites allocated to McGee / Cristel landholdings per ROD doc #4494585.

Note: Parcels included in the density study reflect farm ownership and acreage as of the date of town plan adoption, or other date specified. Density study is based on the original farm acreage, NOT acreage currently owned.

Parcel #	Acres	Owner Name	CSM
070616385203	38.43	BEWICK REV TR, GARY W	
070616391500	20.12	KERMICLE TR, JERRY L & DOROTHEA J	
070617495810	20.49	NA PROPERTIES LLC	
070616390020	21.89	NA PROPERTIES LLC	
070616385020	9.29	NA PROPERTIES LLC	
070616381250	59.82	NATHANIEL THOMAS MCGREE & DANA MAE CHRISTEL	