

FARMLAND PRESERVATION DENSITY STUDY

Note: Density policies vary by town. Farmstead ownership is based on the date farmland preservation zoning. This report is based on the best property information available to staff. Please contact staff with questions at (608) 266-4266. Learn about density studies at <https://danecountyplanning.com/Permits-Applications/Density-Study>

Applicant: DEVIN HELT

Farmstead Owner: Rodney Goeden

Accela ID: DCPREZ-2026-12271

Farmland Preservation Enacted: 6/27/1979

Density Study Date: 4/27/2026

Density Factor: 1:35 acres

Public Hearing Date: 5/26/2026

Farmstead Acres: 48.92

Town: Dane

Available Density Unit(s): 0

Section(s): 26

Original Density Units: 1.4

Petition Number: 12271

Justification: [1] original split. Separation of existing home counts against density.

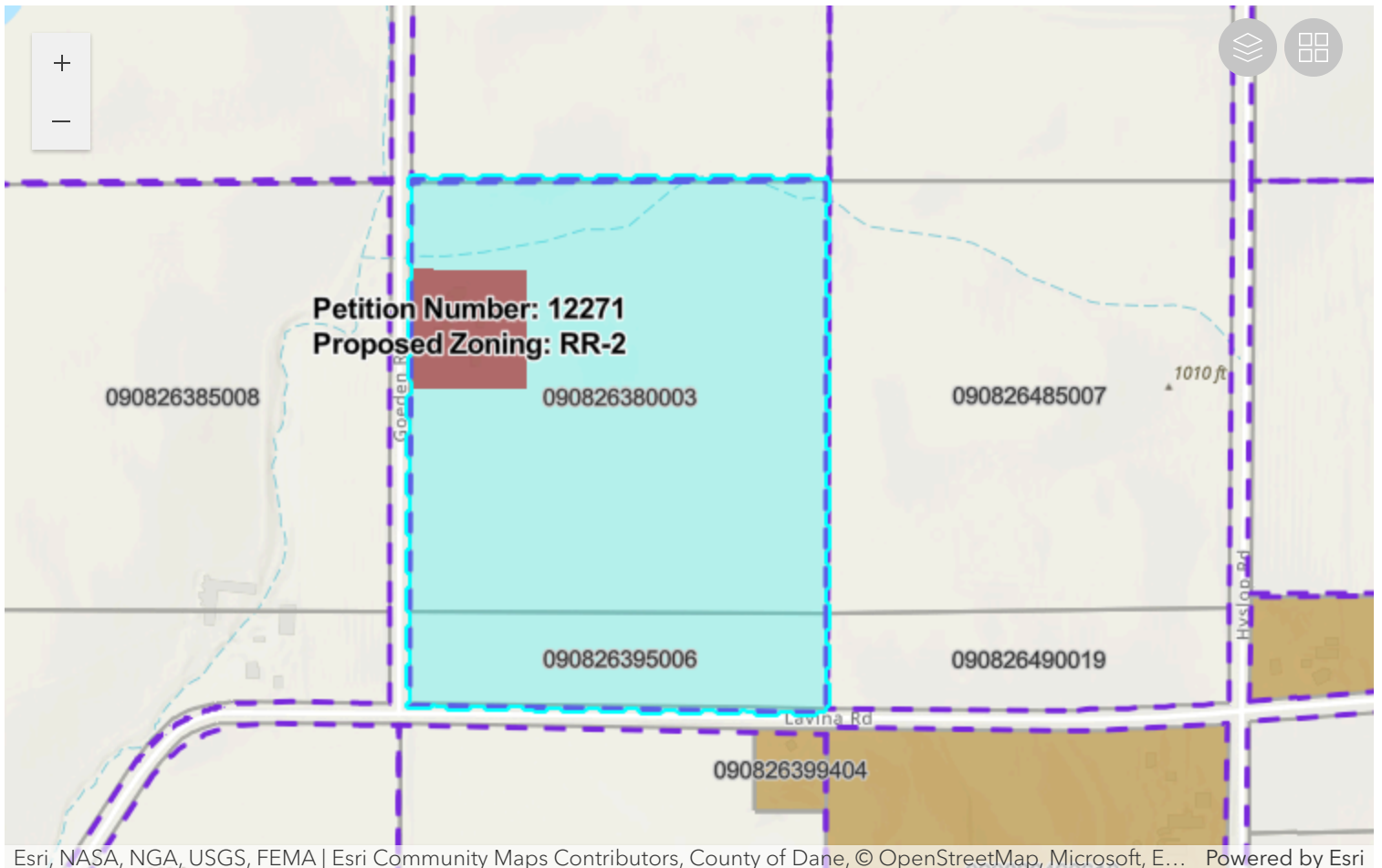

FARMLAND PRESERVATION DENSITY STUDY

Applicant: DEVIN HELT

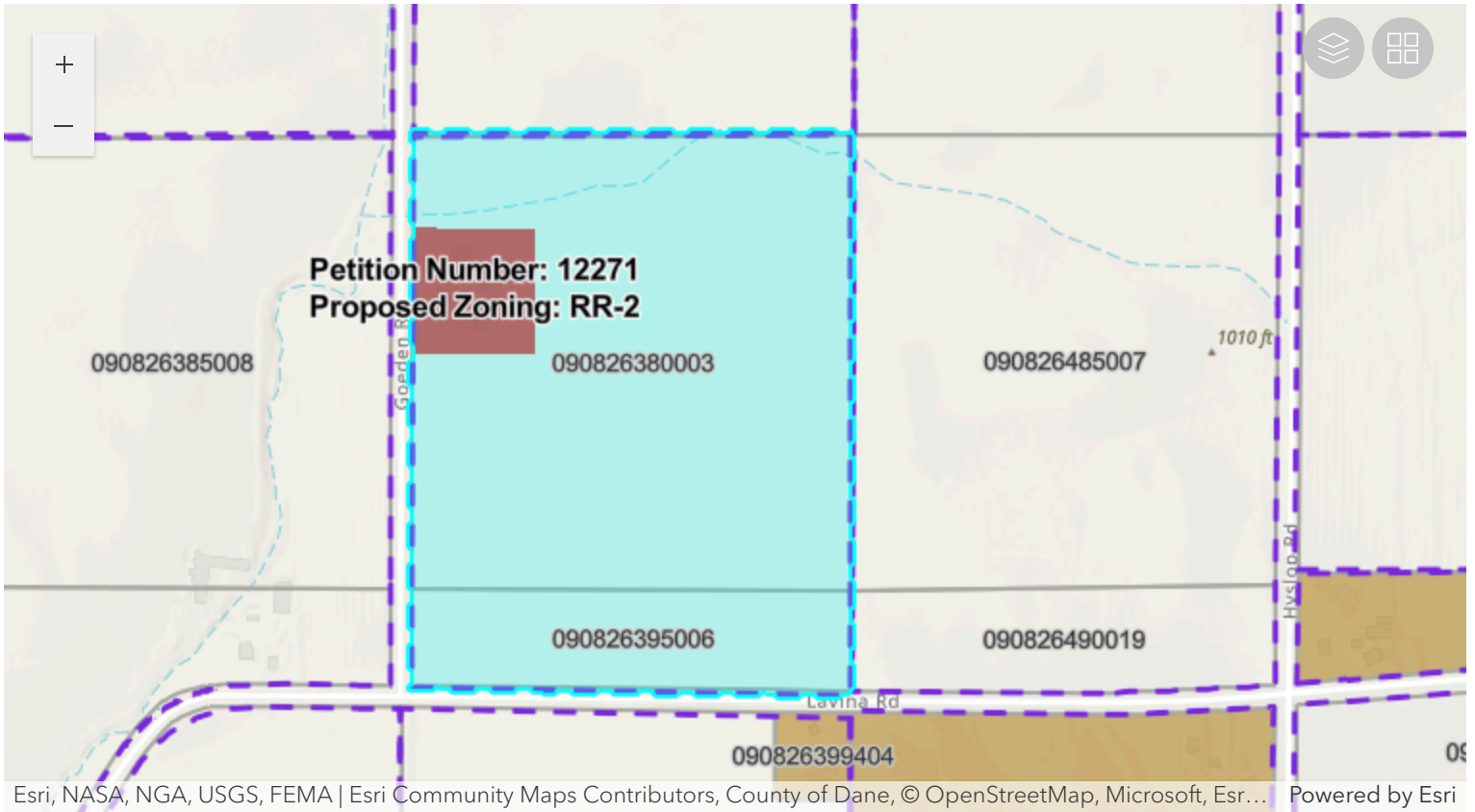

Esri, NASA, NGA, USGS, FEMA | Esri Community Maps Contributors, County of Dane, © OpenStreetMap, Microsoft, Esr... Powered by Esri

Parcel Number	Acres	Owner	CSM
090826380003	39.96	DH3 INDUSTRIES LLC	
090826395006	8.61	DH3 INDUSTRIES LLC	